

ARMSTRONG® 50 Pc. 1/4" Drive 6 Point SAE/Metric Mechanics Tool Set

- All Tools are Made in the USA - Quality and Availability
- Durable, Long Lasting Blow Molded Case Will Not Dent, Will Not Rust, Even Under the Harshest Conditions -Two Piece Latches Securely Hold the Box Closed
- Bottom Half of the Case Can Be Removed and Placed in a Tool Storage Drawer for Organization
- EYE-D™ Markings on The Sockets Optimize Size Visibility, Also Providing SAE / Metric Differentiation - Socket Sizes are Also Marked in Blow Mold
- Ratchet has a Compact Head Design, Recessed Reversing Lever With On/Off Markings, Unique Hour Glass Handle Design, as Well as The "Torque Wrap" Design Incorporating a 10 Degree Ratcheting Arc
- Sockets Incorporate A Radius Corner Design that Engages the Flats of Tthe Fastener as Well as a Unique Retention Method, Cold Form Ball Recess, Which Provides Consistent Secure Retention of the Socket to the Drive Tool
- Knurling on the Extension Shaft Provides a Non-Slip Grip to Quickly Run Down / Remove Fasteners
- All Tools are Manufactured From High Alloy Steel Using the Most Up-To-Date Manufacturing Process and Heat Treat for Greater Strength and Durability
- Meets Or Exceeds ASME B107.1-2002, B107.10M and US Federal Spec. GGG-W-641E



Cat. No.	UPC No.	Packaging	Product Weight	Shelf Pack Qty.
15-199	781412151992	Blow Mold Case	6.85 lb	1

Cat. No.	Description	Cat. No.	Description
10-992	1/4" Drive Armstrong MAXX Standard Handle Ratchet	37-083	1/4" Drive 6 Point Standard Socket 5.5mm
10-921	1/4" Drive Extension 2"	37-006	1/4" Drive 6 Point Standard Socket 6mm
10-923	1/4" Drive Extension 6"	37-007	1/4" Drive 6 Point Standard Socket 7mm
10-006D	1/4" Drive 6 Point Standard Socket 3/16"	37-008	1/4" Drive 6 Point Standard Socket 8mm
10-007D	1/4" Drive 6 Point Standard Socket 7/32"	37-009D	1/4" Drive 6 Point Standard Socket 9mm
10-008D	1/4" Drive 6 Point Standard Socket 1/4"	37-010	1/4" Drive 6 Point Standard Socket 10mm
10-009D	1/4" Drive 6 Point Standard Socket 9/32"	37-011	1/4" Drive 6 Point Standard Socket 11mm
10-010	1/4" Drive 6 Point Standard Socket 5/16"	37-012D	1/4" Drive 6 Point Standard Socket 12mm
10-011	1/4" Drive 6 Point Standard Socket 11/32"	37-013	1/4" Drive 6 Point Standard Socket 13mm
10-012	1/4" Drive 6 Point Standard Socket 3/8"	37-014D	1/4" Drive 6 Point Standard Socket 14mm
10-014	1/4" Drive 6 Point Standard Socket 7/16"	37-015	1/4" Drive 6 Point Standard Socket 15mm
10-016D	1/4" Drive 6 Point Standard Socket 1/2"	37-204	1/4" Drive 6 Point Deep Socket 4mm
10-018D	1/4" Drive 6 Point Standard Socket 9/16"	37-205	1/4" Drive 6 Point Deep Socket 5mm
10-206	1/4" Drive 6 Point Deep Socket 3/16"	37-283	1/4" Drive 6 Point Deep Socket 5.5mm
10-207	1/4" Drive 6 Point Deep Socket 7/32"	37-206	1/4" Drive 6 Point Deep Socket 6mm
10-208	1/4" Drive 6 Point Deep Socket 1/4"	37-207	1/4" Drive 6 Point Deep Socket 7mm
10-209	1/4" Drive 6 Point Deep Socket 9/32"	37-208	1/4" Drive 6 Point Deep Socket 8mm
10-210	1/4" Drive 6 Point Deep Socket 5/16"	37-209	1/4" Drive 6 Point Deep Socket 9mm
10-211	1/4" Drive 6 Point Deep Socket 11/32"	37-210	1/4" Drive 6 Point Deep Socket 10mm
10-212	1/4" Drive 6 Point Deep Socket 3/8"	37-211	1/4" Drive 6 Point Deep Socket 11mm
10-214	1/4" Drive 6 Point Deep Socket 7/16"	37-212	1/4" Drive 6 Point Deep Socket 12mm
10-216	1/4" Drive 6 Point Deep Socket 1/2"	37-213	1/4" Drive 6 Point Deep Socket 13mm
10-218	1/4" Drive 6 Point Deep Socket 9/16"	37-214	1/4" Drive 6 Point Deep Socket 14mm
37-004	1/4" Drive 6 Point Standard Socket 4mm	37-215	1/4" Drive 6 Point Deep Socket 15mm
37-005	1/4" Drive 6 Point Standard Socket 5mm	10-947	1/4" Drive Universal Joint

ARMSTRONG 37 Pc. 1/4" Drive 6 and 8 Point SAE Standard and Deep Mechanics Tool Set

- Made in the USA - Quality and Availability
- Durable, long lasting blow molded case will not dent, will not rust, even under the harshest conditions -Two piece latches securely hold the box closed.
- Foam inserts securely hold all tools in place - Black Top Foam with Blue Foam underneath for easy identification of a missing tool
- The bottom half of the case with the foam insert or the foam insert itself can be removed and placed in a tool storage drawer for organization
- EYE-D™ markings on the sockets optimize size visibility, also providing SAE / metric differentiation - Socket sizes are also cut into the foam
- Ratchet has a compact head design, recessed reversing lever with On/Off markings, Unique "Hour Glass" handle design, as well as the "Torque Wrap" design incorporating a 10 degree ratcheting arc
- Meets or Exceeds ASME B107.1-2002, B107.10M and US Federal Spec. GGG-W-641E



Cat. No.	UPC No.	Packaging	Product Weight	Shelf Pack Qty.
15-205	781412152050	Blow Mold Case	8.04 lb	1

Cat. No.	Description	Cat. No.	Description
10-972	1/4" Drive Teardrop Ratchet	10-012	1/4" Drive 6 Point Standard Socket 3/8"
10-938	1/4" Drive T-Handle 5"	10-014	1/4" Drive 6 Point Standard Socket 7/16"
10-943	1/4" Drive Plastic Handle Driver 6"	10-016D	1/4" Drive 6 Point Standard Socket 1/2"
10-821	1/4" Drive Phillips Screwdriver Socket #1	10-018D	1/4" Drive 6 Point Standard Socket 9/16"
10-822	1/4" Drive Phillips Screwdriver Socket #2	10-206	1/4" Drive 6 Point Deep Socket 3/16"
10-823	1/4" Drive Phillips Screwdriver Socket #3	10-207	1/4" Drive 6 Point Deep Socket 7/32"
10-801	1/4" Drive Scredriver Socket 3/16" x 1/32" Tip	10-208	1/4" Drive 6 Point Deep Socket 1/4"
10-802	1/4" Drive Scredriver Socket 1/4" x 1/32" Tip	10-209	1/4" Drive 6 Point Deep Socket 9/32"
10-918	1/4" Drive Breaker Bar 5-3/4"	10-210	1/4" Drive 6 Point Deep Socket 5/16"
10-921	1/4" Drive Extension 2"	10-211	1/4" Drive 6 Point Deep Socket 11/32"
10-922	1/4" Drive Extension 4"	10-212	1/4" Drive 6 Point Deep Socket 3/8"
10-923	1/4" Drive Extension 6"	10-214	1/4" Drive 6 Point Deep Socket 7/16"
10-929	1/4" Drive Flex Extension 6"	10-216	1/4" Drive 6 Point Deep Socket 1/2"
10-006D	1/4" Drive 6 Point Standard Socket 3/16"	10-218	1/4" Drive 6 Point Deep Socket 9/16"
10-007D	1/4" Drive 6 Point Standard Socket 7/32"	10-408	1/4" Drive 8 Point Standard Socket 1/4"
10-008D	1/4" Drive 6 Point Standard Socket 1/4"	10-410	1/4" Drive 8 Point Standard Socket 5/16"
10-009D	1/4" Drive 6 Point Standard Socket 9/32"	10-412	1/4" Drive 8 Point Standard Socket 3/8"
10-010	1/4" Drive 6 Point Standard Socket 5/16"	10-947	1/4" Drive Universal Joint
10-011	1/4" Drive 6 Point Standard Socket 11/32"		

1 / 4 "

3

RATCHETS / SOCKETS / DRIVE TOOLS / SETS

ARMSTRONG® 29 Pc. 1/4" Drive 6 Point Metric Standard and Deep Mechanics Tool Set

- Made in the USA - Quality and Availability
- Durable, long lasting blow molded case will not dent, will not rust, even under the harshest conditions -Two piece latches securely hold the box closed.
- Foam inserts securely hold all tools in place - Black Top Foam with Blue Foam underneath for easy identification of a missing tool
- The bottom half of the case with the foam insert or the foam insert itself can be removed and placed in a tool storage drawer for organization
- EYE-D™ markings on the sockets optimize size visibility, also providing SAE / metric differentiation - Socket sizes are also cut into the foam
- Ratchet has a compact head design, recessed reversing lever with On/Off markings, Unique "Hour Glass" handle design, as well as the "Torque Wrap" design incorporating a 10 degree ratcheting arc
- Meets or Exceeds ASME B107.5M-2002, B107.10M



Cat. No.	UPC No.	Packaging	Product Weight	Shelf Pack Qty.
44-205D	781412442052	Blow Mold Case	4.07 lb	1

Cat. No.	Description	Cat. No.	Description
10-972	1/4" Drive Teardrop Ratchet	37-014D	1/4" Drive 6 Point Standard Socket 14mm
10-943	1/4" Drive Plastic Handle Driver 6"	37-204	1/4" Drive 6 Point Deep Socket 4mm
10-921	1/4" Drive Extension 2"	37-205	1/4" Drive 6 Point Deep Socket 5mm
10-923	1/4" Drive Extension 6"	37-283	1/4" Drive 6 Point Deep Socket 5.5mm
37-004	1/4" Drive 6 Point Standard Socket 4mm	37-206	1/4" Drive 6 Point Deep Socket 6mm
37-005	1/4" Drive 6 Point Standard Socket 5mm	37-207	1/4" Drive 6 Point Deep Socket 7mm
37-083	1/4" Drive 6 Point Standard Socket 5.5mm	37-208	1/4" Drive 6 Point Deep Socket 8mm
37-006	1/4" Drive 6 Point Standard Socket 6mm	37-209	1/4" Drive 6 Point Deep Socket 9mm
37-007	1/4" Drive 6 Point Standard Socket 7mm	37-210	1/4" Drive 6 Point Deep Socket 10mm
37-008	1/4" Drive 6 Point Standard Socket 8mm	37-211	1/4" Drive 6 Point Deep Socket 11mm
37-009D	1/4" Drive 6 Point Standard Socket 9mm	37-212	1/4" Drive 6 Point Deep Socket 12mm
37-010	1/4" Drive 6 Point Standard Socket 10mm	37-213	1/4" Drive 6 Point Deep Socket 13mm
37-011	1/4" Drive 6 Point Standard Socket 11mm	37-214	1/4" Drive 6 Point Deep Socket 14mm
37-012D	1/4" Drive 6 Point Standard Socket 12mm	10-947	1/4" Drive Universal Joint
37-013	1/4" Drive 6 Point Standard Socket 13mm		

1 / 4 "

3

RATCHETS / SOCKETS / DRIVE TOOLS / SETS

ARMSTRONG® 25 Pc. 1/4" Drive 6 Point SAE Standard and Deep Mechanics Tool Set

- Made in the USA - Quality and Availability
- Durable, long lasting blow molded case will not dent, will not rust, even under the harshest conditions -Two piece latches securely hold the box closed.
- Foam inserts securely hold all tools in place - Black Top Foam with Blue Foam underneath for easy identification of a missing tool
- The bottom half of the case with the foam insert or the foam insert itself can be removed and placed in a tool storage drawer for organization
- EYE-D™ markings on the sockets optimize size visibility, also providing SAE / metric differentiation - Socket sizes are also cut into the foam
- Ratchet has a compact head design, recessed reversing lever with On/Off markings, Unique "Hour Glass" handle design, as well as the "Torque Wrap" design incorporating a 10 degree ratcheting arc
- Meets or Exceeds ASME B107.1-2002, B107.10M and US Federal Spec. GGG-W-641E



Cat. No.	UPC No.	Packaging	Product Weight	Shelf Pack Qty.
15-215	781412152159	Blow Mold Case	3.87 lb	1

Cat. No.	Description	Cat. No.	Description
10-972	1/4" Drive Teardrop Ratchet	10-018D	1/4" Drive 6 Point Standard Socket 9/16"
10-943	1/4" Drive Plastic Handle Driver 6"	10-206	1/4" Drive 6 Point Deep Socket 3/16"
10-921	1/4" Drive Extension 2"	10-207	1/4" Drive 6 Point Deep Socket 7/32"
10-923	1/4" Drive Extension 6"	10-208	1/4" Drive 6 Point Deep Socket 1/4"
10-006D	1/4" Drive 6 Point Standard Socket 3/16"	10-209	1/4" Drive 6 Point Deep Socket 9/32"
10-007D	1/4" Drive 6 Point Standard Socket 7/32"	10-210	1/4" Drive 6 Point Deep Socket 5/16"
10-008D	1/4" Drive 6 Point Standard Socket 1/4"	10-211	1/4" Drive 6 Point Deep Socket 11/32"
10-009D	1/4" Drive 6 Point Standard Socket 9/32"	10-212	1/4" Drive 6 Point Deep Socket 3/8"
10-010	1/4" Drive 6 Point Standard Socket 5/16"	10-214	1/4" Drive 6 Point Deep Socket 7/16"
10-011	1/4" Drive 6 Point Standard Socket 11/32"	10-216	1/4" Drive 6 Point Deep Socket 1/2"
10-012	1/4" Drive 6 Point Standard Socket 3/8"	10-218	1/4" Drive 6 Point Deep Socket 9/16"
10-014	1/4" Drive 6 Point Standard Socket 7/16"	10-947	1/4" Drive Universal Joint
10-016D	1/4" Drive 6 Point Standard Socket 1/2"		

1 / 4 "

3

RATCHETS / SOCKETS / DRIVE TOOLS / SETS

ARMSTRONG® 25 Pc. 1/4" Drive 12 Point SAE Standard and Deep Mechanics Tool Set

- Made in the USA - Quality and Availability
- Durable, long lasting blow molded case will not dent, will not rust, even under the harshest conditions -Two piece latches securely hold the box closed.
- Foam inserts securely hold all tools in place - Black Top Foam with Blue Foam underneath for easy identification of a missing tool
- The bottom half of the case with the foam insert or the foam insert itself can be removed and placed in a tool storage drawer for organization
- EYE-D™ markings on the sockets optimize size visibility, also providing SAE / metric differentiation - Socket sizes are also cut into the foam
- Ratchet has a compact head design, recessed reversing lever with On/Off markings, Unique "Hour Glass" handle design, as well as the "Torque Wrap" design incorporating a 10 degree ratcheting arc
- Meets or Exceeds ASME B107.1-2002, B107.10M and US Federal Spec. GGG-W-641E



Cat. No.	UPC No.	Packaging	Product Weight	Shelf Pack Qty.
15-210	781412152104	Blow Mold Case	3.96 lb	1

Cat. No.	Description	Cat. No.	Description
10-972	1/4" Drive Teardrop Ratchet	10-118D	1/4" Drive 12 Point Standard Socket 9/16"
10-943	1/4" Drive Plastic Handle Driver 6"	10-306	1/4" Drive 12 Point Deep Socket 3/16"
10-921	1/4" Drive Extension 2"	10-307	1/4" Drive 12 Point Deep Socket 7/32"
10-923	1/4" Drive Extension 6"	10-308	1/4" Drive 12 Point Deep Socket 1/4"
10-106	1/4" Drive 12 Point Standard Socket 3/16"	10-309	1/4" Drive 12 Point Deep Socket 9/32"
10-107	1/4" Drive 12 Point Standard Socket 7/32"	10-310	1/4" Drive 12 Point Deep Socket 5/16"
10-108	1/4" Drive 12 Point Standard Socket 1/4"	10-311	1/4" Drive 12 Point Deep Socket 11/32"
10-109	1/4" Drive 12 Point Standard Socket 9/32"	10-312	1/4" Drive 12 Point Deep Socket 3/8"
10-110D	1/4" Drive 12 Point Standard Socket 5/16"	10-314	1/4" Drive 12 Point Deep Socket 7/16"
10-111	1/4" Drive 12 Point Standard Socket 11/32"	10-316	1/4" Drive 12 Point Deep Socket 1/2"
10-112	1/4" Drive 12 Point Standard Socket 3/8"	10-318	1/4" Drive 12 Point Deep Socket 9/16"
10-114	1/4" Drive 12 Point Standard Socket 7/16"	10-947	1/4" Drive Universal Joint
10-116	1/4" Drive 12 Point Standard Socket 1/2"		

ARMSTRONG® 21 Pc. 1/4" Drive 6 Point SAE Standard and Deep Mechanics Tool Set

- All Tools are Made in the USA - Quality and Availability
- Hard Stamp Only, No EYE-D™ Markings



Cat. No.	UPC No.	Packaging	Product Weight	Shelf Pack Qty.
15-248A	781412152487	Metal Box	3.05 lb	1

Cat. No.	Description	Cat. No.	Description
10-967A	1/4" Drive Teardrop Quick Release Ratchet Knurled Handle 5-1/2"	10-206A	1/4" Drive 6 Point Deep Socket 3/16"
10-944	1/4" Drive Plastic Handle Driver 6" No Female Drive End	10-207A	1/4" Drive 6 Point Deep Socket 7/32"
10-919A	1/4" Drive Extension 1-1/2"	10-208A	1/4" Drive 6 Point Deep Socket 1/4"
10-923A	1/4" Drive Extension 6" No Knurling	10-209A	1/4" Drive 6 Point Deep Socket 9/32"
10-008A	1/4" Drive 6 Point Standard Socket 1/4"	10-210A	1/4" Drive 6 Point Deep Socket 5/16"
10-009A	1/4" Drive 6 Point Standard Socket 9/32"	10-211A	1/4" Drive 6 Point Deep Socket 11/32"
10-010	1/4" Drive 6 Point Standard Socket 5/16"	10-212A	1/4" Drive 6 Point Deep Socket 3/8"
10-011	1/4" Drive 6 Point Standard Socket 11/32"	10-214A	1/4" Drive 6 Point Deep Socket 7/16"
10-012A	1/4" Drive 6 Point Standard Socket 3/8"	10-216A	1/4" Drive 6 Point Deep Socket 1/2"
10-014A	1/4" Drive 6 Point Standard Socket 7/16"	10-947	1/4" Drive Universal Joint
10-016A	1/4" Drive 6 Point Standard Socket 1/2"		

1 / 4 "

ARMSTRONG® 21 Pc. 1/4" Drive 6 Point Metric Standard and Deep Mechanics Tool Set

- All Tools are Made in the USA - Quality and Availability
- Hard Stamp Only, No EYE-D™ Markings



Cat. No.	UPC No.	Packaging	Product Weight	Shelf Pack Qty.
44-321A	781412443219	Metal Box	3.03 lb	1

Cat. No.	Description	Cat. No.	Description
10-967A	1/4" Drive Teardrop Quick Release Ratchet Knurled Handle 5-1/2"	37-011A	1/4" Drive 6 Point Standard Socket 11mm
10-944	1/4" Drive Plastic Handle Driver 6" No Female Drive End	37-012A	1/4" Drive 6 Point Standard Socket 12mm
10-919A	1/4" Drive Extension 1-1/2"	37-206A	1/4" Drive 6 Point Deep Socket 6mm
10-923A	1/4" Drive Extension 6" No Knurling	37-207A	1/4" Drive 6 Point Deep Socket 7mm
37-004A	1/4" Drive 6 Point Standard Socket 4mm	37-208A	1/4" Drive 6 Point Deep Socket 8mm
37-005A	1/4" Drive 6 Point Standard Socket 5mm	37-209A	1/4" Drive 6 Point Deep Socket 9mm
37-006A	1/4" Drive 6 Point Standard Socket 6mm	37-210A	1/4" Drive 6 Point Deep Socket 10mm
37-007A	1/4" Drive 6 Point Standard Socket 7mm	37-211A	1/4" Drive 6 Point Deep Socket 11mm
37-008A	1/4" Drive 6 Point Standard Socket 8mm	37-212A	1/4" Drive 6 Point Deep Socket 12mm
37-009A	1/4" Drive 6 Point Standard Socket 9mm	10-947	1/4" Drive Universal Joint
37-010A	1/4" Drive 6 Point Standard Socket 10mm		

RATCHETS / SOCKETS / DRIVE TOOLS / SETS 3

ARMSTRONG® 19 Pc. 1/4" Drive 6 and 8 Point SAE Mechanics Tool Set

- Made in the USA - Quality and Availability
- Durable, long lasting blow molded case will not dent, will not rust, even under the harshest conditions -Two piece latches securely hold the box closed.
- Foam inserts securely hold all tools in place - Black Top Foam with Blue Foam underneath for easy identification of a missing tool
- The bottom half of the case with the foam insert or the foam insert itself can be removed and placed in a tool storage drawer for organization
- EYE-D™ markings on the sockets optimize size visibility, also providing SAE / metric differentiation - Socket sizes are also cut into the foam
- Ratchet has a compact head design, recessed reversing lever with On/Off markings, Unique "Hour Glass" handle design, as well as the "Torque Wrap" design incorporating a 10 degree ratcheting arc
- Meets or Exceeds ASME B107.1-2002, B107.10M and US Federal Spec. GGG-W-641E



Cat. No.	UPC No.	Packaging	Product Weight	Shelf Pack Qty.
15-220	781412152203	Blow Mold Case	3.62 lb	1

Cat. No.	Description	Cat. No.	Description
10-972	1/4" Drive Teardrop Ratchet	10-011	1/4" Drive 6 Point Standard Socket 11/32"
10-943	1/4" Drive Plastic Handle Driver 6"	10-012	1/4" Drive 6 Point Standard Socket 3/8"
10-918	1/4" Drive Breaker Bar 5-3/4"	10-014	1/4" Drive 6 Point Standard Socket 7/16"
10-921	1/4" Drive Extension 2"	10-016D	1/4" Drive 6 Point Standard Socket 1/2"
10-923	1/4" Drive Extension 6"	10-018D	1/4" Drive 6 Point Standard Socket 9/16"
10-006D	1/4" Drive 6 Point Standard Socket 3/16"	10-408	1/4" Drive 8 Point Standard Socket 1/4"
10-007D	1/4" Drive 6 Point Standard Socket 7/32"	10-410	1/4" Drive 8 Point Standard Socket 5/16"
10-008D	1/4" Drive 6 Point Standard Socket 1/4"	10-412	1/4" Drive 8 Point Standard Socket 3/8"
10-009D	1/4" Drive 6 Point Standard Socket 9/32"	10-947	1/4" Drive Universal Joint
10-010	1/4" Drive 6 Point Standard Socket 5/16"		

ARMSTRONG® 17 Pc. 1/4" Drive 6 Point Metric Mechanics Tool Set

- Made in the USA - Quality and Availability
- Durable, long lasting blow molded case will not dent, will not rust, even under the harshest conditions -Two piece latches securely hold the box closed.
- Foam inserts securely hold all tools in place - Black Top Foam with Blue Foam underneath for easy identification of a missing tool
- The bottom half of the case with the foam insert or the foam insert itself can be removed and placed in a tool storage drawer for organization
- EYE-D™ markings on the sockets optimize size visibility, also providing SAE / metric differentiation - Socket sizes are also cut into the foam
- Ratchet has a compact head design, recessed reversing lever with On/Off markings, Unique "Hour Glass" handle design, as well as the "Torque Wrap" design incorporating a 10 degree ratcheting arc
- Meets or Exceeds ASME B107.5M-2002, B107.10M



Cat. No.	UPC No.	Packaging	Product Weight	Shelf Pack Qty.
44-210D	781412442106	Blow Mold Case	2.28 lb	1

Cat. No.	Description	Cat. No.	Description
10-972	1/4" Drive Teardrop Ratchet	37-008	1/4" Drive 6 Point Standard Socket 8mm
10-943	1/4" Drive Plastic Handle Driver 6"	37-009D	1/4" Drive 6 Point Standard Socket 9mm
10-921	1/4" Drive Extension 2"	37-010	1/4" Drive 6 Point Standard Socket 10mm
10-923	1/4" Drive Extension 6"	37-011	1/4" Drive 6 Point Standard Socket 11mm
37-004	1/4" Drive 6 Point Standard Socket 4mm	37-012D	1/4" Drive 6 Point Standard Socket 12mm
37-005	1/4" Drive 6 Point Standard Socket 5mm	37-013	1/4" Drive 6 Point Standard Socket 13mm
37-083	1/4" Drive 6 Point Standard Socket 5.5mm	37-014D	1/4" Drive 6 Point Standard Socket 14mm
37-006	1/4" Drive 6 Point Standard Socket 6mm	10-947	1/4" Drive Universal Joint
37-007	1/4" Drive 6 Point Standard Socket 7mm		

1 / 4 "

3

RATCHETS / SOCKETS / DRIVE TOOLS / SETS

ARMSTRONG 15 Pc. 1/4" Drive 6 Point SAE Mechanics Tool Set

- Made in the USA - Quality and Availability
- Durable, long lasting blow molded case will not dent, will not rust, even under the harshest conditions -Two piece latches securely hold the box closed.
- Foam inserts securely hold all tools in place - Black Top Foam with Blue Foam underneath for easy identification of a missing tool
- The bottom half of the case with the foam insert or the foam insert itself can be removed and placed in a tool storage drawer for organization
- EYE-D™ markings on the sockets optimize size visibility, also providing SAE / metric differentiation - Socket sizes are also cut into the foam
- Ratchet has a compact head design, recessed reversing lever with On/Off markings, Unique "Hour Glass" handle design, as well as the "Torque Wrap" design incorporating a 10 degree ratcheting arc
- Meets or Exceeds ASME B107.1-2002, B107.10M and US Federal Spec. GGG-W-641E



Cat. No.	UPC No.	Packaging	Product Weight	Shelf Pack Qty.
15-225	781412152258	Blow Mold Case	2.22 lb	1

Cat. No.	Description	Cat. No.	Description
10-947	1/4" Drive Universal Joint	10-009D	1/4" Drive 6 Point Standard Socket 9/32"
10-943	1/4" Drive Plastic Handle Driver 6"	10-010	1/4" Drive 6 Point Standard Socket 5/16"
10-921	1/4" Drive Extension 2"	10-011	1/4" Drive 6 Point Standard Socket 11/32"
10-923	1/4" Drive Extension 6"	10-012	1/4" Drive 6 Point Standard Socket 3/8"
10-972	1/4" Drive Teardrop Ratchet	10-014	1/4" Drive 6 Point Standard Socket 7/16"
10-006D	1/4" Drive 6 Point Standard Socket 3/16"	10-016D	1/4" Drive 6 Point Standard Socket 1/2"
10-007D	1/4" Drive 6 Point Standard Socket 7/32"	10-018D	1/4" Drive 6 Point Standard Socket 9/16"
10-008D	1/4" Drive 6 Point Standard Socket 1/4"		

ARMSTRONG 14 Pc. 1/4" Drive 6 Point Metric Mechanics Tool Set with Round Head Ratchet

- All Tools are Made in the USA - Quality and Availability
- Hard Stamp Only, No EYE-D™ Markings



Cat. No.	UPC No.	Packaging	Product Weight	Shelf Pack Qty.
44-323A	781412443233	Metal Box	1.42 lb	1

Cat. No.	Description	Cat. No.	Description
10-944	1/4" Drive Plastic Handle Driver 6" No Female Drive End	37-007A	1/4" Drive 6 Point Standard Socket 7mm
10-919A	1/4" Drive Extension 1-1/2"	37-008A	1/4" Drive 6 Point Standard Socket 8mm
10-923A	1/4" Drive Extension 6" No Knurling	37-009A	1/4" Drive 6 Point Standard Socket 9mm
10-915A	1/4" Drive Roundhead Ratchet Knurled Handle	37-010A	1/4" Drive 6 Point Standard Socket 10mm
37-004A	1/4" Drive 6 Point Standard Socket 4mm	37-011A	1/4" Drive 6 Point Standard Socket 11mm
37-005A	1/4" Drive 6 Point Standard Socket 5mm	37-012A	1/4" Drive 6 Point Standard Socket 12mm
37-006A	1/4" Drive 6 Point Standard Socket 6mm	37-013A	1/4" Drive 6 Point Standard Socket 13mm

1 / 4 "

3

RATCHETS / SOCKETS / DRIVE TOOLS / SETS

ARMSTRONG® 13 Pc. 1/4" Drive 6 Point SAE Mechanics Tool Set with Quick Release Ratchet

- All Tools are Made in the USA - Quality and Availability
- Hard Stamp Only, No EYE-D™ Markings



Cat. No.	UPC No.	Packaging	Product Weight	Shelf Pack Qty.
15-246A	781412152463	Metal Box	1.44 lb	1

Cat. No.	Description	Cat. No.	Description
10-967A	1/4" Drive Teardrop Quick Release Ratchet Knurled Handle 5-1/2"	10-009A	1/4" Drive 6 Point Standard Socket 9/32"
10-944	1/4" Drive Plastic Handle Driver 6" No Female Drive End	10-010	1/4" Drive 6 Point Standard Socket 5/16"
10-919A	1/4" Drive Extension 1-1/2"	10-011	1/4" Drive 6 Point Standard Socket 11/32"
10-923A	1/4" Drive Extension 6" No Knurling	10-012A	1/4" Drive 6 Point Standard Socket 3/8"
10-006A	1/4" Drive 6 Point Standard Socket 3/16"	10-014A	1/4" Drive 6 Point Standard Socket 7/16"
10-007A	1/4" Drive 6 Point Standard Socket 7/32"	10-016A	1/4" Drive 6 Point Standard Socket 1/2"
10-008A	1/4" Drive 6 Point Standard Socket 1/4"		

1 / 4 "

ARMSTRONG® 13 Pc. 1/4" Drive 6 Point SAE Mechanics Tool Set with Round Head Ratchet

- All Tools are Made in the USA - Quality and Availability
- Hard Stamp Only, No EYE-D™ Markings



Cat. No.	UPC No.	Packaging	Product Weight	Shelf Pack Qty.
15-247A	781412152470	Metal Box	1.42 lb	1

Cat. No.	Description	Cat. No.	Description
10-923A	1/4" Drive Extension 6" No Knurling	10-009A	1/4" Drive 6 Point Standard Socket 9/32"
10-944	1/4" Drive Plastic Handle Driver 6" No Female Drive End	10-010	1/4" Drive 6 Point Standard Socket 5/16"
10-919A	1/4" Drive Extension 1-1/2"	10-011	1/4" Drive 6 Point Standard Socket 11/32"
10-915A	1/4" Drive Roundhead Ratchet Knurled Handle	10-012A	1/4" Drive 6 Point Standard Socket 3/8"
10-006A	1/4" Drive 6 Point Standard Socket 3/16"	10-014A	1/4" Drive 6 Point Standard Socket 7/16"
10-007A	1/4" Drive 6 Point Standard Socket 7/32"	10-016A	1/4" Drive 6 Point Standard Socket 1/2"
10-008A	1/4" Drive 6 Point Standard Socket 1/4"		

RATCHETS / SOCKETS / DRIVE TOOLS / SETS

ARMSTRONG 12 Pc. 1/4" Drive 6 Point SAE Mechanics Tool Set

- Made in the USA - Quality and Availability
- Durable, long lasting blow molded case will not dent, will not rust, even under the harshest conditions -Two piece latches securely hold the box closed.
- Foam inserts securely hold all tools in place - Black Top Foam with Blue Foam underneath for easy identification of a missing tool
- The bottom half of the case with the foam insert or the foam insert itself can be removed and placed in a tool storage drawer for organization
- EYE-D™ markings on the sockets optimize size visibility, also providing SAE / metric differentiation - Socket sizes are also cut into the foam
- Ratchet has a compact head design, recessed reversing lever with On/Off markings, Unique "Hour Glass" handle design, as well as the "Torque Wrap" design incorporating a 10 degree ratcheting arc
- Meets or Exceeds ASME B107.1-2002, B107.10M and US Federal Spec. GGG-W-641E



Cat. No.	UPC No.	Packaging	Product Weight	Shelf Pack Qty.
15-235	781412152357	Blow Mold Case	1.83 lb	1

Cat. No.	Description	Cat. No.	Description
10-972	1/4" Drive Teardrop Ratchet	10-010	1/4" Drive 6 Point Standard Socket 5/16"
10-943	1/4" Drive Plastic Handle Driver 6"	10-011	1/4" Drive 6 Point Standard Socket 11/32"
10-006D	1/4" Drive 6 Point Standard Socket 3/16"	10-012	1/4" Drive 6 Point Standard Socket 3/8"
10-007D	1/4" Drive 6 Point Standard Socket 7/32"	10-014	1/4" Drive 6 Point Standard Socket 7/16"
10-008D	1/4" Drive 6 Point Standard Socket 1/4"	10-016D	1/4" Drive 6 Point Standard Socket 1/2"
10-009D	1/4" Drive 6 Point Standard Socket 9/32"	10-018D	1/4" Drive 6 Point Standard Socket 9/16"

1 / 4 "

3

RATCHETS / SOCKETS / DRIVE TOOLS / SETS

ARMSTRONG 12 Pc. 1/4" Drive 12 Point SAE Mechanics Tool Set

- Made in the USA - Quality and Availability
- Durable, long lasting blow molded case will not dent, will not rust, even under the harshest conditions -Two piece latches securely hold the box closed.
- Foam inserts securely hold all tools in place - Black Top Foam with Blue Foam underneath for easy identification of a missing tool
- The bottom half of the case with the foam insert or the foam insert itself can be removed and placed in a tool storage drawer for organization
- EYE-D™ markings on the sockets optimize size visibility, also providing SAE / metric differentiation - Socket sizes are also cut into the foam
- Ratchet has a compact head design, recessed reversing lever with On/Off markings, Unique "Hour Glass" handle design, as well as the "Torque Wrap" design incorporating a 10 degree ratcheting arc
- Meets or Exceeds ASME B107.1-2002, B107.10M and US Federal Spec. GGG-W-641E



Cat. No.	UPC No.	Packaging	Product Weight	Shelf Pack Qty.
15-230	781412152302	Blow Mold Case	1.84 lb	1

Cat. No.	Description	Cat. No.	Description
10-972	1/4" Drive Teardrop Ratchet	10-110D	1/4" Drive 12 Point Standard Socket 5/16"
10-943	1/4" Drive Plastic Handle Driver 6"	10-111	1/4" Drive 12 Point Standard Socket 11/32"
10-106	1/4" Drive 12 Point Standard Socket 3/16"	10-112	1/4" Drive 12 Point Standard Socket 3/8"
10-107	1/4" Drive 12 Point Standard Socket 7/32"	10-114	1/4" Drive 12 Point Standard Socket 7/16"
10-108	1/4" Drive 12 Point Standard Socket 1/4"	10-116	1/4" Drive 12 Point Standard Socket 1/2"
10-109	1/4" Drive 12 Point Standard Socket 9/32"	10-118D	1/4" Drive 12 Point Standard Socket 9/16"

1 / 4 "

3

ARMSTRONG 10 Pc. 1/4" Drive 6 Point SAE Socket Set

- Made in the USA - Quality and Availability
- Radius Corner Design Engages the Flats of the Fastener, Not the Corners, Providing Up to 15% -20% More Torque While Reducing Fastener Rounding, Enhancing the Turning of Worn Fasteners
- EYE-D™ Markings Optimize Size Visibility, Also Providing SAE / Metric Differentiation
- Unique Socket Retention Method, Cold Form Ball Recess, Provides Consistent Secure Retention of the Socket to the Drive Tool Eliminating the Possibility of Either a Loose Fit or Tight Fit
- Socket Wall Dimensions are Optimized to Provide Strength While Retaining Access to Restricted Fasteners
- Meets or Exceeds ASME B107.1-2002 and US Federal Spec. GGG-W-641E



Cat. No.	UPC No.	Packaging	Drive Type	Product Weight	Shelf Pack Qty.
15-245	781412152456	Boxed	6 Point	0.66 lb	1

Cat. No.	Description	Cat. No.	Description
16-831	9" Socket Rail Steel	10-010	1/4" Drive 6 Point Standard Socket 5/16"
16-841	1/4" Drive Socket Clips Steel	10-011	1/4" Drive 6 Point Standard Socket 11/32"
10-006D	1/4" Drive 6 Point Standard Socket 3/16"	10-012	1/4" Drive 6 Point Standard Socket 3/8"
10-007D	1/4" Drive 6 Point Standard Socket 7/32"	10-014	1/4" Drive 6 Point Standard Socket 7/16"
10-008D	1/4" Drive 6 Point Standard Socket 1/4"	10-016D	1/4" Drive 6 Point Standard Socket 1/2"
10-009D	1/4" Drive 6 Point Standard Socket 9/32"	10-018D	1/4" Drive 6 Point Standard Socket 9/16"

RATCHETS / SOCKETS / DRIVE TOOLS / SETS

ARMSTRONG® 10 Pc. 1/4" Drive 6 Point SAE A Series Socket Set

- Made in the USA - Quality and Availability
- Meets or Exceeds ASME B107.1-2002 and US Federal Spec. GGG-W-641E
- Hard Stamp Only, No EYE-D™ Markings



Cat. No.	UPC No.	Packaging	Drive Type	Product Weight	Shelf Pack Qty.
15-249A	781412152494	Boxed	6 Point	0.50 lb	1

Cat. No.	Description	Cat. No.	Description
10-005A	1/4" Drive 6 Point Standard Socket 5/32"	10-010AD	1/4" Drive 6 Point Standard Socket 5/16"
10-006A	1/4" Drive 6 Point Standard Socket 3/16"	10-011AD	1/4" Drive 6 Point Standard Socket 11/32"
10-007A	1/4" Drive 6 Point Standard Socket 7/32"	10-012A	1/4" Drive 6 Point Standard Socket 3/8"
10-008A	1/4" Drive 6 Point Standard Socket 1/4"	10-014A	1/4" Drive 6 Point Standard Socket 7/16"
10-009A	1/4" Drive 6 Point Standard Socket 9/32"	10-016A	1/4" Drive 6 Point Standard Socket 1/2"

ARMSTRONG® 10 Pc. 1/4" Drive 12 Point SAE Socket Set

- Made in the USA - Quality and Availability
- Radius Corner Design Engages the Flats of the Fastener, Not the Corners, Providing Up to 15% -20% More Torque While Reducing Fastener Rounding, Enhancing the Turning of Worn Fasteners
- EYE-D™ Markings Optimize Size Visibility, Also Providing SAE / Metric Differentiation
- Unique Socket Retention Method, Cold Form Ball Recess, Provides Consistent Secure Retention of the Socket to the Drive Tool Eliminating the Possibility of Either a Loose Fit or Tight Fit
- Socket Wall Dimensions are Optimized to Provide Strength While Retaining Access to Restricted Fasteners
- Meets or Exceeds ASME B107.1-2002 and US Federal Spec. GGG-W-641E



Cat. No.	UPC No.	Packaging	Drive Type	Product Weight	Shelf Pack Qty.
15-240	781412152401	Boxed	12 Point	0.53 lb	1

Cat. No.	Description	Cat. No.	Description
16-831	9" Socket Rail Steel	10-110D	1/4" Drive 12 Point Standard Socket 5/16"
16-841	1/4" Drive Socket Clips Steel	10-111	1/4" Drive 12 Point Standard Socket 11/32"
10-106	1/4" Drive 12 Point Standard Socket 3/16"	10-112	1/4" Drive 12 Point Standard Socket 3/8"
10-107	1/4" Drive 12 Point Standard Socket 7/32"	10-114	1/4" Drive 12 Point Standard Socket 7/16"
10-108	1/4" Drive 12 Point Standard Socket 1/4"	10-116	1/4" Drive 12 Point Standard Socket 1/2"
10-109	1/4" Drive 12 Point Standard Socket 9/32"	10-118D	1/4" Drive 12 Point Standard Socket 9/16"

ARMSTRONG® 12 Pc. 1/4" Drive 6 Point Metric Socket Set

- Made in the USA - Quality and Availability
- Radius Corner Design Engages the Flats of the Fastener, Not the Corners, Providing Up to 15% -20% More Torque While Reducing Fastener Rounding, Enhancing the Turning of Worn Fasteners
- EYE-D™ Markings Optimize Size Visibility, Also Providing SAE / Metric Differentiation
- Unique Socket Retention Method, Cold Form Ball Recess, Provides Consistent Secure Retention of the Socket to the Drive Tool Eliminating the Possibility of Either a Loose Fit or Tight Fit
- Socket Wall Dimensions are Optimized to Provide Strength While Retaining Access to Restricted Fasteners
- Meets or Exceeds ASME B107.5M-2002



Cat. No.	UPC No.	Packaging	Drive Type	Product Weight	Shelf Pack Qty.
44-215D	781412442151	Boxed	6 Point	2.70 lb	1

Cat. No.	Description	Cat. No.	Description
16-831	9" Socket Rail Steel	37-008	1/4" Drive 6 Point Standard Socket 8mm
16-841	1/4" Drive Socket Clips Steel	37-009D	1/4" Drive 6 Point Standard Socket 9mm
37-004	1/4" Drive 6 Point Standard Socket 4mm	37-010	1/4" Drive 6 Point Standard Socket 10mm
37-005	1/4" Drive 6 Point Standard Socket 5mm	37-011	1/4" Drive 6 Point Standard Socket 11mm
37-083	1/4" Drive 6 Point Standard Socket 5.5mm	37-012D	1/4" Drive 6 Point Standard Socket 12mm
37-006	1/4" Drive 6 Point Standard Socket 6mm	37-013	1/4" Drive 6 Point Standard Socket 13mm
37-007	1/4" Drive 6 Point Standard Socket 7mm	37-014D	1/4" Drive 6 Point Standard Socket 14mm

1 / 4 "

ARMSTRONG® 10 Pc. 1/4" Drive 6 Point Metric A Series Socket Set

- Made in the USA - Quality and Availability
- Meets or Exceeds ASME B107.5M-2002
- Hard Stamp Only, No EYE-D™ Markings



Cat. No.	UPC No.	Packaging	Drive Type	Product Weight	Shelf Pack Qty.
44-322A	781412443226	Boxed	6 Point	5.90 lb	1

Cat. No.	Description	Cat. No.	Description
37-004A	1/4" Drive 6 Point Standard Socket 4mm	37-009A	1/4" Drive 6 Point Standard Socket 9mm
37-005A	1/4" Drive 6 Point Standard Socket 5mm	37-010A	1/4" Drive 6 Point Standard Socket 10mm
37-006A	1/4" Drive 6 Point Standard Socket 6mm	37-011A	1/4" Drive 6 Point Standard Socket 11mm
37-007A	1/4" Drive 6 Point Standard Socket 7mm	37-012A	1/4" Drive 6 Point Standard Socket 12mm
37-008A	1/4" Drive 6 Point Standard Socket 8mm	37-013A	1/4" Drive 6 Point Standard Socket 13mm

RATCHETS / SOCKETS / DRIVE TOOLS / SETS

ARMSTRONG® 10 Pc. 1/4" Drive 6 Point SAE Deep Socket Set

- Made in the USA - Quality and Availability
- Radius Corner Design Engages the Flats of the Fastener, Not the Corners, Providing Up to 15% -20% More Torque While Reducing Fastener Rounding, Enhancing the Turning of Worn Fasteners
- EYE-D™ Markings Optimize Size Visibility, Also Providing SAE / Metric Differentiation
- Unique Socket Retention Method, Cold Form Ball Recess, Provides Consistent Secure Retention of the Socket to the Drive Tool Eliminating the Possibility of Either a Loose Fit or Tight Fit
- Socket Wall Dimensions are Optimized to Provide Strength While Retaining Access to Restricted Fasteners
- Meets or Exceeds ASME B107.1-2002 and US Federal Spec. GGG-W-641E



Cat. No.	UPC No.	Packaging	Drive Type	Product Weight	Shelf Pack Qty.
15-255	781412152555	Boxed	6 Point	1.04 lb	1

Cat. No.	Description	Cat. No.	Description
16-831	9" Socket Rail Steel	10-210	1/4" Drive 6 Point Deep Socket 5/16"
16-841	1/4" Drive Socket Clips Steel	10-211	1/4" Drive 6 Point Deep Socket 11/32"
10-206	1/4" Drive 6 Point Deep Socket 3/16"	10-212	1/4" Drive 6 Point Deep Socket 3/8"
10-207	1/4" Drive 6 Point Deep Socket 7/32"	10-214	1/4" Drive 6 Point Deep Socket 7/16"
10-208	1/4" Drive 6 Point Deep Socket 1/4"	10-216	1/4" Drive 6 Point Deep Socket 1/2"
10-209	1/4" Drive 6 Point Deep Socket 9/32"	10-218	1/4" Drive 6 Point Deep Socket 9/16"

ARMSTRONG® 10 Pc. 1/4" Drive 12 Point SAE Deep Socket Set

- Made in the USA - Quality and Availability
- Radius Corner Design Engages the Flats of the Fastener, Not the Corners, Providing Up to 15% -20% More Torque While Reducing Fastener Rounding, Enhancing the Turning of Worn Fasteners
- EYE-D™ Markings Optimize Size Visibility, Also Providing SAE / Metric Differentiation
- Unique Socket Retention Method, Cold Form Ball Recess, Provides Consistent Secure Retention of the Socket to the Drive Tool Eliminating the Possibility of Either a Loose Fit or Tight Fit
- Socket Wall Dimensions are Optimized to Provide Strength While Retaining Access to Restricted Fasteners
- Meets or Exceeds ASME B107.1-2002 and US Federal Spec. GGG-W-641E



Cat. No.	UPC No.	Packaging	Drive Type	Product Weight	Shelf Pack Qty.
15-250	781412152500	Boxed	12 Point	0.87 lb	1

Cat. No.	Description	Cat. No.	Description
16-831	9" Socket Rail Steel	10-310	1/4" Drive 12 Point Deep Socket 5/16"
16-841	1/4" Drive Socket Clips Steel	10-311	1/4" Drive 12 Point Deep Socket 11/32"
10-306	1/4" Drive 12 Point Deep Socket 3/16"	10-312	1/4" Drive 12 Point Deep Socket 3/8"
10-307	1/4" Drive 12 Point Deep Socket 7/32"	10-314	1/4" Drive 12 Point Deep Socket 7/16"
10-308	1/4" Drive 12 Point Deep Socket 1/4"	10-316	1/4" Drive 12 Point Deep Socket 1/2"
10-309	1/4" Drive 12 Point Deep Socket 9/32"	10-318	1/4" Drive 12 Point Deep Socket 9/16"

ARMSTRONG® 12 Pc. 1/4" Drive 6 Point Metric Deep Socket Set

- Made in the USA - Quality and Availability
- Radius Corner Design Engages the Flats of the Fastener, Not the Corners, Providing Up to 15% -20% More Torque While Reducing Fastener Rounding, Enhancing the Turning of Worn Fasteners
- EYE-D™ Markings Optimize Size Visibility, Also Providing SAE / Metric Differentiation
- Unique Socket Retention Method, Cold Form Ball Recess, Provides Consistent Secure Retention of the Socket to the Drive Tool Eliminating the Possibility of Either a Loose Fit or Tight Fit
- Socket Wall Dimensions are Optimized to Provide Strength While Retaining Access to Restricted Fasteners
- Meets or Exceeds ASME B107.5M-2002



Cat. No.	UPC No.	Packaging	Drive Type	Product Weight	Shelf Pack Qty.
44-220D	781412442205	Boxed	6 Point	2.75 lb	1

Cat. No.	Description	Cat. No.	Description
16-831	9" Socket Rail Steel	37-208	1/4" Drive 6 Point Deep Socket 8mm
16-841	1/4" Drive Socket Clips Steel	37-209	1/4" Drive 6 Point Deep Socket 9mm
37-204	1/4" Drive 6 Point Deep Socket 4mm	37-210	1/4" Drive 6 Point Deep Socket 10mm
37-205	1/4" Drive 6 Point Deep Socket 5mm	37-211	1/4" Drive 6 Point Deep Socket 11mm
37-283	1/4" Drive 6 Point Deep Socket 5.5mm	37-212	1/4" Drive 6 Point Deep Socket 12mm
37-206	1/4" Drive 6 Point Deep Socket 6mm	37-213	1/4" Drive 6 Point Deep Socket 13mm
37-207	1/4" Drive 6 Point Deep Socket 7mm	37-214	1/4" Drive 6 Point Deep Socket 14mm

ARMSTRONG® 11 Pc. 1/4" Drive SAE Hex Bit Socket Set

- Made in the USA - Quality and Availability
- Bits are Manufactured to the Highest Tolerances and Specifications for Straightness, Concentricity, and Precise Tip Fit to the Fastener
- Bits are Manufactured From High Alloy Steel Using the Most Up-To-Date Manufacturing Process and Heat Treat to Prevent Shattering and Premature Bit Wear
- Bits are Retained in the Bit Holder By a Set Screw That Locks Securely Into a Groove on the Bit for Positive Bit Retention As Well As Simple, Easy Bit Replacement
- Broached Hex in the Bit Holder Allows Higher Torque Loads



Cat. No.	UPC No.	Packaging	Product Weight	Shelf Pack Qty.
15-265	781412152654	Boxed	0.90 lb	1

Cat. No.	Description	Cat. No.	Description
16-831	9" Socket Rail Steel	10-709	1/4" Drive Standard Length Hex Driver Socket 9/64" Bit
16-841	1/4" Drive Socket Clips Steel	10-710	1/4" Drive Standard Length Hex Driver Socket 5/32" Bit
10-704	1/4" Drive Standard Length Hex Driver Socket 1/16" Bit	10-711	1/4" Drive Standard Length Hex Driver Socket 3/16" Bit
10-705	1/4" Drive Standard Length Hex Driver Socket 5/64" Bit	10-712	1/4" Drive Standard Length Hex Driver Socket 7/32" Bit
10-706	1/4" Drive Standard Length Hex Driver Socket 3/32" Bit	10-713	1/4" Drive Standard Length Hex Driver Socket 1/4" Bit
10-707	1/4" Drive Standard Length Hex Driver Socket 7/64" Bit	10-714	1/4" Drive Standard Length Hex Driver Socket 5/16" Bit
10-708	1/4" Drive Standard Length Hex Driver Socket 1/8" Bit		

ARMSTRONG 6 Pc. 1/4" Drive Metric Hex Bit Socket Set

- Made in the USA - Quality and Availability
- Bits are Manufactured to the Highest Tolerances and Specifications for Straightness, Concentricity, and Precise Tip Fit to the Fastener
- Bits are Manufactured From High Alloy Steel Using the Most Up-To-Date Manufacturing Process and Heat Treat to Prevent Shattering and Premature Bit Wear
- Bits are Retained in the Bit Holder By a Set Screw That Locks Securely Into a Groove on the Bit for Positive Bit Retention As Well As Simple, Easy Bit Replacement
- Broached Hex in the Bit Holder Allows Higher Torque Loads



Cat. No.	UPC No.	Packaging	Product Weight	Shelf Pack Qty.
44-225	781412442250	Boxed	2.70 lb	1

Cat. No.	Description	Cat. No.	Description
16-831	9" Socket Rail Steel	37-705	1/4" Drive Standard Length Hex Driver Socket 3mm Bit
16-841	1/4" Drive Socket Clips Steel	37-707	1/4" Drive Standard Length Hex Driver Socket 4mm Bit
37-703	1/4" Drive Standard Length Hex Driver Socket 2mm Bit	37-709	1/4" Drive Standard Length Hex Driver Socket 5mm Bit
37-704	1/4" Drive Standard Length Hex Driver Socket 2.5mm Bit	37-711	1/4" Drive Standard Length Hex Driver Socket 6mm Bit

ARMSTRONG 10 Pc. 1/4" Drive SAE Extra Long Hex Bit Socket Set

- Made in the USA - Quality and Availability
- Bits are Manufactured to the Highest Tolerances and Specifications for Straightness, Concentricity, and Precise Tip Fit to the Fastener
- Bits are Manufactured From High Alloy Steel Using the Most Up-To-Date Manufacturing Process and Heat Treat to Prevent Shattering and Premature Bit Wear
- Bits are Retained in the Bit Holder By a Set Screw That Locks Securely Into a Groove on the Bit for Positive Bit Retention As Well As Simple, Easy Bit Replacement
- Broached Hex in the Bit Holder Allows Higher Torque Loads

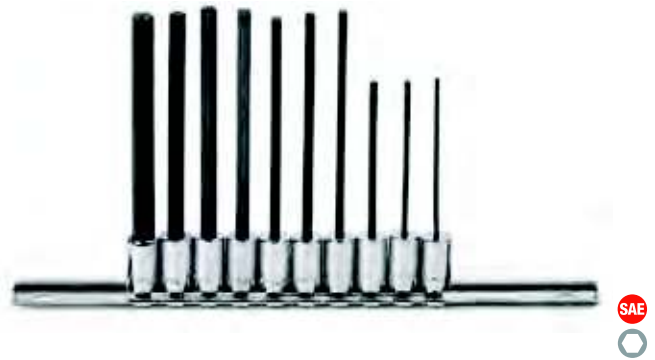

Cat. No.	UPC No.	Packaging	Product Weight	Shelf Pack Qty.
15-260	781412152609	Boxed	1.10 lb	1

Cat. No.	Description	Cat. No.	Description
16-831	9" Socket Rail Steel	10-749	1/4" Drive Extra Long Hex Driver Socket 9/64" Bit
16-841	1/4" Drive Socket Clips Steel	10-750	1/4" Drive Extra Long Hex Driver Socket 5/32" Bit
10-745	1/4" Drive Extra Long Hex Driver Socket 5/64" Bit	10-751	1/4" Drive Extra Long Hex Driver Socket 3/16" Bit
10-746	1/4" Drive Extra Long Hex Driver Socket 3/32" Bit	10-752	1/4" Drive Extra Long Hex Driver Socket 7/32" Bit
10-747	1/4" Drive Extra Long Hex Driver Socket 7/64" Bit	10-753	1/4" Drive Extra Long Hex Driver Socket 1/4" Bit
10-748	1/4" Drive Extra Long Hex Driver Socket 1/8" Bit	10-754	1/4" Drive Extra Long Hex Driver Socket 5/16" Bit

1 / 4 " 3 RATCHETS / SOCKETS / DRIVE TOOLS / SETS

ARMSTRONG® 6 Pc. 1/4" Drive Torx® Bit Socket Set

- Made in the USA - Quality and Availability
- Bits are Manufactured to the Highest Tolerances and Specifications for Straightness, Concentricity, and Precise Tip Fit to the Fastener
- Bits are Manufactured From High Alloy Steel Using the Most Up-To-Date Manufacturing Process and Heat Treat to Prevent Shattering and Premature Bit Wear
- Bits are Retained in the Bit Holder By a Set Screw That Locks Securely Into a Groove on the Bit for Positive Bit Retention As Well As Simple, Easy Bit Replacement
- Broached Hex in the Bit Holder Allows Higher Torque Loads



Cat. No.	UPC No.	Packaging	Product Weight	Shelf Pack Qty.
15-270	781412152708	Boxed	2.75 lb	1

Cat. No.	Description	Cat. No.	Description
16-831	9" Socket Rail Steel	10-874	1/4" Drive Standard Length Torx Driver Socket T20
16-841	1/4" Drive Socket Clips Steel	10-876	1/4" Drive Standard Length Torx Driver Socket T25
10-870	1/4" Drive Standard Length Torx Driver Socket T10	10-878	1/4" Drive Standard Length Torx Driver Socket T27
10-872	1/4" Drive Standard Length Torx Driver Socket T15	10-880	1/4" Drive Standard Length Torx Driver Socket T30

ARMSTRONG® 1/4" Drive Teardrop Ratchet

- Made in the USA - Quality and Availability
- Compact Head Design Permits Use in Confined areas.
- Torque Wrap Design Reduces Stress on Gear and Pawl Teeth for Greater Strength and Durability
- Unique "Hour Glass" Handle Design Has a Concave Shape Conforming to the Grip of the Hand Which Reduces Fatigue and Improved Comfort
- Manufactured From High Alloy Steel Using the Most Up-To-Date Manufacturing Process and Heat Treat for Greater Strength and Durability
- Meets or Exceeds ASME B107.10M and US Federal Spec. GGG-W-641E



Cat. No.	UPC No.	Packaging	Overall Length	Head Width	Head Thickness	Tooth Count	Repair Kit	Product Weight	Shelf Pack Qty.
10-972	781412109726	Bagged	5.281 in	0.875 in	0.969 in	36	10-990	0.27 lb	1

ARMSTRONG® 1/4" Drive Black Oxide Teardrop Ratchet

- Made in the USA - Quality and Availability
- Compact Head Design Permits Use in Confined areas.
- Torque Wrap Design Reduces Stress on Gear and Pawl Teeth for Greater Strength and Durability
- Unique "Hour Glass" Handle Design Has a Concave Shape Conforming to the Grip of the Hand Which Reduces Fatigue and Improved Comfort
- Manufactured From High Alloy Steel Using the Most Up-To-Date Manufacturing Process and Heat Treat for Greater Strength and Durability
- Meets or Exceeds ASME B107.10M and US Federal Spec. GGG-W-641E



Cat. No.	UPC No.	Packaging	Overall Length	Head Width	Head Thickness	Tooth Count	Repair Kit	Product Weight	Shelf Pack Qty.
18-972	781412189728	Bagged	5.281 in	0.875 in	0.969 in	36	10-990	0.27 lb	1

ARMSTRONG® 1/4" Drive Maxx Standard Handle Ratchet

- Made in the USA - Quality and Availability
- Unique Enclosed Head (No Screws) with Two O-Rings Resists Contaminants for Extreme Strength and Long Life.
- Sleek Tapered Head with a Low Profile Design Permits Access in Extremely Confined areas.
- Torque Wrap Design Reduces Stress on Gear and Pawl Teeth for Greater Strength and Durability
- Improved Modified "Hour Glass" Handle Design Conforms to the Shape of the Hand for Maximum Comfort and Minimal Fatigue.
- Meets or Exceeds Aerospace Standards AS4283A-2004, ASME B107.10M and US Federal Spec. GGG-W-641E



Cat. No.	UPC No.	Packaging	Overall Length	Head Width	Head Thickness	Tooth Count	Product Weight	Shelf Pack Qty.
10-992	781412109924	Bagged	5.475 in	0.950 in	0.362 in	88	0.23 lb	1

ARMSTRONG® 1/4" Drive Maxx Locking Flex Ratchet

- Made in the USA - Quality and Availability
- 9-Position Locking Flex Head Maximizes Safety and Maintains Position Regardless of Load
- Sleek Tapered Head with a Low Profile Design Permits Access in Extremely Confined areas.
- Torque Wrap Design Reduces Stress on Gear and Pawl Teeth for Greater Strength and Durability
- Improved Modified "Hour Glass" Handle Design Conforms to the Shape of the Hand for Maximum Comfort and Minimal Fatigue.
- Meets or Exceeds Aerospace Standards AS4283A-2004, ASME B107.10M and US Federal Spec. GGG-W-641E



Cat. No.	UPC No.	Packaging	Overall Length	Head Width	Head Thickness	Tooth Count	Repair Kit	Product Weight	Shelf Pack Qty.
10-994	781412109948	Bagged	6.250 in	0.875 in	0.362 in	60	10-982	0.33 lb	1

ARMSTRONG® 1/4" Drive Quick Release Ratchet

- Made in the USA - Quality and Availability
- Meets or Exceeds ASME B107.10M and US Federal Spec. GGG-W-641E



Cat. No.	UPC No.	Packaging	Overall Length	Head Width	Head Thickness	Tooth Count	Product Weight	Shelf Pack Qty.
10-967A	781412109672	Bagged	5.500 in	1.000 in	0.460 in	36	0.28 lb	1

ARMSTRONG® 1/4" Drive Ratchet

- Made in the USA - Quality and Availability
- Meets or Exceeds ASME B107.10M and US Federal Spec. GGG-W-641E



Cat. No.	UPC No.	Packaging	Overall Length	Head Width	Head Thickness	Tooth Count	Product Weight	Shelf Pack Qty.
10-968A	781412109689	Bagged	5.500 in	1.000 in	0.460 in	36	0.29 lb	1

ARMSTRONG® 1/4" Drive Round Head Ratchet

- Made in the USA - Quality and Availability
- Unique "Hour Glass" Handle Design Has a Concave Shape Conforming to the Grip of the Hand Which Reduces Fatigue and Improved Comfort
- Manufactured From High Alloy Steel Using the Most Up-To-Date Manufacturing Process and Heat Treat for Greater Strength and Durability



Cat. No.	UPC No.	Packaging	Overall Length	Head Width	Head Thickness	Tooth Count	Repair Kit	Product Weight	Shelf Pack Qty.
10-915	781412109153	Bagged	5.100 in	1.000 in	0.720 in	35	10-963	3.40 lb	1

ARMSTRONG® 1/4" Drive Round Head Ratchet

- Made in the USA - Quality and Availability



Cat. No.	UPC No.	Packaging	Overall Length	Head Width	Head Thickness	Tooth Count	Product Weight	Shelf Pack Qty.
10-915A	781412109511	Bagged	5.000 in	1.100 in	0.700 in	45	0.28 lb	1

ARMSTRONG® 1/4" Drive Indexible Head Ratchet

- Made in the USA - Quality and Availability
- 11-Position Locking Indexible Head Maximizes Safety and Maintains Position for Multi-Angle, Multi-Application Use Regardless of Load
- Strip Proof Locking Mechanism Engages with 18 Pins for Strength
- Locking Mechanism is Easy to Operate – Push Button, Set and Release
- Unique "Hour Glass" Handle Design Has a Concave Shape Conforming to the Grip of the Hand Which Reduces Fatigue and Improved Comfort
- Manufactured From High Alloy Steel Using the Most Up-To-Date Manufacturing Process and Heat Treat for Greater Strength and Durability



Cat. No.	UPC No.	Packaging	Overall Length	Head Width	Head Thickness	Tooth Count	Repair Kit	Product Weight	Shelf Pack Qty.
10-996	781412109962	Bagged	6.000 in	0.750 in	0.688 in	72	10-983	0.23 lb	1

ARMSTRONG® 1/4" Drive Ratchet Repair Kit

- Made in the USA - Quality and Availability



Cat. No.	UPC No.	Packaging	Description	Fits Product Number	Tooth Count	Product Weight	Shelf Pack Qty.
10-963	781412109634	Bagged	1/4" Drive Ratchet Repair Kit	10-915	35	0.07 lb	1
10-982	781412109825	Bagged	1/4" Drive Armstrong MAXX Ratchet Repair Kit	10-992, 10-994	60	0.10 lb	1
10-983	781412109832	Bagged	1/4" Drive Indexible Ratchet Repair Kit	10-996	72	0.04 lb	1
10-990	781412109900	Bagged	1/4" Drive Ratchet Repair Kit	10-972, 18-972	36	0.07 lb	1

1 / 4 "

3

RATCHETS / SOCKETS / DRIVE TOOLS / SETS

ARMSTRONG 1/4" Drive Socket Spinner

- Made in the USA - Quality and Availability
- Manufactured From High Alloy Steel Using the Most Up-To-Date Manufacturing Process and Heat Treat for Greater Strength and Durability



Cat. No.	UPC No.	Packaging	Length	Product Weight	Shelf Pack Qty.
10-945	781412109450	Bagged	1.500 in	0.18 lb	1

ARMSTRONG 1/4" Drive Plastic Handle Driver

- Made in the USA - Quality and Availability
- Manufactured From High Alloy Steel Using the Most Up-To-Date Manufacturing Process and Heat Treat for Greater Strength and Durability
- Meets or Exceeds ASME B107.10M and US Federal Spec. GGG-W-641E
- 10-943 has 1/4" Female Drive in Handle for Driving with Ratchet



Cat. No.	UPC No.	Packaging	Length	Female Drive Size	Product Weight	Shelf Pack Qty.
10-943	781412109436	Bagged	6.00 in	1/4"	0.22 lb	1
10-944	781412109443	Bagged	6.00 in	-	0.15 lb	1

ARMSTRONG 1/4" Drive Flex Handle / Breaker Bar

- Made in the USA - Quality and Availability
- Unique "Hour Glass" Handle Design Has a Concave Shape Conforming to the Grip of the Hand Which Reduces Fatigue and Improves Comfort
- Manufactured From High Alloy Steel Using the Most Up-To-Date Manufacturing Process and Heat Treat for Greater Strength and Durability
- Meets or Exceeds ASME B107.10M and US Federal Spec. GGG-W-641E



Cat. No.	UPC No.	Packaging	Overall Length	Product Weight	Shelf Pack Qty.
10-918	781412109184	Bagged	5.750 in	0.16 lb	1

ARMSTRONG 1/4" Drive T-Handle

- Made in the USA - Quality and Availability
- Manufactured From High Alloy Steel Using the Most Up-To-Date Manufacturing Process and Heat Treat for Greater Strength and Durability
- Meets or Exceeds ASME B107.10M and US Federal Spec. GGG-W-641E



Cat. No.	UPC No.	Packaging	Overall Length	Product Weight	Shelf Pack Qty.
10-938	781412109382	Bagged	5.000 in	0.12 lb	1

ARMSTRONG® 1/4" Drive Universal Joint

- Made in the USA - Quality and Availability
- Maximum Operation Angle of 45 Degrees
- Unique Modified Ear Design Prevents Lock-Up at Extreme Angles, Allowing for Smooth, Continuous Operation
- Manufactured From High Alloy Steel Using the Most Up-To-Date Manufacturing Process and Heat Treat for Greater Strength and Durability
- Meets or Exceeds Aerospace Standard AS4283A-2004, ASME B107.10M and US Federal Spec. GGG-W-641E



Cat. No.	UPC No.	Packaging	Overall Length	Female Drive Size	Male Drive Size	Product Weight	Shelf Pack Qty.
10-947	781412109474	Bagged	1.500 in	1/4"	1/4"	0.04 lb	1

ARMSTRONG® 1/4" Drive Adapters

- Made in the USA - Quality and Availability
- Manufactured From High Alloy Steel Using the Most Up-To-Date Manufacturing Process and Heat Treat for Greater Strength and Durability
- Meets or Exceeds ASME B107.10M and US Federal Spec. GGG-W-641E



Cat. No.	UPC No.	Packaging	Overall Length	Female Drive Size	Male Drive Size	Product Weight	Shelf Pack Qty.
10-952	781412109528	Bagged	1.138 in	1/4"	3/8"	0.06 lb	1
10-952A	781412105292	Bagged	1.138 in	1/4"	3/8"	0.03 lb	1

ARMSTRONG® 1/4" Drive Locking Adapter



Cat. No.	UPC No.	Packaging	Length	Female Drive Size	Male Drive Size	Product Weight
10-931	781412109313	Bagged	1.625 in	1/4"	1/4"	0.06 lb

ARMSTRONG® 1/4" Drive Speeder Handle

- Made in the USA - Quality and Availability
- Unique "Hour Glass" Handle Design Has a Concave Shape Conforming to the Grip of the Hand Which Reduces Fatigue and Improves Comfort
- Manufactured From High Alloy Steel Using the Most Up-To-Date Manufacturing Process and Heat Treat for Greater Strength and Durability
- Meets or Exceeds ASME B107.10M and US Federal Spec. GGG-W-641E



Cat. No.	UPC No.	Packaging	Length	Product Weight	Shelf Pack Qty.
10-935	781412109351	Bulk with UPC	15.750 in	0.74 lb	1

1 / 4 "

3

RATCHETS / SOCKETS / DRIVE TOOLS / SETS

ARMSTRONG® 1/4" Drive Extensions

- Made in the USA - Quality and Availability
- Knurling on the Extension Shaft Provides a Non-Slip Grip to Quickly Run Down / Remove Fasteners
- No Knurling on "A" Suffix Part Numbers
- Meets or Exceeds ASME B107.10M and US Federal Spec. GGG-W-641E



Cat. No.	UPC No.	Packaging	Length	Wobble	Product Weight	Shelf Pack Qty.
10-919A	781412109191	Bagged	1.500 in	No	0.03 lb	1
10-921	781412109214	Bagged	2.000 in	No	0.06 lb	1
10-922	781412109221	Bagged	4.000 in	No	0.11 lb	1
10-922A	781412102291	Bagged	3.500 in	No	0.06 lb	1
10-923	781412109238	Bagged	6.000 in	No	0.14 lb	1
10-923A	781412102390	Bagged	6.000 in	No	0.12 lb	1
10-924	781412109245	Bagged	10.000 in	No	0.23 lb	1
10-925	781412109252	Bagged	14.000 in	No	0.32 lb	1

ARMSTRONG® 1/4" Drive Flex Extension

- Made in the USA - Quality and Availability
- Meets or Exceeds ASME B107.10M and US Federal Spec. GGG-W-641E



Cat. No.	UPC No.	Packaging	Length	Wobble	Product Weight	Shelf Pack Qty.
10-929	781412109290	Bagged	6.000 in	No	0.09 lb	1

ARMSTRONG® 3 Pc. 1/4" Drive Wobble Extension Set

- Made in the USA - Quality and Availability
- Knurling on the Extension Shaft Provides a Non-Slip Grip to Quickly Run Down / Remove Fasteners
- Maximum Operation Angle of 17 Degrees



Cat. No.	UPC No.	Packaging	Product Weight	Shelf Pack Qty.
10-979	781412109795	Boxed	0.28 lb	1

Cat. No.	Description	Cat. No.	Description
10-973	1/4" Drive Wobble Extension 2"	10-975	1/4" Drive Wobble Extension 6"
10-974	1/4" Drive Wobble Extension 3"		

ARMSTRONG® 1/4" Drive Wobble Extensions

- Made in the USA - Quality and Availability
- Knurling on the Extension Shaft Provides a Non-Slip Grip to Quickly Run Down / Remove Fasteners
- Maximum Operation Angle of 17 Degrees



Cat. No.	UPC No.	Packaging	Length	Wobble	Product Weight	Shelf Pack Qty.
10-973	781412109733	Bagged	2.000 in	Yes	0.06 lb	1
10-974	781412109740	Bagged	3.000 in	Yes	0.08 lb	1
10-975	781412109757	Bagged	6.000 in	Yes	0.15 lb	1

ARMSTRONG® 3 Pc. 1/4" Drive Locking Extension Set

- Made in the USA - Quality and Availability
- Knurling on the Extension Shaft Provides a Non-Slip Grip to Quickly Run Down / Remove Fasteners
- Socket is Securely Locked to the Extension and Will Not Disengage Until Knurled Sleeve is Pulled, Safety and Convenience



Cat. No.	UPC No.	Packaging	Product Weight	Shelf Pack Qty.
10-920	781412109207	Boxed	0.67 lb	1

Cat. No.	Description	Cat. No.	Description
10-926	1/4" Drive Locking Extension 3"	10-928	1/4" Drive Locking Extension 15"
10-927	1/4" Drive Locking Extension 6"		

1 / 4 "

3

ARMSTRONG® 1/4" Drive Locking Extensions

- Made in the USA - Quality and Availability
- Knurling on the Extension Shaft Provides a Non-Slip Grip to Quickly Run Down / Remove Fasteners
- Socket is Securely Locked to the Extension and Will Not Disengage Until Knurled Sleeve is Pulled, Safety and Convenience



Cat. No.	UPC No.	Packaging	Length	Wobble	Product Weight	Shelf Pack Qty.
10-926	781412109269	Bagged	3.000 in	No	0.10 lb	1
10-927	781412109276	Bagged	6.000 in	No	0.20 lb	1
10-928	781412109283	Bagged	15.000 in	No	0.36 lb	1

RATCHETS / SOCKETS / DRIVE TOOLS / SETS

ARMSTRONG® 1/4" Drive 6 and 12 Point SAE Standard Length Sockets

- Made in the USA - Quality and Availability
- Radius Corner Design Engages the Flats of the Fastener, Not the Corners, Providing Up to 15% -20% More Torque While Reducing Fastener Rounding, Enhancing the Turning of Worn Fasteners
- EYE-D™ Markings Optimize Size Visibility, Also Providing SAE / Metric Differentiation
- Unique Socket Retention Method, Cold Form Ball Recess, Provides Consistent Secure Retention of the Socket to the Drive Tool Eliminating the Possibility of Either a Loose Fit or Tight Fit
- Socket Wall Dimensions are Optimized to Provide Strength While Retaining Access to Restricted Fasteners
- Meets or Exceeds ASME B107.1-2002 and US Federal Spec. GGG-W-641 E

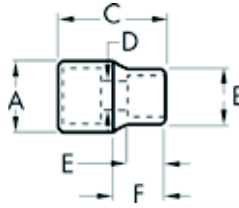

Cat. No.	UPC No.	Packaging	Drive Type	Fastener Size	Dim. A: Drive End	Dim. B: Wrench End	Dim. C: Overall Length	Dim. D: Bolt Clearance	Dim. E: Wrench Depth	Dim. F: Length to Shoulder	Product Weight	Shelf Pack Qty.
10-004D	781412100044	Bagged	6 Point	1/8 in	0.446 in	0.234 in	0.876 in	0.094 in	0.094 in	0.436 in	0.09 lb	1
10-005D	781412100051	Bagged	6 Point	5/32 in	0.446 in	0.274 in	0.876 in	0.120 in	0.160 in	0.436 in	0.02 lb	1
10-006D	781412100068	Bagged	6 Point	3/16 in	0.446 in	0.309 in	0.876 in	0.150 in	0.200 in	0.436 in	0.01 lb	1
10-007D	781412100075	Bagged	6 Point	7/32 in	0.446 in	0.344 in	0.876 in	0.150 in	0.200 in	0.436 in	0.03 lb	1
10-008D	781412100082	Bagged	6 Point	1/4 in	0.446 in	0.383 in	0.876 in	0.200 in	0.210 in	0.436 in	0.03 lb	1
10-009D	781412100099	Bagged	6 Point	9/32 in	0.446 in	0.423 in	0.876 in	0.180 in	0.220 in	0.436 in	0.03 lb	1
10-010	781412100105	Bagged	6 Point	5/16 in	0.463 in	0.463 in	0.876 in	0.208 in	0.290 in	-	0.03 lb	1
10-011	781412100112	Bagged	6 Point	11/32 in	0.502 in	0.502 in	0.876 in	0.208 in	0.310 in	-	0.03 lb	1
10-012	781412100129	Bagged	6 Point	3/8 in	0.546 in	0.546 in	0.876 in	0.434 in	0.500 in	-	0.03 lb	1
10-014	781412100143	Bagged	6 Point	7/16 in	0.613 in	0.613 in	0.876 in	0.443 in	0.500 in	-	0.04 lb	1
10-016D	781412100167	Bagged	6 Point	1/2 in	0.678 in	0.678 in	0.876 in	0.507 in	0.500 in	-	0.05 lb	1
10-018D	781412100181	Bagged	6 Point	9/16 in	0.697 in	0.697 in	0.876 in	0.570 in	0.463 in	-	0.09 lb	1
10-106	781412101065	Bagged	12 Point	3/16 in	0.442 in	0.309 in	0.876 in	0.193 in	0.200 in	0.436 in	0.02 lb	1
10-107	781412101072	Bagged	12 Point	7/32 in	0.442 in	0.344 in	0.876 in	0.224 in	0.200 in	0.436 in	0.02 lb	1
10-108	781412101089	Bagged	12 Point	1/4 in	0.442 in	0.382 in	0.876 in	0.225 in	0.210 in	0.436 in	0.02 lb	1
10-109	781412101096	Bagged	12 Point	9/32 in	0.442 in	0.423 in	0.876 in	0.225 in	0.220 in	0.436 in	0.02 lb	1
10-110D	781412101102	Bagged	12 Point	5/16 in	0.463 in	0.463 in	0.876 in	0.208 in	0.290 in	-	0.02 lb	1
10-111	781412101119	Bagged	12 Point	11/32 in	0.501 in	0.501 in	0.876 in	0.208 in	0.310 in	-	0.02 lb	1
10-112	781412101126	Bagged	12 Point	3/8 in	0.546 in	0.546 in	0.876 in	0.381 in	0.500 in	-	0.03 lb	1
10-114	781412101140	Bagged	12 Point	7/16 in	0.613 in	0.613 in	0.876 in	0.443 in	0.500 in	-	0.04 lb	1
10-116	781412101164	Bagged	12 Point	1/2 in	0.678 in	0.678 in	0.876 in	0.507 in	0.500 in	-	0.05 lb	1
10-118D	781412101188	Bagged	12 Point	9/16 in	0.777 in	0.777 in	0.876 in	0.570 in	0.500 in	-	0.08 lb	1

ARMSTRONG® 1/4" Drive 12 Point SAE AS954 Standard Length Aerospace Sockets

- Made in the USA - Quality and Availability
- Meets or Exceeds Aerospace Standard AS954E-2004
- Radius Corner Design Engages the Flats of the Fastener, Not the Corners, Providing Up to 15% -20% More Torque While Reducing Fastener Rounding, Enhancing the Turning of Worn Fasteners
- Thinner Socket Wall Dimensions Provide Increased Access to Restricted Fasteners with No Loss in Socket Strength
- Bolt Clearance Holes Have Larger Diameters and Depths to Accommodate a Wider Variety of Fasteners
- Special Plating Process Prevents Corrosion Under the Harshesht of Conditions
- Unique Socket Retention Method, Cold Form Ball Recess, Provides Consistent Secure Retention of the Socket to the Drive Tool Eliminating the Possibility of Either a Loose Fit or Tight Fit

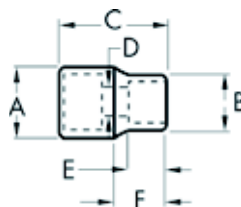

Cat. No.	UPC No.	Packaging	Drive Type	Fastener Size	Dim. A: Drive End	Dim. B: Wrench End	Dim. C: Overall Length	Dim. D: Bolt Clearance	Dim. E: Wrench Depth	Dim. F: Length to Shoulder	Product Weight	Shelf Pack Qty.
36-107	781412361070	Bagged	12 Point	7/32 in	0.435 in	0.338 in	0.876 in	0.215 in	0.2 in	0.41 in	0.02 lb	1
36-108	781412361087	Bagged	12 Point	1/4 in	0.435 in	0.375 in	0.876 in	0.245 in	0.22 in	0.41 in	0.02 lb	1
36-109	781412361094	Bagged	12 Point	9/32 in	0.435 in	0.417 in	0.876 in	0.265 in	0.22 in	0.41 in	0.02 lb	1
36-110	781412361100	Bagged	12 Point	5/16 in	0.462 in	0.462 in	0.876 in	0.26 in	0.26 in	-	0.02 lb	1
36-111	781412361117	Bagged	12 Point	11/32 in	0.494 in	0.494 in	0.876 in	0.32 in	0.28 in	-	0.03 lb	1
36-112	781412361124	Bagged	12 Point	3/8 in	0.544 in	0.544 in	0.876 in	0.37 in	0.5 in	-	0.03 lb	1
36-114	781412361148	Bagged	12 Point	7/16 in	0.613 in	0.613 in	1.003 in	0.435 in	0.59 in	-	0.03 lb	1
36-116	781412361162	Bagged	12 Point	1/2 in	0.678 in	0.678 in	1.003 in	0.45 in	0.65 in	-	0.04 lb	1

1 / 4 "

3

RATCHETS / SOCKETS / DRIVE TOOLS / SETS

ARMSTRONG® 1/4" Drive 6 Point SAE A Series Standard Length Sockets

- Made in the USA - Quality and Availability
- Meets or Exceeds ASME B107.1-2002 and US Federal Spec. GGG-W-641 E
- Hard Stamp Only, No EYE-D™ Markings



Cat. No.	UPC No.	Packaging	Drive Type	Fastener Size	Product Weight	Shelf Pack Qty.
10-005A	781412105001	Boxed	6 Point	5/32 in	0.06 lb	5
10-006A	781412106008	Boxed	6 Point	3/16 in	0.06 lb	5
10-007A	781412107005	Boxed	6 Point	7/32 in	0.06 lb	5
10-008A	781412108002	Boxed	6 Point	1/4 in	0.06 lb	5
10-009A	781412109009	Boxed	6 Point	9/32 in	0.07 lb	5
10-010AD	781412101003	Boxed	6 Point	5/16 in	0.08 lb	5
10-011AD	781412111002	Boxed	6 Point	11/32 in	0.10 lb	5
10-012A	781412101201	Boxed	6 Point	3/8 in	0.12 lb	5
10-014A	781412101409	Boxed	6 Point	7/16 in	0.14 lb	5
10-016A	781412101607	Boxed	6 Point	1/2 in	0.16 lb	5

ARMSTRONG® 1/4" Drive 6 and 12 Point Metric Standard Length Sockets

- Made in the USA - Quality and Availability
- Radius Corner Design Engages the Flats of the Fastener, Not the Corners, Providing Up to 15% -20% More Torque While Reducing Fastener Rounding, Enhancing the Turning of Worn Fasteners
- EYE-D™ Markings Optimize Size Visibility, Also Providing SAE / Metric Differentiation
- Unique Socket Retention Method, Cold Form Ball Recess, Provides Consistent Secure Retention of the Socket to the Drive Tool Eliminating the Possibility of Either a Loose Fit or Tight Fit
- Socket Wall Dimensions are Optimized to Provide Strength While Retaining Access to Restricted Fasteners
- Meets or Exceeds ASME B107.5M-2002

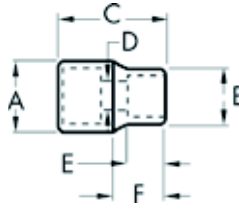

Cat. No.	UPC No.	Drive Type	Fastener Size	Dim. A: Drive End	Dim. B: Wrench End	Dim. C: Overall Length	Dim. D: Bolt	Dim. E: Wrench Depth	Dim. F: Length to Shoulder	Product Weight	Shelf Pack Qty.
37-004	781412370041	Bagged	4 mm	0.445 in	0.276 in	0.878 in	0.146 in	0.161 in	0.437 in	0.02 lb	1
37-081	781412370812	Bagged	4.5 mm	0.453 in	0.311 in	0.874 in	0.185 in	0.181 in	0.437 in	0.02 lb	1
37-005	781412370058	Bagged	5 mm	0.445 in	0.307 in	0.878 in	0.161 in	0.181 in	0.437 in	0.03 lb	1
37-083	781412370836	Bagged	5.5 mm	0.445 in	0.343 in	0.878 in	0.161 in	0.197 in	0.437 in	0.03 lb	1
37-006	781412370065	Bagged	6 mm	0.445 in	0.362 in	0.878 in	0.193 in	0.201 in	0.437 in	0.03 lb	1
37-007	781412370072	Bagged	7 mm	0.445 in	0.421 in	0.878 in	0.217 in	0.220 in	0.437 in	0.03 lb	1
37-008	781412370089	Bagged	8 mm	0.465 in	0.465 in	0.878 in	0.209 in	0.291 in	-	0.03 lb	1
37-009D	781412370096	Bagged	9 mm	0.504 in	0.504 in	0.878 in	0.209 in	0.311 in	-	0.03 lb	1
37-010	781412370102	Bagged	10 mm	0.547 in	0.547 in	0.878 in	0.402 in	0.500 in	-	0.03 lb	1
37-011	781412370119	Bagged	11 mm	0.614 in	0.614 in	0.878 in	0.441 in	0.500 in	-	0.04 lb	1
37-012D	781412370126	Bagged	12 mm	0.673 in	0.673 in	0.878 in	0.480 in	0.500 in	-	0.04 lb	1
37-013	781412370133	Bagged	13 mm	0.724 in	0.724 in	0.878 in	0.520 in	0.500 in	-	0.05 lb	1
37-014D	781412370140	Bagged	14 mm	0.772 in	0.772 in	0.878 in	0.559 in	0.500 in	-	0.08 lb	1
37-015	781412370157	Bagged	15 mm	0.811 in	0.811 in	0.878 in	0.598 in	0.500 in	-	0.08 lb	1
37-105	781412371055	Bagged	5 mm	0.445 in	0.307 in	0.878 in	0.161 in	0.181 in	0.437 in	0.02 lb	1
37-183	781412371833	Bagged	5.5 mm	0.445 in	0.362 in	0.878 in	0.193 in	0.201 in	-	0.05 lb	1
37-106	781412371062	Bagged	6 mm	0.445 in	0.362 in	0.878 in	0.193 in	0.201 in	0.437 in	0.05 lb	1
37-107	781412371079	Bagged	7 mm	0.445 in	0.421 in	0.878 in	0.209 in	0.22 in	0.437 in	0.05 lb	1
37-108	781412371086	Bagged	8 mm	0.465 in	0.465 in	0.878 in	0.209 in	0.291 in	-	0.05 lb	1
37-109	781412371093	Bagged	9 mm	0.504 in	0.504 in	0.878 in	0.209 in	0.311 in	-	0.05 lb	1
37-110	781412371109	Bagged	10 mm	0.547 in	0.547 in	0.878 in	0.402 in	0.500 in	-	0.05 lb	1
37-111	781412371116	Bagged	11 mm	0.614 in	0.614 in	0.878 in	0.441 in	0.500 in	-	0.05 lb	1
37-112	781412371123	Bagged	12 mm	0.673 in	0.673 in	0.878 in	0.480 in	0.500 in	-	0.06 lb	1
37-113	781412371130	Bagged	13 mm	0.724 in	0.724 in	0.878 in	0.520 in	0.500 in	-	0.07 lb	1
37-114	781412371147	Bagged	14 mm	0.772 in	0.772 in	0.878 in	0.559 in	0.500 in	-	0.08 lb	1

ARMSTRONG® 1/4" Drive 6 Point Metric A Series Standard Length Sockets

- Made in the USA - Quality and Availability
- Meets or Exceeds ASME B107.5M-2002
- Hard Stamp Only, No EYE-D™ Markings



Cat. No.	UPC No.	Packaging	Drive Type	Fastener Size	Product Weight	Shelf Pack Qty.
37-004A	781412374001	Bagged	6 Point	4 mm	0.03 lb	5
37-005A	781412370508	Bagged	6 Point	5 mm	0.03 lb	5
37-006A	781412370607	Bagged	6 Point	6 mm	0.03 lb	5
37-007A	781412370706	Bagged	6 Point	7 mm	0.03 lb	5
37-008A	781412370805	Bagged	6 Point	8 mm	0.03 lb	5
37-009A	781412370904	Bagged	6 Point	9 mm	0.05 lb	5
37-010A	781412371000	Bagged	6 Point	10 mm	0.07 lb	5
37-011A	781412371017	Bagged	6 Point	11 mm	0.08 lb	5
37-012A	781412371208	Bagged	6 Point	12 mm	0.09 lb	5
37-013A	781412371307	Bagged	6 Point	13 mm	0.05 lb	5

1 / 4 "

3

RATCHETS / SOCKETS / DRIVE TOOLS / SETS

ARMSTRONG® 1/4" Drive 6 and 12 Point SAE Deep Length Sockets

- Made in the USA - Quality and Availability
- Radius Corner Design Engages the Flats of the Fastener, Not the Corners, Providing Up to 15% -20% More Torque While Reducing Fastener Rounding, Enhancing the Turning of Worn Fasteners
- EYE-D™ Markings Optimize Size Visibility, Also Providing SAE / Metric Differentiation
- Unique Socket Retention Method, Cold Form Ball Recess, Provides Consistent Secure Retention of the Socket to the Drive Tool Eliminating the Possibility of Either a Loose Fit or Tight Fit
- Socket Wall Dimensions are Optimized to Provide Strength While Retaining Access to Restricted Fasteners
- Meets or Exceeds ASME B107.1-2002 and US Federal Spec. GGG-W-641 E

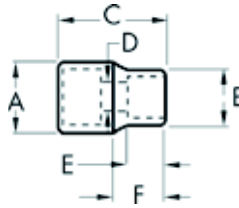

Cat. No.	UPC No.	Packaging	Drive Type	Fastener Size	Dim. A: Drive End	Dim. B: Wrench End	Dim. C: Overall Length	Dim. D: Bolt Clearance	Dim. E: Wrench Depth	Dim. F: Length to Shoulder	Product Weight	Shelf Pack Qty.
10-204	781412102048	Bagged	6 Point	1/8 in	0.446 in	0.234 in	2.000 in	0.094 in	0.200 in	0.980 in	0.04 lb	1
10-205	781412102055	Bagged	6 Point	5/32 in	0.446 in	0.274 in	2.000 in	0.210 in	0.190 in	0.980 in	0.04 lb	1
10-206	781412102062	Bagged	6 Point	3/16 in	0.446 in	0.309 in	2.000 in	0.210 in	0.190 in	0.980 in	0.05 lb	1
10-207	781412102079	Bagged	6 Point	7/32 in	0.446 in	0.350 in	2.000 in	0.210 in	0.190 in	0.980 in	0.05 lb	1
10-208	781412102086	Bagged	6 Point	1/4 in	0.446 in	0.391 in	2.000 in	0.210 in	0.190 in	0.980 in	0.04 lb	1
10-209	781412102093	Bagged	6 Point	9/32 in	0.446 in	0.432 in	2.000 in	0.210 in	0.190 in	0.980 in	0.06 lb	1
10-210	781412102109	Bagged	6 Point	5/16 in	0.446 in	0.446 in	2.000 in	0.255 in	0.650 in	-	0.05 lb	1
10-211	781412102116	Bagged	6 Point	11/32 in	0.495 in	0.495 in	2.000 in	0.255 in	0.650 in	-	0.07 lb	1
10-212	781412102123	Bagged	6 Point	3/8 in	0.549 in	0.549 in	2.000 in	0.325 in	0.900 in	-	0.08 lb	1
10-214	781412102147	Bagged	6 Point	7/16 in	0.613 in	0.613 in	2.000 in	0.405 in	0.900 in	-	0.09 lb	1
10-216	781412102161	Bagged	6 Point	1/2 in	0.678 in	0.678 in	2.000 in	0.420 in	0.900 in	-	0.12 lb	1
10-218	781412102185	Bagged	6 Point	9/16 in	0.771 in	0.771 in	2.000 in	0.570 in	1.430 in	-	0.14 lb	1
10-306	781412103069	Bagged	12 Point	3/16 in	0.446 in	0.309 in	2.000 in	0.300 in	0.190 in	0.880 in	0.04 lb	1
10-307	781412103076	Bagged	12 Point	7/32 in	0.446 in	0.350 in	2.000 in	0.300 in	0.190 in	0.880 in	0.04 lb	1
10-308	781412103083	Bagged	12 Point	1/4 in	0.446 in	0.391 in	2.000 in	0.257 in	0.190 in	0.880 in	0.04 lb	1
10-309	781412103090	Bagged	12 Point	9/32 in	0.446 in	0.432 in	2.000 in	0.200 in	0.190 in	0.880 in	0.05 lb	1
10-310	781412103106	Bagged	12 Point	5/16 in	0.459 in	0.459 in	2.000 in	0.245 in	0.650 in	-	0.05 lb	1
10-311	781412103113	Bagged	12 Point	11/32 in	0.495 in	0.495 in	2.000 in	0.245 in	0.650 in	-	0.07 lb	1
10-312	781412103120	Bagged	12 Point	3/8 in	0.544 in	0.544 in	2.000 in	0.325 in	0.900 in	-	0.08 lb	1
10-314	781412103144	Bagged	12 Point	7/16 in	0.614 in	0.614 in	2.000 in	0.385 in	0.900 in	-	0.09 lb	1
10-316	781412103168	Bagged	12 Point	1/2 in	0.678 in	0.678 in	2.000 in	0.420 in	0.900 in	-	0.11 lb	1
10-318	781412103182	Bagged	12 Point	9/16 in	0.770 in	0.770 in	2.000 in	0.570 in	1.430 in	-	0.13 lb	1

ARMSTRONG® 1/4" Drive 12 Point SAE AS954 Deep Length Aerospace Sockets

- Made in the USA - Quality and Availability
- Meets or Exceeds Aerospace Standard AS954E-2004
- Radius Corner Design Engages the Flats of the Fastener, Not the Corners, Providing Up to 15% -20% More Torque While Reducing Fastener Rounding, Enhancing the Turning of Worn Fasteners
- Thinner Socket Wall Dimensions Provide Increased Access to Restricted Fasteners with No Loss in Socket Strength
- Bolt Clearance Holes Have Larger Diameters and Depths to Accommodate a Wider Variety of Fasteners
- Special Plating Process Prevents Corrosion Under the Harshest of Conditions
- Unique Socket Retention Method, Cold Form Ball Recess, Provides Consistent Secure Retention of the Socket to the Drive Tool Eliminating the Possibility of Either a Loose Fit or Tight Fit

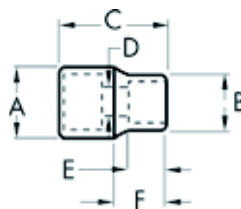

Cat. No.	UPC No.	Drive Type	Fastener Size	Dim. A: Drive End	Dim. B: Wrench End	Dim. C: Overall Length	Dim. D: Bolt Clearance	Dim. E: Wrench Depth	Dim. F: Length to Shoulder	Product Weight	Shelf Pack Qty.
36-208	781412362084	12 Point	1/4 in	0.435 in	0.374 in	2 in	0.24 in	0.25 in	0.83 in	0.05 lb	1
36-210	781412362107	12 Point	5/16 in	0.446 in	0.446 in	2 in	0.28 in	0.65 in	-	0.05 lb	1
36-212	781412362121	12 Point	3/8 in	0.542 in	0.542 in	2 in	0.36 in	0.9 in	-	0.07 lb	1

1 / 4 "

ARMSTRONG® 1/4" Drive 6 Point SAE A Series Deep Length Sockets

- Made in the USA - Quality and Availability
- Meets or Exceeds ASME B107.1-2002 and US Federal Spec. GGG-W-641 E
- Hard Stamp Only, No EYE-D™ Markings



Cat. No.	UPC No.	Packaging	Drive Type	Fastener Size	Product Weight	Shelf Pack Qty.
10-206A	781412102604	Boxed	6 Point	3/16 in	0.05 lb	5
10-207A	781412102703	Boxed	6 Point	7/32 in	0.11 lb	5
10-208A	781412102802	Boxed	6 Point	1/4 in	0.11 lb	5
10-209A	781412102901	Boxed	6 Point	9/32 in	0.11 lb	5
10-210A	781412120103	Boxed	6 Point	5/16 in	0.11 lb	5
10-211A	781412101218	Boxed	6 Point	11/32 in	0.12 lb	5
10-212A	781412102215	Boxed	6 Point	3/8 in	0.12 lb	5
10-214A	781412102413	Boxed	6 Point	7/16 in	0.13 lb	5
10-216A	781412102611	Boxed	6 Point	1/2 in	0.13 lb	5

RATCHETS / SOCKETS / DRIVE TOOLS / SETS

ARMSTRONG® 1/4" Drive 6 Point Metric Deep Length Sockets

- Made in the USA - Quality and Availability
- Radius Corner Design Engages the Flats of the Fastener, Not the Corners, Providing Up to 15% -20% More Torque While Reducing Fastener Rounding, Enhancing the Turning of Worn Fasteners
- EYE-D™ Markings Optimize Size Visibility, Also Providing SAE / Metric Differentiation
- Unique Socket Retention Method, Cold Form Ball Recess, Provides Consistent Secure Retention of the Socket to the Drive Tool Eliminating the Possibility of Either a Loose Fit or Tight Fit
- Socket Wall Dimensions are Optimized to Provide Strength While Retaining Access to Restricted Fasteners
- Meets or Exceeds ASME B107.5M-2002

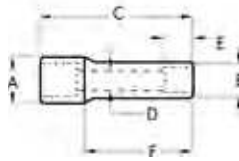

Cat. No.	UPC No.	Drive Type	Fastener Size	Dim. A: Drive End	Dim. B: Wrench End	Dim. C: Overall Length	Dim. D: Bolt Clearance	Dim. E: Wrench Depth	Dim. F: Length to Shoulder	Product Weight	Shelf Pack Qty.
37-204	781412372045	6 Point	4 mm	0.449 in	0.276 in	2.000 in	0.209 in	0.189 in	0.882 in	0.04 lb	1
37-281	781412372816	6 Point	4.5 mm	0.449 in	0.315 in	2.000 in	0.209 in	0.295 in	0.890 in	0.05 lb	1
37-205	781412372052	6 Point	5 mm	0.449 in	0.315 in	2.000 in	0.209 in	0.283 in	0.890 in	0.05 lb	1
37-283	781412372830	6 Point	5.5 mm	0.449 in	0.350 in	2.000 in	0.209 in	0.295 in	0.890 in	0.00 lb	1
37-206	781412372069	6 Point	6 mm	0.445 in	0.370 in	2.000 in	0.209 in	0.189 in	0.890 in	0.06 lb	1
37-207	781412372076	6 Point	7 mm	0.445 in	0.421 in	2.000 in	0.209 in	0.201 in	0.890 in	0.08 lb	1
37-208	781412372083	6 Point	8 mm	0.445 in	0.445 in	2.000 in	0.197 in	0.650 in	-	0.05 lb	1
37-209	781412372090	6 Point	9 mm	0.496 in	0.496 in	2.000 in	0.240 in	0.650 in	-	0.07 lb	1
37-210	781412372106	6 Point	10 mm	0.543 in	0.543 in	2.000 in	0.240 in	0.902 in	-	0.07 lb	1
37-211	781412372113	6 Point	11 mm	0.614 in	0.614 in	2.000 in	0.240 in	0.902 in	-	0.09 lb	1
37-212	781412372120	6 Point	12 mm	0.673 in	0.673 in	2.000 in	0.240 in	0.902 in	-	0.12 lb	1
37-213	781412372137	6 Point	13 mm	0.724 in	0.724 in	2.000 in	0.240 in	9.000 in	-	0.12 lb	1
37-214	781412372144	6 Point	14 mm	0.772 in	0.772 in	2.000 in	0.559 in	1.429 in	-	0.15 lb	1
37-215	781412372151	6 Point	15 mm	0.819 in	0.819 in	2.000 in	0.598 in	1.461 in	-	0.15 lb	1

ARMSTRONG® 1/4" Drive 6 Point Metric A Series Deep Length Sockets

- Made in the USA - Quality and Availability
- Meets or Exceeds ASME B107.5M-2002
- Hard Stamp Only, No EYE-D™ Markings



Cat. No.	UPC No.	Packaging	Drive Type	Fastener Size	Product Weight	Shelf Pack Qty.
37-204A	781412372403	Bagged	6 Point	4 mm	0.06 lb	5
37-205A	781412372502	Bagged	6 Point	5 mm	0.07 lb	5
37-206A	781412372601	Bagged	6 Point	6 mm	0.06 lb	5
37-207A	781412372700	Bagged	6 Point	7 mm	0.09 lb	5
37-208A	781412372809	Bagged	6 Point	8 mm	0.09 lb	5
37-209A	781412372908	Bagged	6 Point	9 mm	0.09 lb	5
37-210A	781412372014	Bagged	6 Point	10 mm	0.11 lb	5
37-211A	781412371215	Bagged	6 Point	11 mm	0.11 lb	5
37-212A	781412372212	Bagged	6 Point	12 mm	0.13 lb	5
37-213A	781412372311	Bagged	6 Point	13 mm	0.13 lb	5
37-214A	781412372410	Bagged	6 Point	14 mm	0.13 lb	5

1 / 4 "

3

RATCHETS / SOCKETS / DRIVE TOOLS / SETS

ARMSTRONG® 1/4" Drive 4 and 8 Point SAE Standard Length Sockets

- Made in the USA - Quality and Availability
- EYE-D™ Markings Optimize Size Visibility, Also Providing SAE / Metric Differentiation
- Unique Socket Retention Method, Cold Form Ball Recess, Provides Consistent Secure Retention of the Socket to the Drive Tool Eliminating the Possibility of Either a Loose Fit or Tight Fit
- Socket Wall Dimensions are Optimized to Provide Strength While Retaining Access to Restricted Fasteners
- 10-406, 10-408 are 4 Point, 10-410, 10-412 are 8 Point
- Meets or Exceeds ASME B107.1-2002 and US Federal Spec. GGG-W-641 E

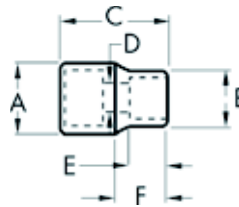

Cat. No.	UPC No.	Drive Type	Fastener Size	Dim. A: Drive End	Dim. B: Wrench End	Dim. C: Overall Length	Dim. D: Bolt Clearance	Dim. E: Wrench Depth	Dim. F: Length to Shoulder	Product Weight	Shelf Pack Qty.
10-406	781412104066	4 Point	3/16 in	0.446 in	0.382 in	0.876 in	0.200 in	0.200 in	0.436 in	0.03 lb	1
10-408	781412104080	8 Point	1/4 in	0.463 in	0.463 in	0.876 in	0.240 in	0.280 in	-	0.03 lb	1
10-410	781412104103	8 Point	5/16 in	0.546 in	0.546 in	0.876 in	0.320 in	0.480 in	-	0.03 lb	1
10-412	781412104127	8 Point	3/8 in	0.678 in	0.678 in	0.876 in	0.381 in	0.500 in	-	0.06 lb	1

ARMSTRONG® 1/4" Drive SAE/Metric Hex Bit Sockets

- Made in the USA - Quality and Availability
- Bits are Manufactured to the Highest Tolerances and Specifications for Straightness, Concentricity, and Precise Tip Fit to the Fastener
- Bits are Manufactured From High Alloy Steel Using the Most Up-To-Date Manufacturing Process and Heat Treat to Prevent Shattering and Premature Bit Wear
- Bits are Retained in the Bit Holder By a Set Screw That Locks Securely Into a Groove on the Bit for Positive Bit Retention As Well As Simple, Easy Bit Replacement
- Broached Hex in the Bit Holder Allows Higher Torque Loads

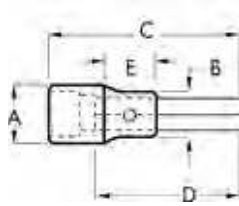

Cat. No.	UPC No.	Packaging	Fastener Size	Dim. A: Drive End	Dim. B: Nose Diameter	Dim. C: Overall Length	Dim. D: Bit Length	Replaceable Bit?	Replacement Bit	Exposed Bit Length	Product Weight	Shelf Pack Qty.
10-703	781412107036	Bagged	0.050 in	0.500 in	0.500 in	1.875 in	1.312 in	Yes	94-503	1.000	0.03 lb	1
10-704	781412107043	Bagged	1/16 in	0.500 in	0.500 in	1.875 in	1.312 in	Yes	94-504	1.000	0.04 lb	1
10-705	781412107050	Bagged	5/64 in	0.500 in	0.500 in	1.875 in	1.312 in	Yes	94-505	1.000	0.04 lb	1
10-706	781412107067	Bagged	3/32 in	0.500 in	0.500 in	1.875 in	1.312 in	Yes	94-506	1.000	0.04 lb	1
10-707	781412107074	Bagged	7/64 in	0.500 in	0.500 in	1.875 in	1.312 in	Yes	94-507	1.000	0.04 lb	1
10-708	781412107081	Bagged	1/8 in	0.500 in	0.500 in	1.875 in	1.312 in	Yes	94-508	1.000	0.04 lb	1
10-709	781412107098	Bagged	9/64 in	0.500 in	0.500 in	1.875 in	1.312 in	Yes	94-509	1.000	0.04 lb	1
10-710	781412107104	Bagged	5/32 in	0.500 in	0.500 in	1.875 in	1.312 in	Yes	94-510	1.000	0.05 lb	1
10-711	781412107111	Bagged	3/16 in	0.500 in	0.500 in	1.875 in	1.312 in	Yes	94-361	1.000	0.04 lb	1
10-712	781412107128	Bagged	7/32 in	0.500 in	0.500 in	1.875 in	1.312 in	Yes	94-362	1.000	0.05 lb	1
10-713	781412107135	Bagged	1/4 in	0.500 in	0.500 in	1.875 in	1.360 in	Yes	94-363	1.000	0.07 lb	1
10-714	781412107142	Bagged	5/16 in	0.500 in	0.500 in	1.875 in	1.360 in	Yes	94-364	1.000	0.07 lb	1
37-703	781412377033	Bagged	2 mm	0.500 in	0.500 in	1.874 in	1.311 in	Yes	94-603	1.000	0.04 lb	1
37-704	781412377040	Bagged	2.5 mm	0.500 in	0.500 in	1.874 in	1.311 in	Yes	94-604	1.000	0.05 lb	1
37-705	781412377057	Bagged	3 mm	0.500 in	0.500 in	1.874 in	1.311 in	Yes	94-605	1.000	0.05 lb	1
37-707	781412377071	Bagged	4 mm	0.500 in	0.500 in	1.874 in	1.311 in	Yes	94-607	1.000	0.05 lb	1
37-709	781412377095	Bagged	5 mm	0.500 in	0.500 in	1.874 in	1.311 in	Yes	94-389	1.000	0.05 lb	1
37-711	781412377118	Bagged	6 mm	0.500 in	0.500 in	1.874 in	1.311 in	Yes	94-391	1.000	0.06 lb	1
37-713	781412377132	Bagged	8 mm	0.500 in	0.500 in	1.874 in	1.311 in	Yes	94-393	1.000	0.07 lb	1

ARMSTRONG® 1/4" Drive SAE Extra Long Hex Bit Sockets

- Made in the USA - Quality and Availability
- Bits are Manufactured to the Highest Tolerances and Specifications for Straightness, Concentricity, and Precise Tip Fit to the Fastener
- Bits are Manufactured From High Alloy Steel Using the Most Up-To-Date Manufacturing Process and Heat Treat to Prevent Shattering and Premature Bit Wear
- Bits are Retained in the Bit Holder By a Set Screw That Locks Securely Into a Groove on the Bit for Positive Bit Retention As Well As Simple, Easy Bit Replacement
- Broached Hex in the Bit Holder Allows Higher Torque Loads

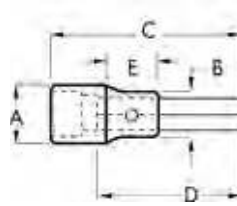

Cat. No.	UPC No.	Packaging	Fastener Size	Dim. A: Drive End	Dim. B: Nose Diameter	Dim. C: Overall Length	Dim. D: Bit Length	Replaceable Bit?	Replacement Bit	Exposed Bit Length	Product Weight	Shelf Pack Qty.
10-743	781412107432	Bagged	0.050 in	0.500 in	0.500 in	3.312 in	2.750 in	Yes	94-543	2.438	0.05 lb	1
10-744	781412107449	Bagged	1/16 in	0.500 in	0.500 in	3.312 in	2.750 in	Yes	94-544	2.438	0.05 lb	1
10-745	781412107456	Bagged	5/64 in	0.500 in	0.500 in	3.312 in	2.750 in	Yes	94-545	2.438	0.05 lb	1
10-746	781412107463	Bagged	3/32 in	0.500 in	0.500 in	3.312 in	2.750 in	Yes	94-546	2.438	0.05 lb	1
10-747	781412107470	Bagged	7/64 in	0.500 in	0.500 in	3.312 in	2.750 in	Yes	94-547	2.438	0.05 lb	1
10-748	781412107487	Bagged	1/8 in	0.500 in	0.500 in	4.437 in	3.875 in	Yes	94-548	3.562	0.06 lb	1
10-749	781412107494	Bagged	9/64 in	0.500 in	0.500 in	4.437 in	3.875 in	Yes	94-549	3.562	0.06 lb	1
10-750	781412107500	Bagged	5/32 in	0.500 in	0.500 in	4.437 in	3.875 in	Yes	94-370	3.562	0.06 lb	1
10-751	781412107517	Bagged	3/16 in	0.500 in	0.500 in	4.437 in	3.875 in	Yes	94-371	3.562	0.08 lb	1
10-752	781412107524	Bagged	7/32 in	0.500 in	0.500 in	4.437 in	3.875 in	Yes	94-372	3.562	0.09 lb	1
10-753	781412107531	Bagged	1/4 in	0.500 in	0.500 in	4.437 in	3.937 in	Yes	94-373	3.562	0.10 lb	1
10-754	781412107548	Bagged	5/16 in	0.500 in	0.500 in	4.437 in	3.937 in	Yes	94-374	3.562	0.13 lb	1

1 / 4 "

3

RATCHETS / SOCKETS / DRIVE TOOLS / SETS

ARMSTRONG® 1/4" Drive Torx® Bit Sockets

- Made in the USA - Quality and Availability
- Bits are Manufactured to the Highest Tolerances and Specifications for Straightness, Concentricity, and Precise Tip Fit to the Fastener
- Bits are Manufactured From High Alloy Steel Using the Most Up-To-Date Manufacturing Process and Heat Treat to Prevent Shattering and Premature Bit Wear
- Bits are Retained in the Bit Holder By a Set Screw That Locks Securely Into a Groove on the Bit for Positive Bit Retention As Well As Simple, Easy Bit Replacement
- Broached Hex in the Bit Holder Allows Higher Torque Loads

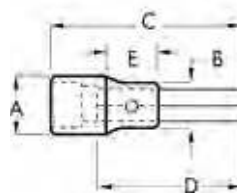

Cat. No.	UPC No.	Packaging	Fastener Size	Dim. A: Drive End	Dim. B: Nose Diameter	Dim. C: Overall Length	Dim. D: Bit Length	Replaceable Bit?	Replacement Bit	Exposed Bit Length	Product Weight	Shelf Pack Qty.
10-868	781412108682	Bagged	T8	0.500 in	0.500 in	1.500 in	1.000 in	Yes	94-168	0.641 in	0.03 lb	1
10-870	781412108705	Bagged	T10	0.500 in	0.500 in	1.500 in	1.000 in	Yes	94-170	0.641 in	0.05 lb	1
10-872	781412108729	Bagged	T15	0.500 in	0.500 in	1.500 in	1.000 in	Yes	94-172	0.641 in	0.05 lb	1
10-874	781412108743	Bagged	T20	0.500 in	0.500 in	1.500 in	1.000 in	Yes	94-174	0.641 in	0.05 lb	1
10-876	781412108767	Bagged	T25	0.500 in	0.500 in	1.500 in	1.000 in	Yes	94-176	0.641 in	0.04 lb	1
10-878	781412108781	Bagged	T27	0.500 in	0.500 in	1.500 in	1.000 in	Yes	94-178	0.641 in	0.05 lb	1
10-880	781412108804	Bagged	T30	0.500 in	0.500 in	1.500 in	1.000 in	Yes	94-180	0.641 in	0.05 lb	1

ARMSTRONG 1/4" Drive Slotted/Phillips Bit Sockets

- Made in the USA - Quality and Availability
- Bits are Manufactured to the Highest Tolerances and Specifications for Straightness, Concentricity, and Precise Tip Fit to the Fastener
- Bits are Manufactured From High Alloy Steel Using the Most Up-To-Date Manufacturing Process and Heat Treat to Prevent Shattering and Premature Bit Wear
- Bits are Retained in the Bit Holder By a Set Screw That Locks Securely Into a Groove on the Bit for Positive Bit Retention As Well As Simple, Easy Bit Replacement
- Broached Hex in the Bit Holder Allows Higher Torque Loads
- Meets or Exceeds US Federal Spec. GGG-W-001222

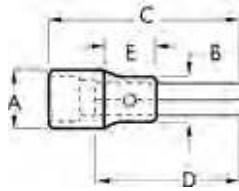

Cat. No.	UPC No.	Packaging	Fastener Size	Dim. A: Drive End	Dim. B: Nose Diameter	Dim. C: Overall Length	Dim. D: Bit Length	Replaceable Bit?	Replacement Bit	Exposed Bit Length	Product Weight	Shelf Pack Qty.
10-801	781412108019	Bagged	1/32 in	0.500 in	0.500 in	2.44 in	1.940 in	Yes	94-101	1.758	0.05 lb	1
10-802	781412108026	Bagged	1/32 in	0.500 in	0.500 in	2.44 in	1.940 in	Yes	94-102	1.758	0.06 lb	1
10-821	781412108217	Bagged	Phil. #1	0.500 in	0.500 in	1.900 in	1.400 in	Yes	94-121	1.046	0.05 lb	1
10-822	781412108224	Bagged	Phil. #2	0.500 in	0.500 in	1.900 in	1.400 in	Yes	94-122	1.046	0.05 lb	1
10-823	781412108231	Bagged	Phil. #3	0.500 in	0.500 in	1.900 in	1.400 in	Yes	94-125	1.046	0.06 lb	1

CRESCENT BRAND 1/4" Drive Pear Head Ratchet

- Pear-Head Design
- 72 Tooth Gear System Requires Only 5 Degree Swing
- Reversible
- Chrome Vanadium for Maximum Strength
- Meets ANSI Load Specs



Cat. No.	UPC No.	Packaging	Product Weight	Shelf Pack Qty.
RD08BK	037103215932	Bagged	0.25 lb	5