



SUPER LATEX A88

Synthetic polymer emulsion for cement mortars

To enhance cement mortar water resistance, flexibility & bonding ability.
Strengthens the cement mortar matrix

FEATURES/BENEFITS

- ✓ Eco-friendly with Low VOC / Non-toxic formulation
- ✓ Water resistant
- ✓ Enhance bonding/flexibility of cement mortars
- ✓ Enhanced durability of plasters/screeds
- ✓ Reduces risk of plasters cracks
- ✓ Enhances performances of cement mortars
- ✓ Increases the bonding between tiles and mortars

APPLICATION AREAS

- ✓ Bonding agent
- ✓ Tile fixing mortars
- ✓ Screeds
- ✓ Exterior/interior wall plasters
- ✓ Thin layer patching mortars
- ✓ Walkways
- ✓ Repair mortars
- ✓ Masonry mortars



DRITECH CHEMICALS SDN BHD (1184082-K)

23-3A, Oval Damansara, 685, Jalan Damansara, 60000 Kuala Lumpur, Malaysia

TEL: +603 7735 6015, FAX: +603 7735 6016

Product Data

Appearances / Colors	Milky white liquid
Packaging	4, 18 litres pails / 200litre drums
Storage	12 Months from date of production
Storage Condition	Dry conditions at Temperature between 5-35 Degree Celsius, protect against direct sunlight

Technical Data

Origin	Polymer emulsion
Specific Gravity	1.0 ± 0.01
Chloride content	N/a

System Build Up

a) Flexible skim coat finish system

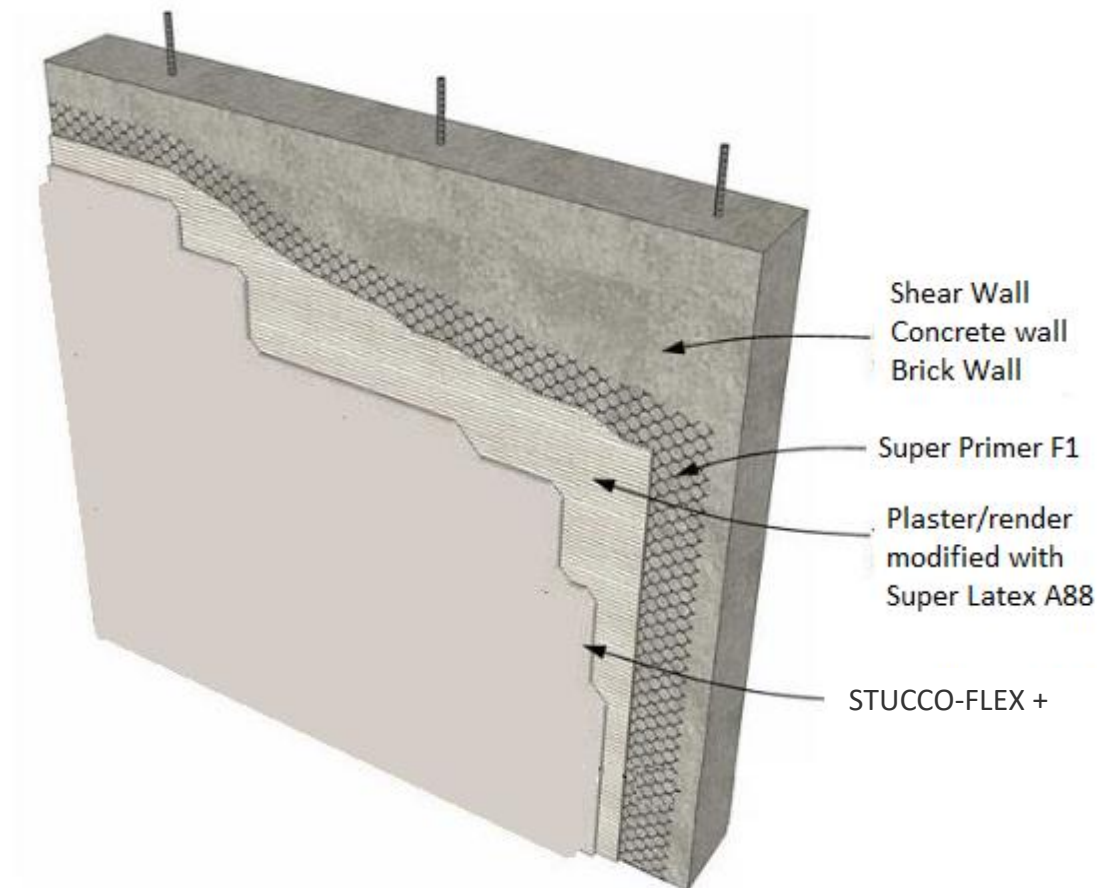

Steps	Descriptions
Substrate	Concrete, Dry-wall, Precast panel, bricks, light weigh blocks, etc
Primer	<i>SUPER PRIMER F1</i>
Plaster/Base Coat (Optional)	<i>Premix render / Site mix plaster with SUPER LATEX A88</i>
Finish	<i>STUCCO-FLEX +</i>

b) Tiles/stone finish

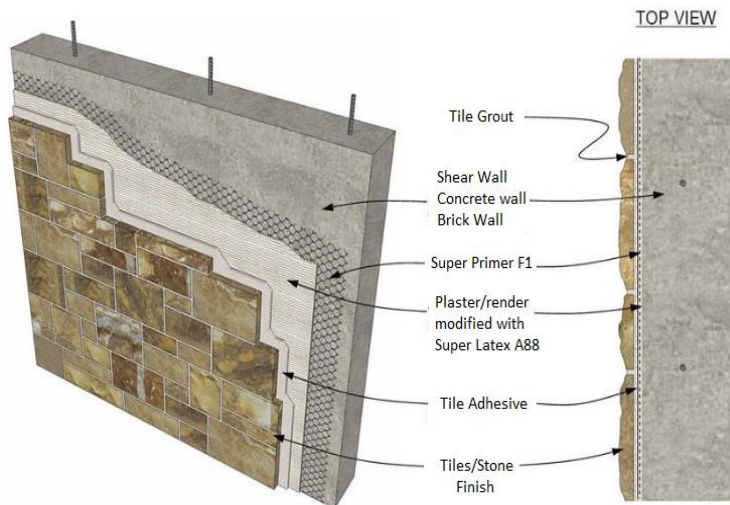

Steps	Descriptions
Substrate	Concrete, Dry-wall, Precast panel, bricks, light weight blocks, etc
Primer	<i>SUPER PRIMER F1</i>
Plaster/Base Coat (Optional)	<i>Premix render / Site mix plaster with SUPER LATEX A88</i>
Tile Adhesives	<i>Premix Tile Adhesives (C2TE + SUPER LATEX A88)</i>
Finish	<i>Tiles / Stones (Tile grouts + SUPER LATEX A88)</i>

SUBSTRATE

New concrete should be cured for at least 28 days and should have a Pull off strength $\geq 1.5 \text{ N/mm}^2$. Cement or mineral based substrates must be prepared mechanically using abrasive blast cleaning or scarifying equipment to remove cement laitance and to achieve an open textured surface. Loose friable material and weak concrete must be completely removed.

MIXING

Add **SUPER LATEX A88** directly to fresh cement to create a soft creamy bonding agent. To improve renders, plasters, repair materials, tiling adhesives, etc. add **SUPER LATEX A88** directly to the mix without any dilution.

TOOLS

Brush: With thick hair brush /Roller: short-piled lamb skin roller / Suitable spray machine, trowels

LIMITATIONS

- ❖ Ensure that temperature does not drop below 5°C.
- ❖ Proper curing is highly recommended while using as render, plaster, or screeds. It is also recommended to apply in layers if thick application is required.
- ❖ Ensure guidelines or recommendations for usage for each application are followed to the latest standards

HEALTH & SAFETY

For information and advice on the safe handling, storage and disposal of chemical products, users shall refer to the most recent Material Safety Data Sheet containing physical, ecological, toxicological and other safety-related data.

LEGAL NOTE

The information, and, in particular, the recommendations relating to the application and end-use of these products, are given in good faith based on current knowledge and experience of the products when properly stored, handled and applied under normal conditions in accordance to the manufacturer recommendations. In practice, the differences in materials, substrates and actual site conditions are such that no warranty in respect of merchantability or of fitness for a particular purpose, nor any liability arising out of any legal relationship whatsoever, can be inferred either from this information, or from any written recommendations, or from any other advice offered. The user of the product must test the product's suitability for the intended application and purpose. The manufacturer reserves the right to change the properties of its products. The proprietary rights of third parties must be observed. All orders are accepted subject to our current terms of sale and delivery. Users must always refer to the most recent issue of the local Product Data Sheet for the product concerned, copies of which will be supplied on request.