

STUCCO-FLEX +

Flexible acrylic based wall finish coat

One-component, flexible & elastic wall / ceiling finishing acrylic stucco. Specifically design to replace conventional skim coats. Water resistant, alkali resistant, cover and conceals cracks. It can be used as a system or on its own to replace conventional skimcoats.

FEATURES/BENEFITS

- ✓ Eco-friendly with Low VOC / Non-toxic formulation
- ✓ Water resistant
- ✓ Cover & Conceal cracks
- ✓ Enhanced durability
- ✓ Highly flexible
- ✓ Increase aesthetical value

APPLICATION AREAS

- ✓ Plasters
- ✓ Concrete
- ✓ Light weight block
- ✓ Decorative finishes
- ✓ Exterior/interior wall
- ✓ Replace conventional skim coats
- ✓ External facades
- ✓ Cement boards
- ✓ Acotek panels
- ✓ Gypsum boards
- ✓ Precast wall panel/joints



DRITECH CHEMICALS SDN BHD (1184082-K)

23-3A, Oval Damansara, 685, Jalan Damansara, 60000 Kuala Lumpur, Malaysia

TEL: +603 7735 6015, FAX: +603 7735 6016

Product Data

Appearances / Colors	White / Matt finish
Packaging	28kg & 5kg tub
Storage	12 Months from date of production
Storage Condition	Dry conditions at Temperature between 5-35 Degree Celsius

Technical Data

Origin	Acrylics
Specific Gravity	1.75 ± 0.05
Solid Content	~ 70% ± 2%
Coverage	0.8kg/m ²
Touch Dry	60minutes
Overcoat	24hours

System Build Up

Flexible & Smooth finish System

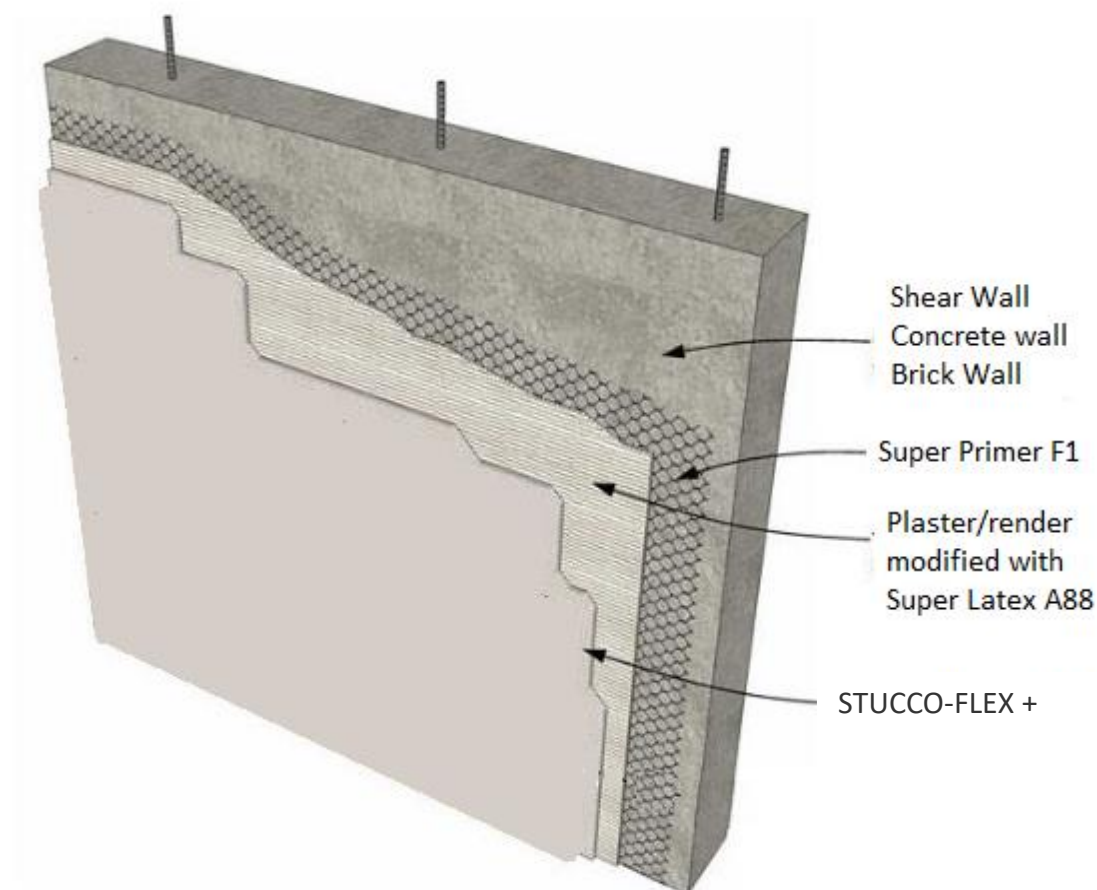

Steps	Descriptions
Substrate	Concrete, Dry-wall, Precast panel, bricks, light weigh blocks, etc
Primer	<i>SUPER PRIMER F1</i>
Plaster/Base Coat (Optional)	<i>Premix render / Site mix plaster with SUPER LATEX A88</i>
Finish	<i>STUCCO-FLEX +</i>

SUBSTRATE

New concrete should be cured for at least 28 days and should have a Pull off strength $\geq 1.5 \text{ N/mm}^2$. Cement or mineral based substrates must be prepared mechanically using abrasive blast cleaning or scarifying equipment to remove cement laitance and to achieve an open textured surface. Loose friable material and weak concrete must be completely removed.

STUCCOO-FLEX + is specifically designed for the following substrates:

- Concrete
- Light weight blocks
- Cement boards
- Gypsum boards
- Precast concrete panels
- Acotek panels, etc

APPLICATION

STUCCOO-FLEX + can be apply by trowel or spray.

TOOLS

Brush: With thick hair brush / Suitable spray machine. Clean with water

LIMITATIONS

- ❖ Ensure that temperature does not drop below 8°C and that relative humidity does not exceed 80%.

HEALTH & SAFETY

For information and advice on the safe handling, storage and disposal of chemical products, users shall refer to the most recent Material Safety Data Sheet containing physical, ecological, toxicological and other safety-related data.

LEGAL NOTE

The information, and, in particular, the recommendations relating to the application and end-use of these products, are given in good faith based on current knowledge and experience of the products when properly stored, handled and applied under normal conditions in accordance to the manufacturer recommendations. In practice, the differences in materials, substrates and actual site conditions are such that no warranty in respect of merchantability or of fitness for a particular purpose, nor any liability arising out of any legal relationship whatsoever, can be inferred either from this information, or from any written recommendations, or from any other advice offered. The user of the product must test the product's suitability for the intended application and purpose. The manufacturer reserves the right to change the properties of its products. The proprietary rights of third parties must be observed. All orders are accepted subject to our current terms of sale and delivery. Users must always refer to the most recent issue of the local Product Data Sheet for the product concerned, copies of which will be supplied on request.