

AC Centrifugal Blowers
MB Series

Impeller Diameter ϕ 50 mm



Operating Voltage Range: $\pm 10\%$ (Applies to each voltage)

Materials

- Motor Case: Die cast aluminum
- Casing: Die cast aluminum
- Impeller: Aluminum
- Overheat Protection: Impedance protected
- Bearings: Ball bearings

ϕ 50 mm

ϕ 60 mm

ϕ 80 mm

ϕ 100 mm

ϕ 120 mm

ϕ 160 mm

Specifications (RoHS)



Product Name	Voltage VAC	Frequency Hz	Current A	Input W	Speed r/min	Maximum Air Flow m ³ /min	Maximum Static Pressure Pa	Noise Level dB (A)
MB520-B	Single-Phase 100	50	0.11	8	2600	0.21	37	33
	Single-Phase 100	60	0.10	7	3000	0.24	53	37
	Single-Phase 110	60	0.11	8.5	3200	0.25	55	38
	Single-Phase 115	60	0.11	9	3200	0.25	55	38
MB520-D	Single-Phase 200	50	0.09	11	2650	0.22	38	33
	Single-Phase 200	60	0.08	10	3200	0.27	58	38
	Single-Phase 220	60	0.09	12	3300	0.27	60	38
	Single-Phase 230	50	0.10	16	2750	0.23	40	33
	Single-Phase 230	60	0.09	13	3300	0.27	60	38

● Safety standards → Page I-2

Product Line

Centrifugal Blowers

Product Name
MB520-B
MB520-D

The following items are included in each product.
Centrifugal Blower, Operating Manual

Fan Kit Products

Product Name
T-MB520-B-A
T-MB520-D-A

The following items are included in each kit.

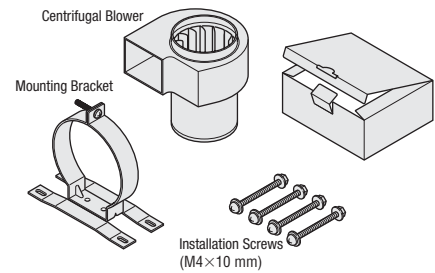

Air Flow – Static Pressure Characteristics

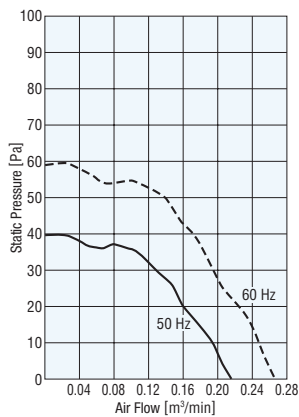

Dimensions (Unit mm)

Mass: 0.3 kg

CAD E064

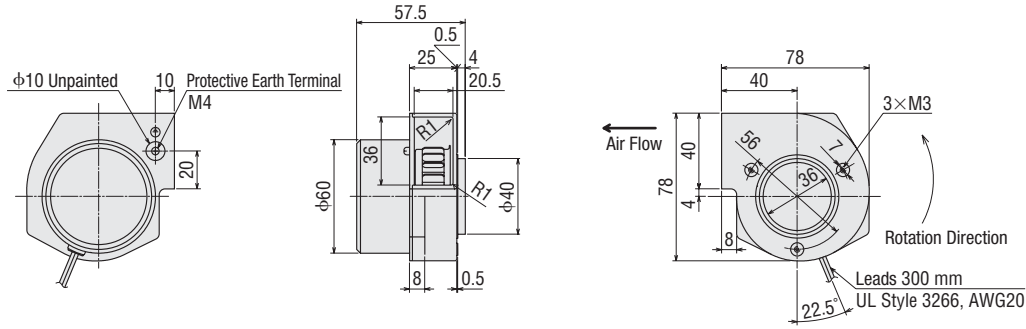

Panel Cut-Out (Unit mm)

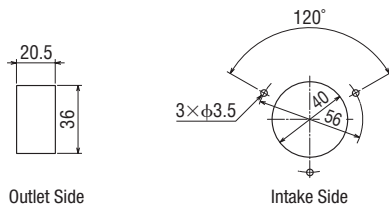

Connection Diagram

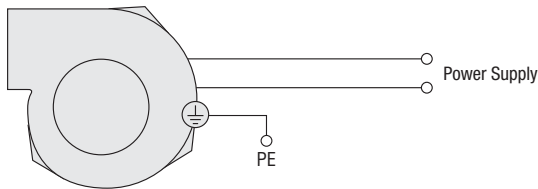

Accessory

Product	Product Name	Reference Page
Mounting Bracket	PAS2B	G-155

Thermostat

It automatically performs ON and OFF fan control in accordance with the temperature fluctuation inside the equipment. It helps improve the equipment's "environmental" performance relative to energy savings, noise reduction, etc.



RoHS

Thermostat **AM1-XA1**

● Reference page → Page G-141

Overview,
Product
Series

Axial Flow
Fans

AC Input
MU

AC Input
MRS

AC Input
Long-Life
MRE

DC Input
MDS
MD

DC Input
Low-Speed
Alarm
MDA

DC Input
Long-Life
MDE

Centrifugal
Blowers

AC Input
MB
DC Input
MBD

Cross Flow
Fans

AC Input
MF
DC Input
MPD

Cooling
Modules

Thermostat

Accessories

Installation

AC Centrifugal Blowers
MB Series

Impeller Diameter ϕ 60 mm



Operating Voltage Range: $\pm 10\%$ (Applies to each voltage)

Materials

Motor Case: Die cast aluminum

Casing: Die cast aluminum

Impeller: Aluminum

Overheat Protection: Impedance protected

Bearings: Ball bearings

ϕ 50 mm

ϕ 60 mm

ϕ 80 mm

ϕ 100 mm

ϕ 120 mm

ϕ 160 mm

Specifications (RoHS)



Product Name	Voltage VAC	Frequency Hz	Current A	Input W	Speed r/min	Maximum Air Flow m ³ /min	Maximum Static Pressure Pa	Noise Level dB (A)
MB630-B	Single-Phase 100	50	0.11	8.0	2300	0.44	53	37
	Single-Phase 100	60	0.11	8.0	1900	0.36	76	33
	Single-Phase 110	60	0.12	9.5	2300	0.45	77	38
	Single-Phase 115	60	0.12	10.0	2500	0.49	79	40
MB630-D	Single-Phase 200	50	0.08	12.0	2500	0.49	56	38
	Single-Phase 200	60	0.08	11.0	2600	0.50	83	39
	Single-Phase 220	60	0.08	13.0	2900	0.55	83	42
	Single-Phase 230	50	0.09	16.0	2600	0.50	56	39
	Single-Phase 230	60	0.08	14.0	2900	0.55	83	43

● Safety standards → Page I-2

Product Line

● Centrifugal Blowers

Product Name
MB630-B
MB630-D

The following items are included in each product.
Centrifugal Blower, Operating Manual

● Fan Kit Products

Product Name
T-MB630-B-A
T-MB630-D-A

The following items are included in each kit.

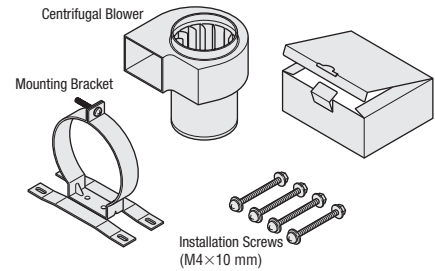

Air Flow – Static Pressure Characteristics

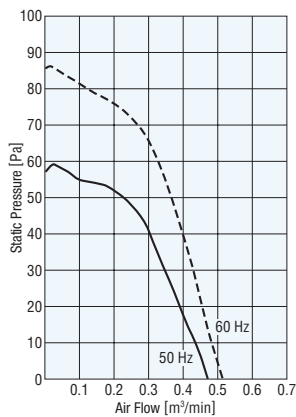

Dimensions (Unit mm)

Mass: 0.5 kg

CAD E063

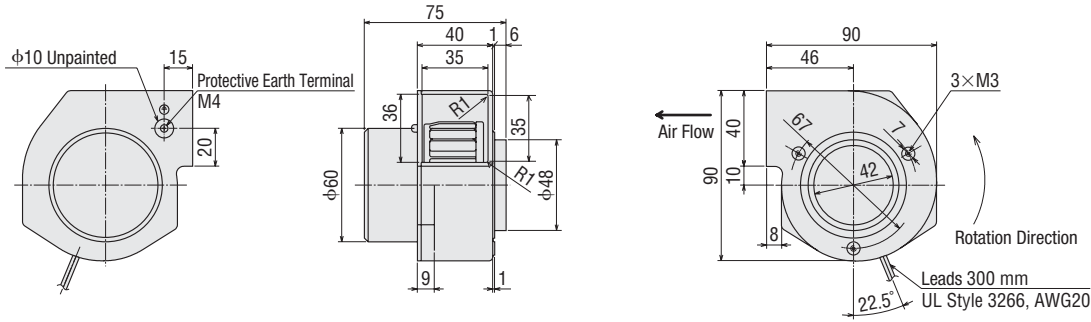

Panel Cut-Out (Unit mm)

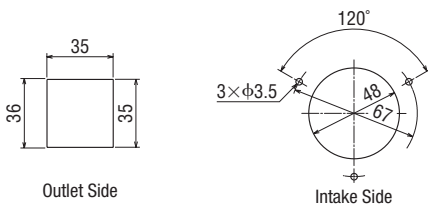

Connection Diagram

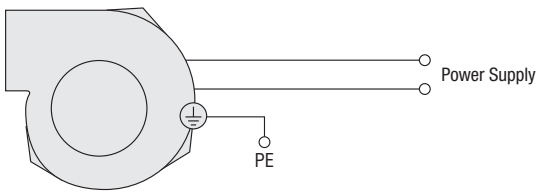

Accessory

Product	Product Name	Reference Page
Mounting Bracket	PAS2B	G-155

Thermostat

It automatically performs ON and OFF fan control in accordance with the temperature fluctuation inside the equipment. It helps improve the equipment's "environmental" performance relative to energy savings, noise reduction, etc.



RoHS

Thermostat **AM1-XA1**

Reference page → Page G-141

Overview,
Product
Series

Axial Flow
Fans

AC Input
MU

AC Input
MRS

AC Input
Long-Life
MRE

DC Input
MDS
MD

DC Input
Low-Speed
Alarm
MDA

DC Input
Long-Life
MDE

Centrifugal
Blowers

AC Input
MB
DC Input
MBD

Cross Flow
Fans

AC Input
MF
DC Input
MFD

Cooling
Modules

Thermostat

Accessories

Installation

AC Centrifugal Blowers
MB Series

Impeller Diameter ϕ 80 mm



Operating Voltage Range: $\pm 10\%$ (Applies to each voltage)
Materials
Motor Case: Die cast aluminum
Casing: Die cast aluminum
Impeller: Aluminum
Overheat Protection: Built-in thermal protector
Bearings: Ball bearings

ϕ 50 mm

ϕ 60 mm

ϕ 80 mm

ϕ 100 mm

ϕ 120 mm

ϕ 160 mm

Specifications



Product Name	Voltage VAC	Frequency Hz	Current A	Input W	Speed r/min	Maximum Air Flow m ³ /min	Maximum Static Pressure Pa	Noise Level dB (A)	Capacitor μ F
MB840-B	Single-Phase 100	50	0.29	28	2800	1.6	152	55	1.5
	Single-Phase 100	60	0.37	32	3150	1.8	221	58	
	Single-Phase 110	60	0.37	35	3300	1.8	226	59	
	Single-Phase 115	60	0.37	36	3350	1.8	226	59	
MB840-D	Single-Phase 200	50	0.14	28	2800	1.6	152	55	2.5
	Single-Phase 200	60	0.18	32	3200	1.8	221	58	
	Single-Phase 220	60	0.18	35	3350	1.8	226	59	
	Single-Phase 230	50	0.15	35	2850	1.6	157	55	
	Single-Phase 230	60	0.18	36	3350	1.8	226	59	
	Single-Phase 230	60	0.18	36	3350	1.8	226	59	
MB840-T	Three-Phase 200	50	0.12	25	2800	1.6	152	55	-
	Three-Phase 200	60	0.15	28	3200	1.8	221	58	
	Three-Phase 220	60	0.15	30	3350	1.8	226	59	
	Three-Phase 230	60	0.15	30	3350	1.8	226	59	

- The **MB840-T** types conforms to the UL and CSA Standards only.
- Safety standards → Page I-2

Product Line

Centrifugal Blowers

Product Name
MB840-B
MB840-D
MB840-T

The following items are included in each product.
Centrifugal Blower, Capacitor*,
Capacitor Cap*, Operating Manual
*Single-Phase Fans Only

Fan Kit Products

◇ With Finger Guard

Product Name
T-MB840-B-GA
T-MB840-D-GA
T-MB840-T-GA

- With Finger Guard, Mounting Bracket, Installation Screws

◇ With Filter

Product Name
T-MB840-B-FA
T-MB840-D-FA
T-MB840-T-FA

- With Filter, Mounting Bracket, Installation Screws

The following items are included in each kit.

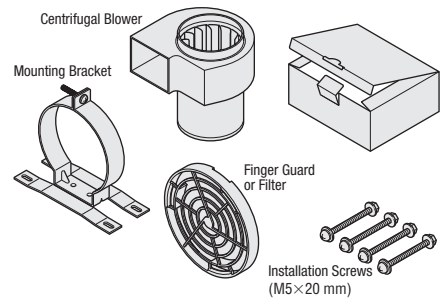

Air Flow – Static Pressure Characteristics

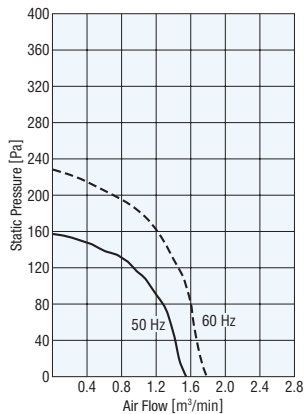

Dimensions (Unit mm)

Mass: 1.3 kg

CAD E062

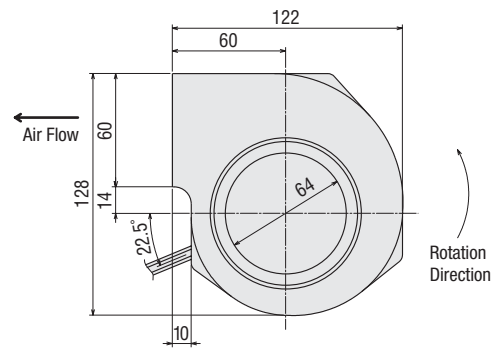
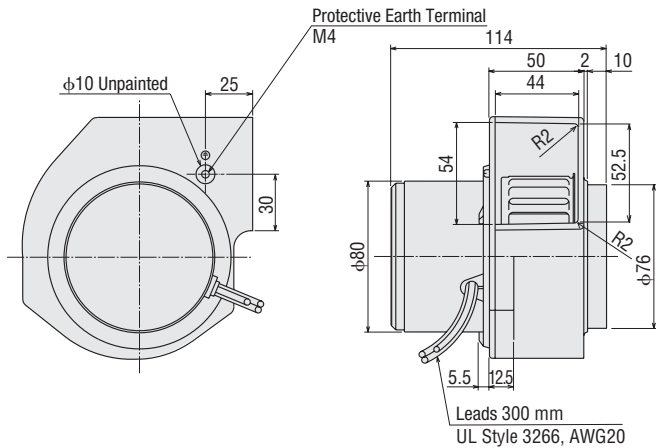

Capacitor (Included)

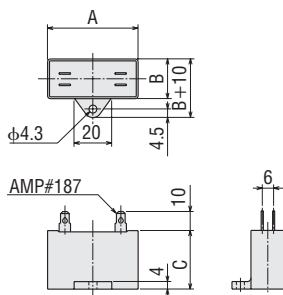

Capacitor Dimensions Table

Product Name	Capacitor Product Name	Capacitor Dimensions (mm)			Mass (g)	Capacitor Cap
		A	B	C		
MB840-B	CH15FAUL	31	14.5	23.5	35	Included
MB840-D	CH25FAUL	31	17	27	40	Included

Panel Cut-Out (Unit mm)

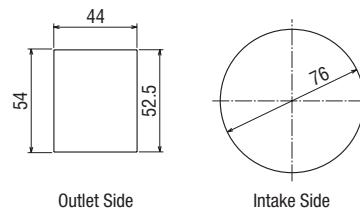

Connection Diagrams

MB840-B, MB840-D

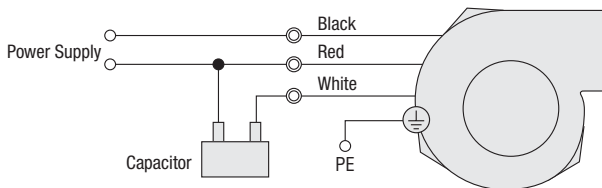

How to connect a capacitor → Page G-159

MB840-T

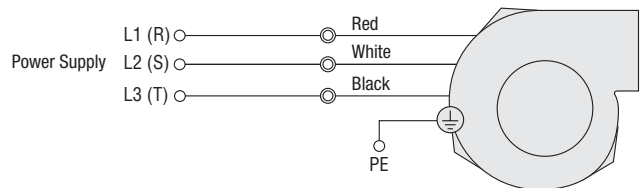

Accessories

Product	Product Name	Reference Page
Finger Guard	FGB8	G-146
Filter	FLB8	G-149
Mounting Bracket	PAS4B	G-155

Thermostat

It automatically performs ON and OFF fan control in accordance with the temperature fluctuation inside the equipment. It helps improve the equipment's "environmental" performance relative to energy savings, noise reduction, etc.



RoHS

Thermostat **AM1-XA1**

Reference page → Page G-141

Overview,
Product
Series

Axial Flow
Fans

AC Input
MU

AC Input
MRS

AC Input
Long-Life
MRE

DC Input
MDS
MD

DC Input
Low-Speed
Alarm
MDA

DC Input
Long-Life
MDE

Centrifugal
Blowers

AC Input
MB
DC Input
MBD

Cross Flow
Fans

AC Input
MF
DC Input
MGD

Cooling
Modules

Thermostat

Accessories

Installation

AC Centrifugal Blowers
MB Series

Impeller Diameter ϕ 100 mm



Operating Voltage Range: $\pm 10\%$ (Applies to each voltage)

Materials

Motor Case: Die cast aluminum

Casing: Die cast aluminum

Impeller: Aluminum

Overheat Protection: Built-in thermal protector

Bearings: Ball bearings

ϕ 50 mm

ϕ 60 mm

ϕ 80 mm

ϕ 100 mm

ϕ 120 mm

ϕ 160 mm

Specifications



Product Name	Voltage VAC	Frequency Hz	Current A	Input W	Speed r/min	Maximum Air Flow m ³ /min	Maximum Static Pressure Pa	Noise Level dB (A)	Capacitor μ F
MB1040-B	Single-Phase 100	50	0.50	45	2750	2.3	206	60	3.0
	Single-Phase 100	60	0.55	55	3050	2.6	284	63	
	Single-Phase 110	60	0.55	55	3200	2.6	284	64	
	Single-Phase 115	60	0.55	55	3200	2.6	284	64	
MB1040-D	Single-Phase 200	50	0.25	40	2750	2.3	206	61	1.2
	Single-Phase 200	60	0.30	50	3100	2.6	304	64	
	Single-Phase 220	60	0.30	55	3200	2.7	304	65	
	Single-Phase 230	50	0.30	50	2750	2.4	206	61	
	Single-Phase 230	60	0.30	55	3250	2.7	304	65	

● Safety standards → Page I-2

Product Line

● Centrifugal Blowers

Product Name
MB1040-B
MB1040-D

The following items are included in each product.
Centrifugal Blower, Capacitor*, Capacitor Cap*, Operating Manual
*Single-Phase Fans Only

● Fan Kit Products

◇ With Finger Guard

Product Name
T-MB1040-B-GA
T-MB1040-D-GA

● With Finger Guard, Mounting Bracket, Installation Screws

◇ With Filter

Product Name
T-MB1040-B-FA
T-MB1040-D-FA

● With Filter, Mounting Bracket, Installation Screws

The following items are included in each kit.

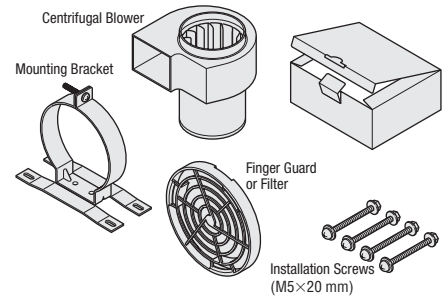

Air Flow – Static Pressure Characteristics

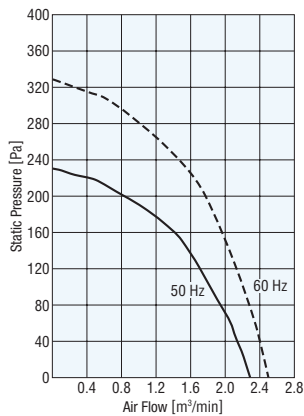

Dimensions (Unit mm)

Mass: 2 kg

CAD E027

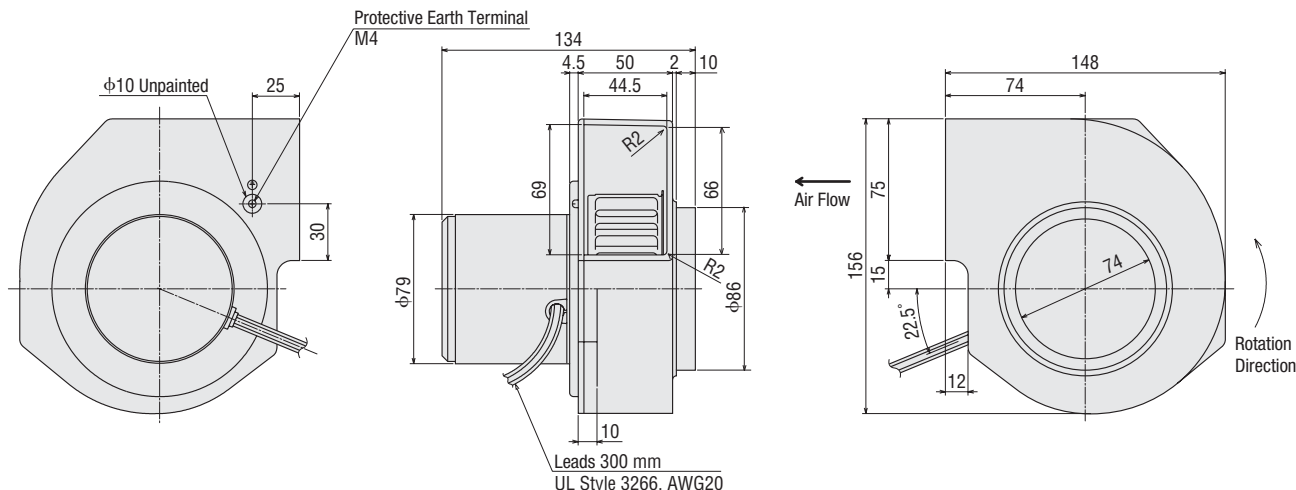

Capacitor (Included)

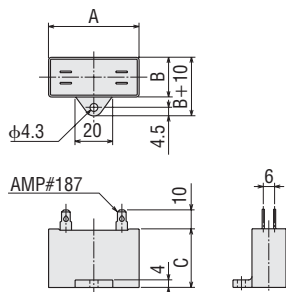

Panel Cut-Out (Unit mm)

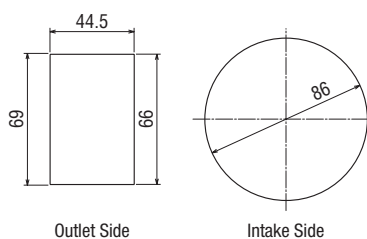

Capacitor Dimensions Table

Product Name	Capacitor Product Name	Capacitor Dimensions (mm)			Mass (g)	Capacitor Cap
		A	B	C		
MB1040-B	CH30BFAUL	58	21	31	50	Included
MB1040-D	CH12BFAUL	37	18	27	30	Included

Connection Diagram

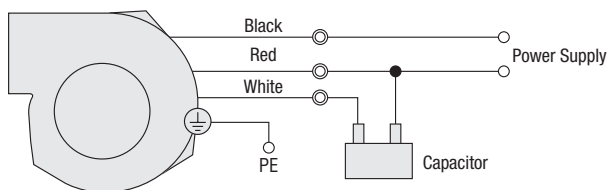

● How to connect a capacitor → Page G-159

Accessories

Product	Product Name	Reference Page
Finger Guard	FGB10	G-146
Filter	FLB10	G-149
Mounting Bracket	PAS4B	G-155

Thermostat

It automatically performs ON and OFF fan control in accordance with the temperature fluctuation inside the equipment. It helps improve the equipment's "environmental" performance relative to energy savings, noise reduction, etc.



RoHS

Thermostat **AM1-XA1**

● Reference page → Page G-141

AC Centrifugal Blowers
MB Series

Impeller Diameter ϕ 120 mm



Operating Voltage Range: $\pm 10\%$ (Applies to each voltage)
 Materials
 Motor Case: Die cast aluminum
 Casing: Die cast aluminum
 Impeller: Aluminum
 Overheat Protection: Built-in thermal protector
 Bearings: Ball bearings

ϕ 50 mm

ϕ 60 mm

ϕ 80 mm

ϕ 100 mm

ϕ 120 mm

ϕ 160 mm

Specifications **RoHS**



Product Name	Voltage VAC	Frequency Hz	Current A	Input W	Speed r/min	Maximum Air Flow m ³ /min	Maximum Static Pressure Pa	Noise Level dB (A)	Capacitor μ F
MB1255-B	Single-Phase 100	50	1.3	110	2850	4.4	309	67	10
	Single-Phase 100	60	1.6	150	3300	5.1	441	71	
	Single-Phase 110	60	1.6	150	3300	5.1	441	71	
	Single-Phase 115	60	1.6	150	3300	5.1	441	72	
MB1255-D	Single-Phase 200	50	0.6	100	2850	4.4	314	67	2.0
	Single-Phase 200	60	0.8	145	3200	4.9	451	69	
	Single-Phase 220	60	0.8	145	3300	5.1	451	71	
	Single-Phase 230	50	0.6	110	2900	4.5	314	67	
	Single-Phase 230	60	0.8	150	3300	5.2	451	71	
MB1255-T	Three-Phase 200	50	0.6	85	2850	4.4	314	67	-
	Three-Phase 200	60	0.6	120	3280	5.0	451	70	
	Three-Phase 220	60	0.65	125	3300	5.1	451	71	
	Three-Phase 230	60	0.65	130	3300	5.2	451	71	

- The **MB1255-T** type conforms to the UL and CSA Standards only.
- Safety standards → Page I-2

Product Line

Centrifugal Blowers

Product Name
MB1255-B
MB1255-D
MB1255-T

The following items are included in each product.
 Centrifugal Blower, Capacitor*, Capacitor Cap*, Operating Manual
 *Single-Phase Fans Only

Fan Kit Products

◇ With Finger Guard

Product Name
T-MB1255-B-GA
T-MB1255-D-GA
T-MB1255-T-GA

- With Finger Guard, Mounting Bracket, Installation Screws

◇ With Filter

Product Name
T-MB1255-B-FA
T-MB1255-D-FA
T-MB1255-T-FA

- With Filter, Mounting Bracket, Installation Screws

The following items are included in each kit.

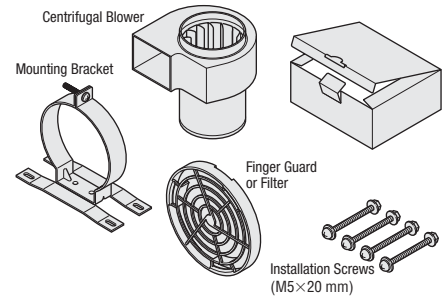

Air Flow – Static Pressure Characteristics

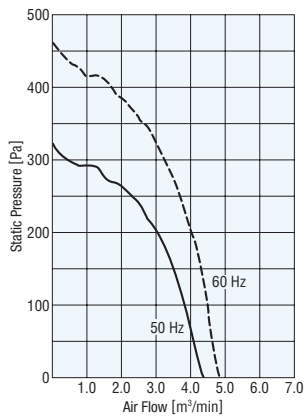

Dimensions (Unit mm)

Mass: 4 kg

CAD E060

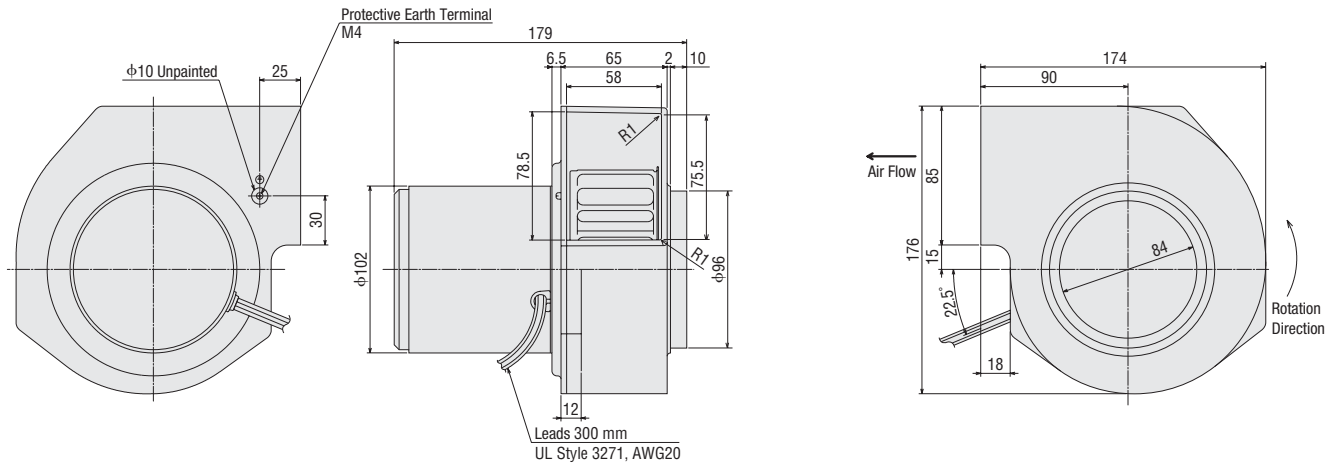

Capacitor (Included)

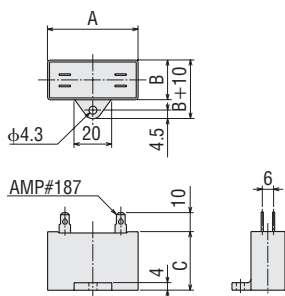

Capacitor Dimensions Table

Product Name	Capacitor Product Name	Capacitor Dimensions (mm)			Mass (g)	Capacitor Cap
		A	B	C		
MB1255-B	CH100CFAUL	48	22.5	31.5	40	Included
MB1255-D	CH20BFAUL	48	19	29	40	Included

Panel Cut-Out (Unit mm)

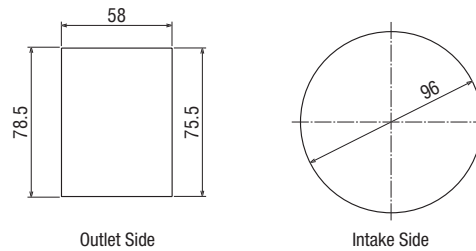

Connection Diagrams

MB1255-B, MB1255-D

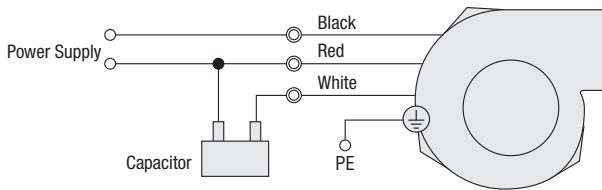

How to connect a capacitor → Page G-159

MB1255-T

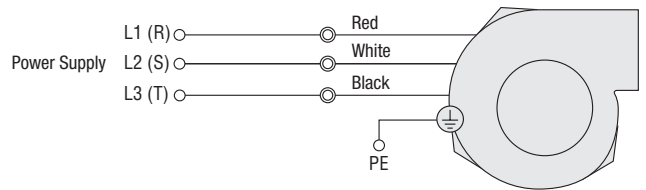

Accessories

Product	Product Name	Reference Page
Finger Guard	FGB12	G-146
Filter	FLB12	G-149
Mounting Bracket	PAS6A	G-155

Thermostat

It automatically performs ON and OFF fan control in accordance with the temperature fluctuation inside the equipment. It helps improve the equipment's "environmental" performance relative to energy savings, noise reduction, etc.



RoHS

Thermostat **AM1-XA1**

Reference page → Page G-141

Overview,
Product
Series

Axial Flow
Fans

AC Input
MU

AC Input
MRS

AC Input
Long-Life
MRE

DC Input
MDS
MD

DC Input
Low-Speed
Alarm
MDA

DC Input
Long-Life
MDE

Centrifugal
Blowers

AC Input
MB
DC Input
MBD

Cross Flow
Fans

AC Input
MF
DC Input
MFD

Cooling
Modules

Thermostat

Accessories

Installation

AC Centrifugal Blowers
MB Series

Impeller Diameter ϕ 160 mm



Operating Voltage Range: $\pm 10\%$ (Applies to each voltage)
 Materials
 Motor Case: Die cast aluminum
 Casing: Die cast aluminum
 Impeller: Aluminum
 Overheat Protection: Built-in thermal protector
 Bearings: Ball bearings

- ϕ 50 mm
- ϕ 60 mm
- ϕ 80 mm
- ϕ 100 mm
- ϕ 120 mm
- ϕ 160 mm



Specifications (RoHS)

Product Name	Voltage VAC	Frequency Hz	Current A	Input W	Speed r/min	Maximum Air Flow m ³ /min	Maximum Static Pressure Pa	Noise Level dB (A)	Capacitor μ F
MB1665-B	Single-Phase 100	50	2.6	260	2750	8.0	490	76	40
	Single-Phase 100	60	3.7	360	3100	9.0	686	80	
	Single-Phase 110	60	3.7	380	3200	9.0	686	80	
	Single-Phase 115	60	3.7	400	3200	9.0	686	80	
MB1665-D	Single-Phase 200	50	1.3	245	2700	7.7	490	75	8.0
	Single-Phase 200	60	1.8	340	3000	8.4	686	76	
	Single-Phase 220	60	1.8	360	3150	8.7	686	77	
	Single-Phase 230	50	1.3	270	2750	8.0	490	75	
	Single-Phase 230	60	1.8	370	3150	8.9	686	77	
MB1665-T	Three-Phase 200	50	1.8	280	2750	8.0	490	76	-
	Three-Phase 200	60	1.8	360	3100	9.0	686	80	
	Three-Phase 230	60	1.8	400	3200	9.0	686	80	

- The products above do not conform to Energy-related Products Directive which became effective in the EU on January 1, 2013. These products and the equipment using them cannot be exported to the EU member states. For details, please contact your nearest Oriental Motor sales office.
- Safety standards → Page I-2

Product Line

Centrifugal Blowers

Product Name
MB1665-B
MB1665-D
MB1665-T

Fan Kit Products

Product Name
T-MB1665-B-A
T-MB1665-D-A
T-MB1665-T-A

The following items are included in each product.
 Centrifugal Blower, Capacitor*, Capacitor Cap*, Operating Manual
 *Single-Phase Fans Only

The following items are included in each kit.

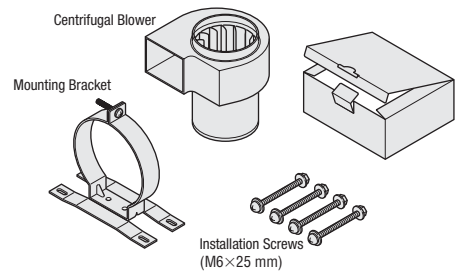

Air Flow – Static Pressure Characteristics

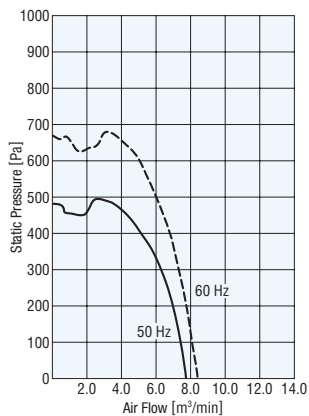

Dimensions (Unit mm)

Mass: 5 kg

CAD E059

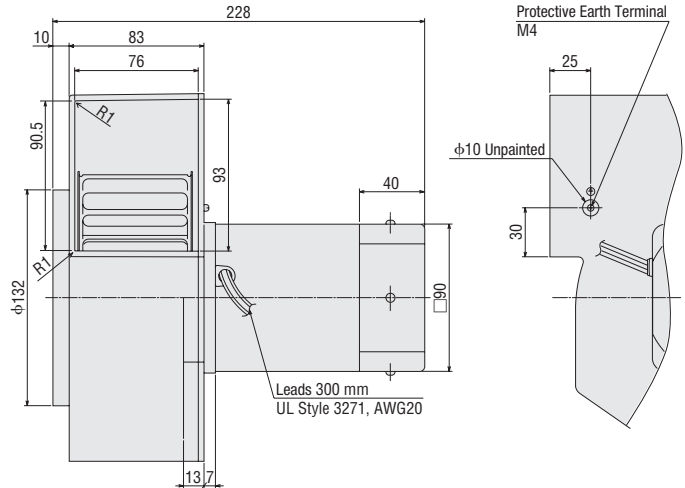
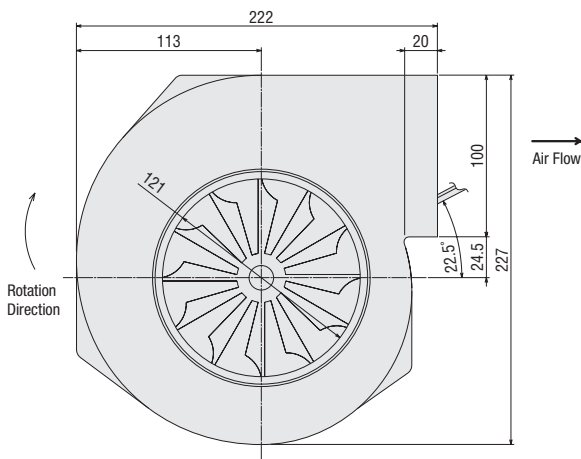

Capacitor (Included)

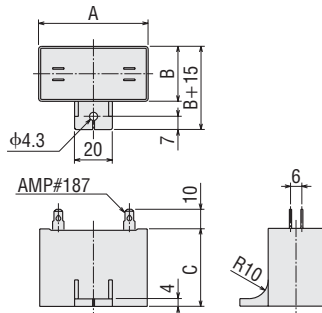

Panel Cut-Out (Unit mm)

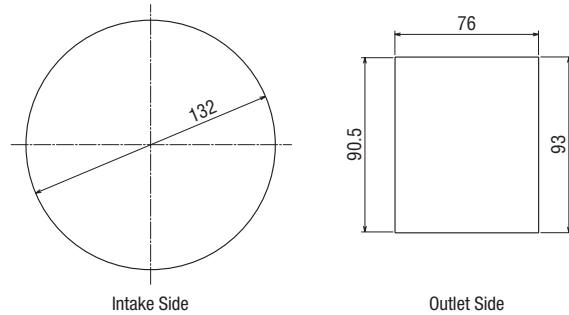

Capacitor Dimensions Table

Product Name	Capacitor Product Name	Capacitor Dimensions (mm)			Mass (g)	Capacitor Cap
		A	B	C		
MB1665-B	CH400CFAUL	58	41	58	190	Included
MB1665-D	CH80BFAUL	58	35	50	150	Included

Connection Diagrams

MB1665-B, MB1665-D

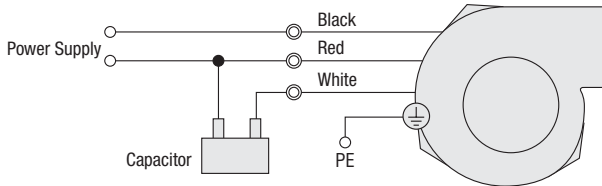

How to connect a capacitor → Page G-159

MB1665-T

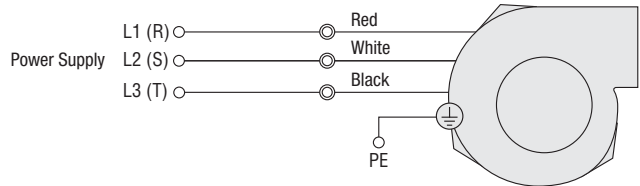

Accessory

Product	Product Name	Reference Page
Mounting Bracket	PAS5A	G-155

Thermostat

It automatically performs ON and OFF fan control in accordance with the temperature fluctuation inside the equipment. It helps improve the equipment's "environmental" performance relative to energy savings, noise reduction, etc.



RoHS

Thermostat **AMI-XA1**

Reference page → Page G-141

Overview, Product Series

Axial Flow Fans

AC Input **MU**

AC Input **MRS**

AC Input Long-Life **MRE**

DC Input **MDS**
MD

DC Input Low-Speed Alarm **MDA**

DC Input Long-Life **MDE**

Centrifugal Blowers

AC Input **MB**
DC Input **MBD**

Cross Flow Fans

AC Input **MF**
DC Input **MFD**

Cooling Modules

Thermostat

Accessories

Installation