

## ROTARY JOINT (FOR AIR) MONOFLOW



tel : 012-3868942 / 016-2285297 email : sales@lwgi.com.my website: www.lwgi.com.my

LWG INDUSTRIAL SDN BHD  
202301019617 (1513539-K)

### Operation Condition :

Size Range : 10A - 40A  
Type of Thread : BSPT  
Max Rotating Speed: 1000 RPM  
Max Pressure : 10 bar (150psi)  
Max Temperature : 90 °C

### Features :

- Low Torque & Triction
- Dry Friction
- Aluminium Housing
- Monoflow
- Graphite / Stainless Steel Seals

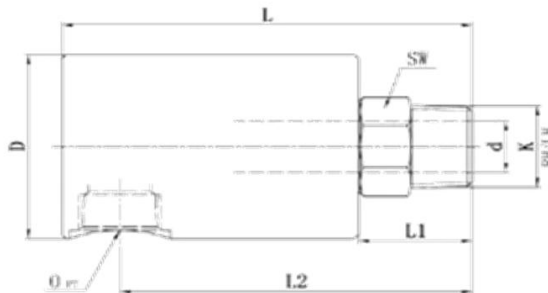

Model	K	O	D	d	L	L1	L2	SW
MXPHAMT-10A	3/8"	Rp3/8"	44	9	98	28	84	24
MXPHAMT-15A	1/2"	Rp1/2"	53	10	115	32	100	27
MXPHAMT-20A	3/4"	Rp3/4"	59	16	121	34	103	32
MXPHAMT-25A	1"	Rp1"	69	20	138	39	115	36
MXPHAMT-32A	1-1/4"	Rp1-1/4"	88	29	164	48	139	46
MXPHAMT-40A	1-1/2"	Rp1-1/2"	97	34	190	57	160	70

### Operation Condition :

Size Range : 10A - 40A  
Type of Thread : BSPT  
Max Rotating Speed: 2500 RPM  
Max Pressure : 10 bar (150psi)  
Max Temperature : 90 °C

### Features :

- Low Torque & Triction
- Dry Friction
- Aluminium Housing
- Monoflow
- Graphite / Stainless Steel Seals
- Applicable to high-speed

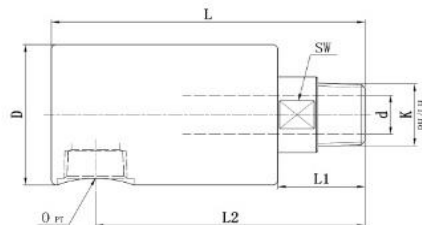

Model	K	O	D	d	L	L1	L2	SW
MXPHAMT-15A	1/2"	Rp1/2"	53	10	115	32	100	22
MXPHAMT-20A	3/4"	Rp3/4"	59	16	121	34	103	27
MXPHAMT-25A	1"	Rp1"	69	20	138	39	115	32
MXPHAMT-32A	1-1/4"	Rp1-1/4"	88	29	164	48	139	42
MXPHAMT-40A	1-1/2"	Rp1-1/2"	97	34	190	57	160	48

unit in mm