

Tiandy



TC-R3104 Spec: I/B/P4/C/Eu/L/S

H.265 1HDD 4ch PSE NVR

AK Series



KEY FEATURES

HD Input

- Plug and play
- S+265/H.265/H.264 video formats
- Connectable to the third-party network cameras
- Up to 4-channel input
- 4 PoE ports
- Supports live view, storage, and playback of the connected camera at up to 5MP resolution

HD Output

- 1×HDMI output
- HDMI Video output at up to 1080P resolution

HD Storage

- 1 SATA interfaces, up to 6TB for each HDD
- S+265 compression effectively reduces the storage space and costs by up to 75%

HD Transmission

- 1×RJ45 self-adaptive 10/100 Mbps network interface
- PoE Port: 4×RJ45 self-adaptive 10/100 Mbps network interfaces

Various Applications

- Centralized management of IP cameras, including configuration, information import/export, real-time information display, upgrade, etc.
- Connectable to smart IP cameras from Tiandy and the recording, playing back, and backing up
- Support plug-in-free browsing and can preview videos on all browsers
- Support cloud upgrade



SPECIFICATIONS

Input	
Video Input	4-ch
Max Resolution	5MP
Two-way Audio Input	N/A
Bandwidth	Income 60Mbps; Outgoing 40Mbps
Output	
HDMI/VGA Output	HDMI 1-ch, 1920×1080, 1440×900, 1366×768, 1280×800, 1280×720, 1024×768
Screen Split	1/3/4
Audio Output	N/A
Decoding	
Decoding Format	S+265/H.265/H.264
Recording Resolution	5MP/4MP/3MP/1080P/UXGA/720P/VGA/4CIF/DCIF/2CIF/CIF/QCIF
Preview Capability	5MP*1; 4MP*1; 3MP*1; 1080P*2; 720*5
Synchronous Playback	5MP*1; 4MP*1; 3MP*1; 1080P*2; 720*4
Hard Disk	
SATA	1 SATA interface for 1 HDD
Capacity	Up to 6TB for each HDD
eSATA Interface	N/A
Array Type	N/A
External Interface	
Network Interface	1×RJ45 self-adaptive 10/100 Mbps network interface
USB Interface	2×USB 2.0
Serial Interface	N/A
Alarm In/Out	N/A
Network	
Protocol	P2P, IPv4, IPv6, DHCP, DDNS, NTP, HTTP, SMTP, UPnP(Port Mapping), TCP, UDP, RTSP
System Compatibility	Onvif (PROFILE S/T), SDK, P2P
POE	
POE Interface	4×RJ45 self-adaptive 10/100 Mbps network interface
Power POE Port	The maximum output power per port is 28W , total output power is 28W
General	
Web	IE10+;Firefox52+;Edge89+;Safari11+;Chrome57+
Language	English,Thai
Operating Conditions	-10°C~ 55°C , 10%~90% RH
Power Supply	DC48V, 1A
Consumption (without HDD)	<10W (HDD not included, idling)
Chassis	1U
Dimensions	42.9×200×199.5mm, (1.69×7.87×7.85 inch)
Weight (without HDD)	0.4Kg (0.88lb)

Tiandy

DIMENSIONS (Unit: mm)

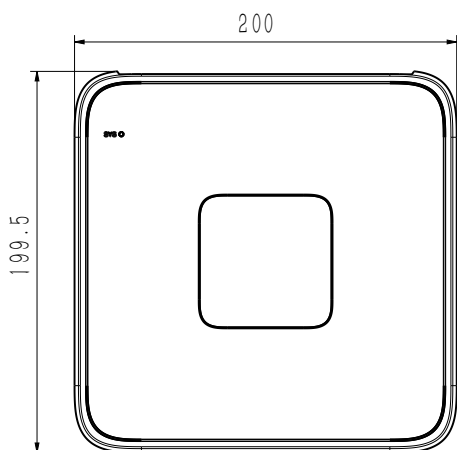
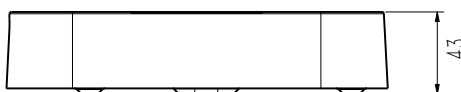
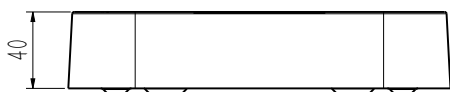

Physical Interfaces

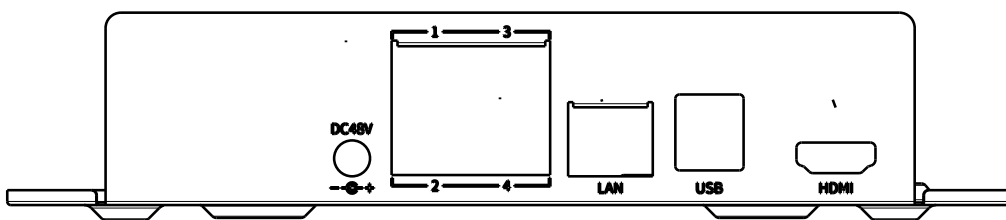

DISTRIBUTED BY



Tiandy Technologies Co.,Ltd.

Email: sales@tiandy.com

Tel: +86-22-58596178

Website: en.tiandy.com

Fax: +86-22-58596048