

Customer Care

Exact Quality Sdn. Bhd.
Contact: **03-6286 9000**
Website: **http://www.e-quality.com.my/**

OPERATION HOURS
08:30am - 06:00pm
(Monday - Friday, except public holiday)

Our Warranty

6yrs
Warranty

FOR HOOD MOTOR ONLY

18mths
Warranty

FOR ALL PARTS
(EXCLUDING ACCESSORIES)

1 yr
Warranty
Extension

**1-year
Warranty
Extensions
When Register
Online!**

Online Registration

1. Log on to www.rubine.com.my
2. Click on 'Support', followed by 'Products Warranty Registration' to proceed. You're required to sign up as a member.
3. Please fill up the necessary information, tick on the checkbox and click 'Next'.
4. You'll receive a notification of warranty registration confirmation via email.
5. Your warranty will be automatically extended for another 6 months upon registration online. Please keep your online warranty certificate for reference.

rubine.com.my



FIAMMA TRADING SDN BHD 330476-P (A member of Fiamma Holdings Berhad)
9-2, Wisma Fiamma, No.20, Jalan 7A/62A, Bandar Manjalara, 52200 Kuala Lumpur. Tel: 03-6279 8943

Rubine™

ITALIA

REDEFINE THE WAY OF LIFE



USER MANUAL

MODEL

RCH-LUSTRO-BL

SERIAL NO.

COOKER HOOD

WARRANTY CARD

WARRANTY CONDITIONS

Subject to following Term & Conditions, this equipment is guaranteed against defective material & manufacturing defects by Fiamma Trading Sdn Bhd for a period of twelve (12) months from the date of original purchase. Fiamma Trading Sdn Bhd reserves the right to change these terms & conditions without prior notice.

Terms & Conditions:-

- 1) This warranty is valid & provided that warranty card is completed with authorized dealer's stamp from the date of original purchase and in the territory of Malaysia only.
- 2) This warranty covers repair or, at the option of Fiamma Trading Sdn Bhd, replacement of any parts proven to be defective due to defective workmanship or material provided that the product was purchased from an authorized dealer of Fiamma Trading Sdn Bhd.
- 3) This warranty does not cover the damage resulting from:
 - (a) Any unauthorized disassembly, service repair, alteration or modification being carried out.
 - (b) Abnormal voltage or the use of generator and/or used not in accordance with the Operating Manual / User Manual.
 - (c) Misuse, abuse, negligence or accident howsoever caused.
 - (d) Normal wear or tear.
 - (e) Rough handling & transportation.
 - (f) Commercial / public use e.g. hotel, laundry, college, university, etc.
- 4) This warranty does not cover the following accessories:
 - (a) Burner Caps/Supports (b) Cast Iron Grib (c) Knobs (d) Body Work (e) Light Bulb (f) Charcoal / Filter (g) Cover (h) Glass Cover / Screen (i) Trays/Shelves (j) Hose
- 5) This warranty is considered null & void in the events if:
 - (a) Any item contained in this warranty card has been tempered with or altered in any way without the prior written consent of Fiamma Trading Sdn Bhd. Request for warranty services within the warranty period must be accompanied with this warranty card & proof of original purchase.
 - (b) Any time during the warranty period, any part / parts of this equipment is / are removed, altered, tempered with, adjusted, modified, dismantled, repaired or handled in any way whatsoever by any person / persons not authorized by us.
 - (c) The serial number of the product has been defaced or removed.
- 6) Warranty for WINE CHILLER compressor is (5) five years, gas refill and labor charges are excluded.
- 7) In the event of defects covered by this warranty arising during the warranty period, the purchaser shall be fully responsible for the due delivery to our dedicated service centre of the equipment (expect for the refrigerator, washing machine, ovens, cooker hood, gas cooker, dishwasher, dryer, built-in hob, freezer, water heater) for any work which shall need to be done pursuant to this warranty & subsequent collection thereof of the equipment after the said work has been done.
- 8) This warranty is in lieu of any, and all other warranties expressed or implied warranty of merchantability or fitness for a particular purpose. Fiamma Trading Sdn Bhd assumes no liability for the breach of the warranty beyond correcting the breath in the manner described above. In no event shall Fiamma Trading Sdn Bhd be liable for consequential losses or damages, including loss of use or loss of profits resulting from the product.

FOR OFFICE USE

Model Name

Serial No
Barcode :

Customer's Name (In Block/Full Name)

Date of Purchase : DAY MTH YR

Customer's Address (Full Address) :

PostCode : State :

Customer's Tel No : (H) - (O) -

Customer's Email : (H/P)

Authorised dealer's stamp

Fiamma Trading Sdn. Bhd.

Customer Signature

PRODUCT DIMENSION

RCH-LUSTRO-BL

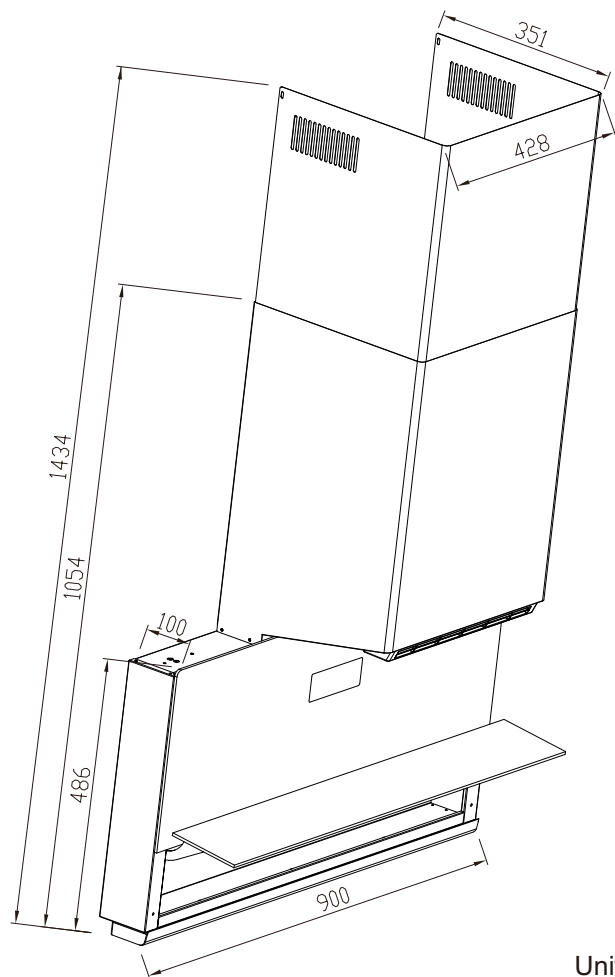

Unit(mm)

NOTICE

This product must not be disposed together with domestic waste. It has to be disposed at an authorized place for recycling of electrical and electronic appliances. By collecting and recycling waste, you help to save natural resources and make sure the product is disposed in an environmental friendly and healthy way.



Please read this instruction carefully. It is advisable to keep this instruction manual in a safe place for future reference.

SAFETY PRECAUTIONS

1. Keep electrical appliances out of reach from children. Do not let them to operate the appliances without supervision.
2. To protect against the risk of electrical shock, do not immerse the product, power cord or plug into water or any other liquid.
3. This product is for household and indoor use only.
4. This product is not intended for use by person (including children) with reduced physical, sensory or mental capabilities unless they have been given supervision or instruction concerning use of the appliance by a person responsible for their safety.
5. If the power cord or plug is damaged, it must be replaced by the service centre or a qualified service technician to avoid hazard.
6. Before installation, check if the mains supply voltage is matched with the voltage stated on the rating plate of the cooker hood.
7. There must be adequate air ventilation of the room when the cooker hood is used with the cooking appliances with burning gas or other fuels.
8. Ensure that the installation of exhaust complies with the standard of local building, gas and electrical authorities.
9. Do not ignite flames in the pans.
10. There is a risk of fire if cleaning is not carried out in accordance with this instruction.

ASSEMBLY INSTRUCTIONS

Please check the following before installation:

- Installation of cooker hood must be carried out by an authorized or qualified technician.
- Remove all packaging materials from the cooker hood. Check and make sure that the cooker hood is not damaged.
- Please ensure the power supply has switched OFF when installing the cooker hood.
- For optimum air extraction, avoid having too many windows surrounding the cooker hood which will cause air convection.
- The optimum height for the installation is between 650 to 750mm which is measured from the bottom of the cooker hood to the top of the hob.
- Make sure the hood is in level after installation to avoid oil spill over from the oil cup.

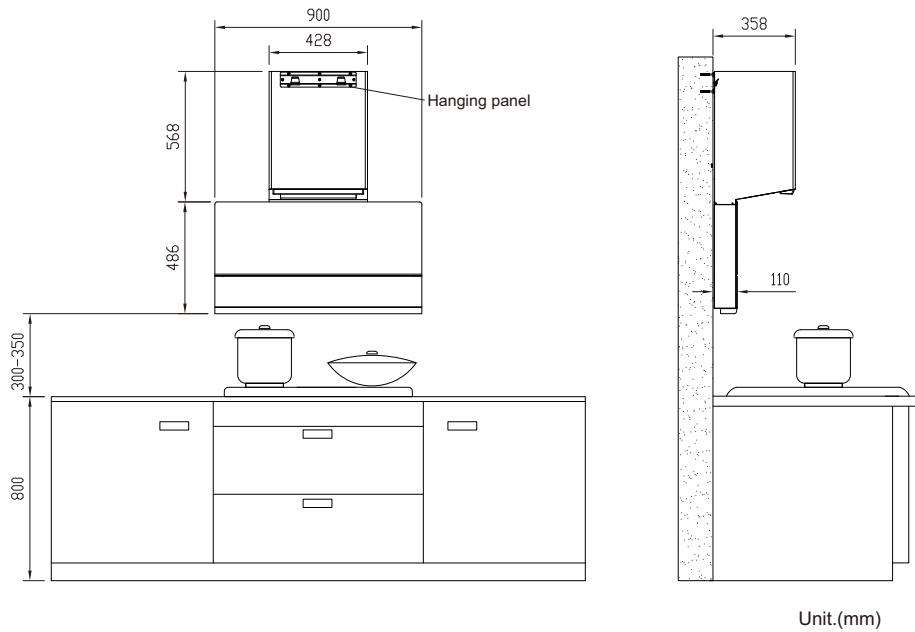

- Before installing, determine the height between the bottoms of the cooker hood to the top of the hob. Mark on the wall to suit the bracket locations.
- Drill holes with diameter of $\varnothing 8$ mm. Insert the screw anchors into the holes. Fix the mounting bracket and tighten the screws.

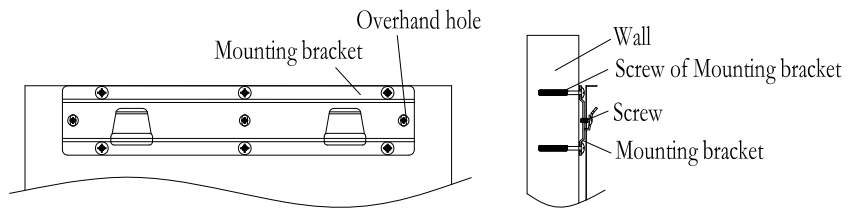

- Hang the cooker hood on the mounting bracket and make sure the cooker hood is in level.
- Fix the exhaust ducting on the cooker hood. Install the oil cup on the cooker hood.

TROUBLESHOOTING

Malfunctions	Possible Root Cause	Checking
Weak Suction	The distance is too far between the cooker hood and cooking appliance	Lower down the cooker hood installation height but within the safety guideline
	Strong convection due to too much ventilation	Shut off some of the windows or doors
Cooker hood and light not function	The power supply is not connected	Check if the plug is well connected and the power is on
	Power cord is damaged	Contact technicians for repair
Motor functions but light not works	Light bulb is damaged	Contact technicians to replace a new light bulb
Light works but motor not function	The bearing may be damaged	Contact technicians for repair
	The internal wires or motor capacitor may be burnout	
Vibration on the cooker hood	The screw is loosen	Tighten the screws
The cooker hood is noisy	Exhaust pipe surface is distorted	Contact technicians to reinstall the exhaust pipe

MAIN SPECIFICATION

Rated Voltage	: 220-240V/~50Hz
LED Light	: 3W x 1
Rated Power	: 240W
Product Dimension	: 900mm (W) x (1054-1434)mm (H) x 351mm (D)

PLASMA FUNCTION

1. The Plasma function is automatically turned on once there is a motor working (except for the heat cleaning state), and the other states are turned off.
2. The plasma function does not accept manual turned off.

VENTILATION FUNCTION

1. In the standby state, press and hold the **E** button for 3 seconds to activate the ventilation function.
2. The cooker hood will operate the ventilation function for 60 minutes.
3. The ventilation function will be turned on automatically 5 minutes after the motor finishes working. The motor will work at high speed for 5 minutes and stop for 15 minutes and with 3 cycles in total, and turn off the cooker hood upon completed.

CLEANING AND MAINTENANCE

- The cooker hood must always be disconnected from the electricity supply before carrying out any maintenance.
- Clean the cooker hood with damp cloth, hot water and mild detergent. Do not use chemical, steel, wooden or abrasive cleaners to clean the cooker hood.
- Remove the oil cup in horizontal direction, wash in hot soapy water, dry and fit back into the cooker hood. Do not use the cooker hood without the oil cup installed.
- Avoid spilling water into the motor and electronic component.

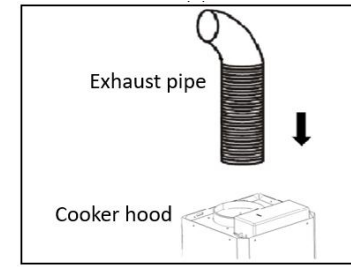

- Install the exhaust cover to the height required.
- Pull the upper exhaust cover upwards then install the fixing bracket to fix the exhaust cover position.
- Before connecting to the mains supply, ensure that the mains voltage corresponds to the voltage on the rating plate of the cooker hood.

INSTALL THE CHARCOAL FILTER

- Disconnect the power supply. Loosen the screws on the left and right sides of the top of the product. (Fig.1)
(Please do not open while the cooker hood is operate or connecting the power supply).

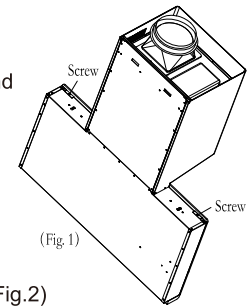

Pull out the large glass upwards and put it in a safe position. (Fig.2)

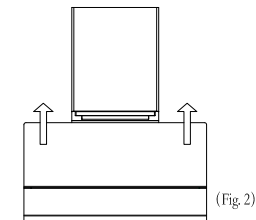

Insert the 2PCS carbon mesh into the slot of the carbon mesh, take the supplied tablet and lock it with screws to press the carbon mesh. (Fig.3)

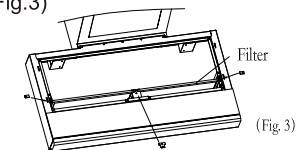

- Plug in the terminals of each lead.
- Secure the 2PCS screw on the top of the large glass of the product.

PRODUCT DESCRIPTIONS

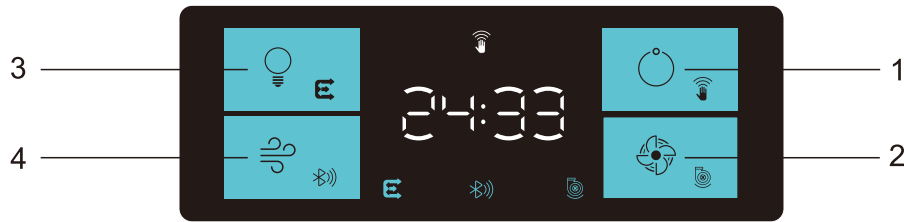

After plugging in the power-on self-test for 1 second, all indicator lights are off; touch any function key, and the 4 function keys light up in dark blue, the system enters the standby state.

When the gesture, linkage, ventilation, and heat cleaning functions are on, the corresponding button and icons light up; when functions are off, the corresponding button and icons light are off.

Instructions:

1. on /off/ somatosensory key: Touch this key in the standby state, the motor will turn on to the high speed state. When the motor is running, touch this key to enter a 1-minute-delay shutdown state, the indicator light flashes during the delaying. In the off state long press this key for 5 seconds to turn off the somatosensory function; long press again for 5 seconds to turn on the somatosensory function.

2. motor/Heat cleaning key: Touch this key when in the standby state, the motor will enter the high running state, multiple touches cycle in high running→stir frying→slow running; long press 3 seconds to stop the motor and return to the standby state. In the off state long press this key for 3 seconds to enter the heat cleaning function. **(Note: stir frying running time is 8 minutes)**

3. Light key/Ventilation key: In any state, touch this key to turn on the light. Touch this key again, the light will turn off. Press and hold this key for 3 seconds in the off state to enter the ventilation function.

4. Cooling function/Linkage key: In any state, touch this key to turn on the Cooling function. Press and hold this key for 2 seconds in the shutdown state to enter the linkage function. **(Note: The linkage function is only applicable to designated smart hobs).**

Gesture motion control: after power-on, wave from left to right to enter the high running state; LED light and small fan will turn on; multiple waves from left to right the motors run in the order of high speed→stir fry→low speed. Wave from right to left enter 1-minute-delay shutdown, wave again stop operation and turn off immediately.

(Tips: When using a somatosensory switch, please align your palm with the left and right sensing area! The ideally gesture motion speed from left to right or right to left shall within two seconds! The ideally distance of gesture motion from control panel is from 5-10CM!)

OPERATING INSTRUCTIONS

1. Press the button, the motor work at high speed, multiple touches of the button the motor cycle in high speed→stir frying→slow speed. Touch and press 3 seconds of the motor button can stop the motor.
2. When the motor is running, press the button to schedule one minute delay shutdown. Cooker hood will be turned off after one minute. Press button again during the delay off timer to turn off the cooker hood immediately.
3. Press the button to turn on the LED lamp. Press again to turn off. (This function does not relate to the cooker hood motor).

NOTE: When the cooker hood is operating, do not perform any of the maintenance or service the cooker hood. Avoid touching the inside of the cooker hood to avoid hazard.

HEAT CLEANING FUNCTION

1. In the standby state, press and hold the button for 3 seconds to activate the heat cleaning function.
2. The cooker hood will operate the heat cleaning function for 15 minutes.
3. The indicator light will keep blinking, heat cleaning process will start and run for 14 minutes. After that cooker hood will stop the heating and operate for final cool down.
4. The final cool down process will operate for 1 minute and updraft area will open. The cooker hood will be running in high fan speed for final cool down process and turn off the cooker hood upon completed.
5. Press and hold the button until deactivate the heat cleaning function or press the button to deactivate this function.

NOTE: During the heat cleaning process, only LED Light/Heat Cleaning button and ON/OFF button can be functional.