

# MEDIUM PRESSURE CHECK VALVES

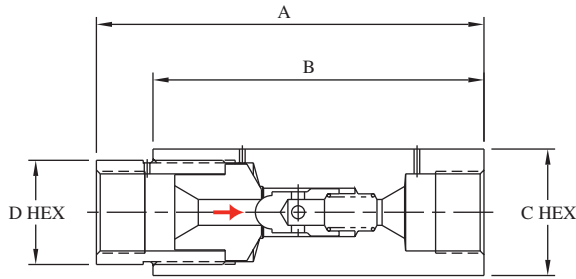

BuTech ball check valves prevent reverse flow where leak-tight shutoff is not necessary. Standard materials of construction are 316 stainless steel with 17-4PH poppet for longer life, and 300 series stainless steel spring.

Note: For 316ss wetted parts, add **-316WP** to the catalog number.

Cracking pressure: 15 PSI (1 bar) approximate

Operating Temperature Range:

-420° to +1200°F

(-251° to +648°C)

## BALL CHECK VALVES

Catalog Number	Connection	MAWP	Cv	A	B	C	D
20BC4	1/4" M/P Tube	20,000 PSI 1380 bar	0.25	2.93" (74.4)	2.50" (63.5)	1.00" (25.4)	0.88" (22.4)
20BC6	3/8" M/P Tube	20,000 PSI 1380 bar	0.80	3.13" (79.5)	2.62" (66.5)	1.12" (28.4)	0.88" (22.4)
20BC9	9/16" M/P Tube	20,000 PSI 1380 bar	2.30	4.22" (107.2)	3.50" (88.9)	1.38" (35.1)	1.38" (35.1)
20BC12	3/4" M/P Tube	20,000 PSI 1380 bar	3.40	5.94" (150.9)	4.75" (120.7)	1.75" (44.5)	1.38" (35.1)
20BC16	1" M/P Tube	20,000 PSI 1380 bar	5.20	6.50" (165.1)	5.55" (141.0)	2.12" (53.8)	1.75" (44.5)

To order a valve with a cracking pressure other than the standard 15 PSI, add the cracking pressure to the end of the catalog number. Example: A 20BC9 with 50 PSI cracking pressure would be ordered as **20BC9-50**.

Cracking pressures available up to 100 PSI (7 bar)

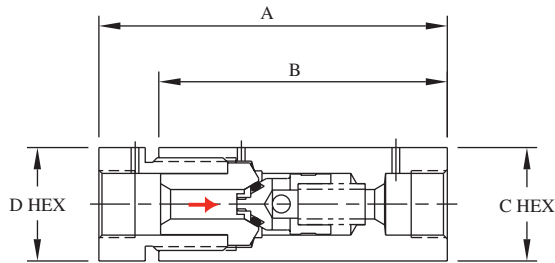

BuTech o-ring check valves reliably prevent backflow where leak-tight shutoff for liquids or gases is required. Standard materials of construction are 316 stainless steel with Buna-N o-ring and 300 series stainless steel spring.

Cracking pressure: 15 PSI (1 bar) approximate

Operating Temperature Ranges:

O-ring Material	Operating Temperature Range	Catalog Suffix
Buna-N	-65° to +250°F (-54° to +121°C)	----
Viton	-40° to +500°F (-40° to +260°C)	-VA
Teflon	-320° to +400°F (-195° to +204°C)	-TFE
Kalrez	-20° to +550°F (-29° to +288°C)	-HT

## O-RING CHECK VALVES

Catalog Number	Connection	MAWP	Cv	A	B	C	D
20SC4	1/4" M/P Tube	20,000 PSI 1380 bar	0.25	2.94" (74.7)	2.50" (63.5)	1.00" (25.4)	0.88" (22.4)
20SC6	3/8" M/P Tube	20,000 PSI 1380 bar	0.80	3.12" (79.2)	2.62" (66.5)	1.12" (28.4)	0.88" (22.4)
20SC9	9/16" M/P Tube	20,000 PSI 1380 bar	2.30	4.23" (107.4)	3.50" (88.9)	1.38" (35.1)	1.38" (35.1)
20SC12	3/4" M/P Tube	20,000 PSI 1380 bar	3.40	5.89" (149.6)	4.75" (120.7)	1.75" (44.5)	1.38" (35.1)
20SC16	1" M/P Tube	20,000 PSI 1380 bar	7.40	6.50" (165.1)	5.55" (141.0)	2.12" (53.8)	1.75" (44.5)

To order a valve with a cracking pressure other than the standard 15 PSI, add the cracking pressure to the end of the catalog number. Example: A 20SC4 with 40 PSI cracking pressure would be ordered as **20SC4-40**.

Cracking pressures available up to 100 PSI (7 bar)

All dimensions are for reference only and are subject to change.  
Dimensions in parentheses are millimeters (mm)

