

## LED SOLAR WALL LIGHT

### APPLICATION

- Parking Areas, Gardens, Billboard, Facade Lightings, Commercial and Residential Areas.

### FEATURES

- Easy To Install and Wiring Free.
- 3 Modes Light Program Selected.
- All In One Unit (LED Wall Light + Solar Panel).
- Operating Temperature -10° C ~ 40° C.
- Simple and Light Weight Design.

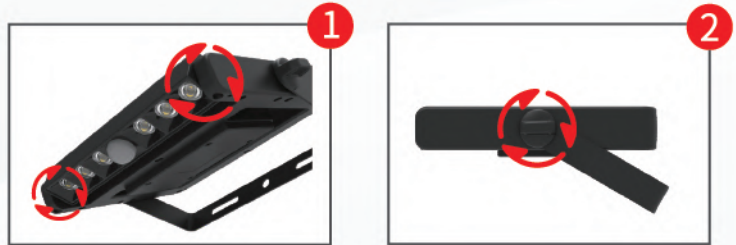

WALL LIGHT

MODEL	POWER (W)	CCT (KT)	LUMEN (LM)	Size DxH (LxHxW)	NET WEIGHT	PACKING
-------	-----------	----------	------------	------------------	------------	---------

### PIR SENSOR

BSSLFL-60	60W	6500	500	477x365x362mm	0.34kg	60/CTN
BSSLFL-150	150W	6500	1000	585x410x370mm	0.75kg	20/CTN
BSSLFL-250	250W	6500	13500	585x410x318mm	1.08kg	10/CTN

### RGB COLOR

BSSLFL-60/RGB	60W	Red,Green,Blue	500	477x365x362mm	0.34kg	60/CTN
---------------	-----	----------------	-----	---------------	--------	--------

### 3 COLOR MODE CHANGEABLE

BSSLFL-150/3C	150W	3000/6500	400	585x410x370mm	0.75kg	20/CTN
BSSLFL-250/3C	250W	3000/6500	600	585x410x318mm	1.08kg	10/CTN

