

GY-450 型高效能無聲震動過瀘機

使用說明書

Instructions for Use of GY-450 Noiseless High-efficiency Vibrator and Screening Machine



GY-450S



GY-450SA

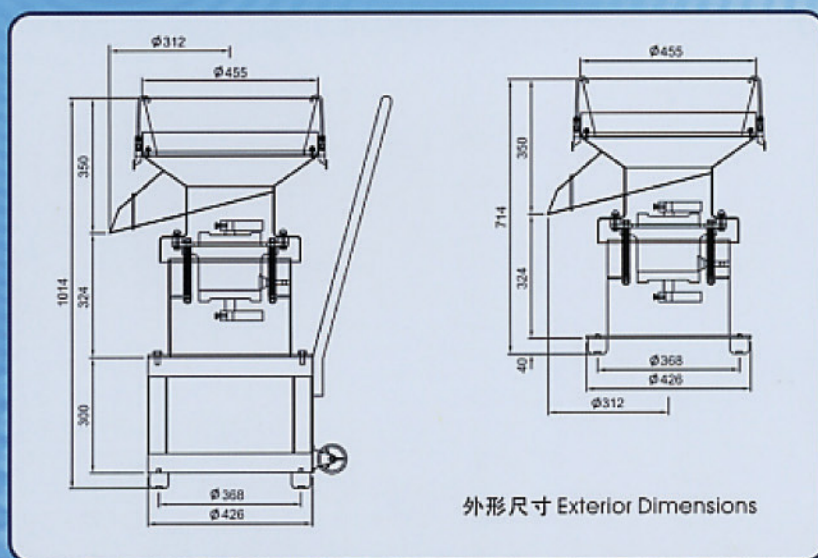

外形尺寸 Exterior Dimensions



通過ISO9001: 2000國際質量體系認證

GY-450 型高效能無聲震動過瀘機

GY-450 Noiseless High-efficiency Vibrator and Screening Machine

一、適用行業：本產品適用於食品、制藥、化工、陶瓷、粉末冶金、塑料、橡膠、研磨、污水處理.....等行業。
Applications: This machine can be used in making foodstuffs, medicine, chemicals, ceramic tiles, powdered metals, plastics and rubber as well as in abrasives and pollution treatment.

二、特性 Special features:

※參數 Reference figures:

馬力 Motor (HP)	電壓 Power (VAC)	頻率 Frequency (Hz)	轉速 Speed (RPM)	篩面有效直徑 Effective interface (mm)	允許最大給料粒度 Maximum particle size (mm)	處理能力 Capacity (tons/hr)	淨重 Net wt. (Kg)
1/2	220/380/415	50	1440	400	10~15	0.1~0.25	44 (帶架 On pallet) 59

(處理能力以60目篩分面粉為參考)

三、零組件對照 Comparison of Parts and Assemblies:

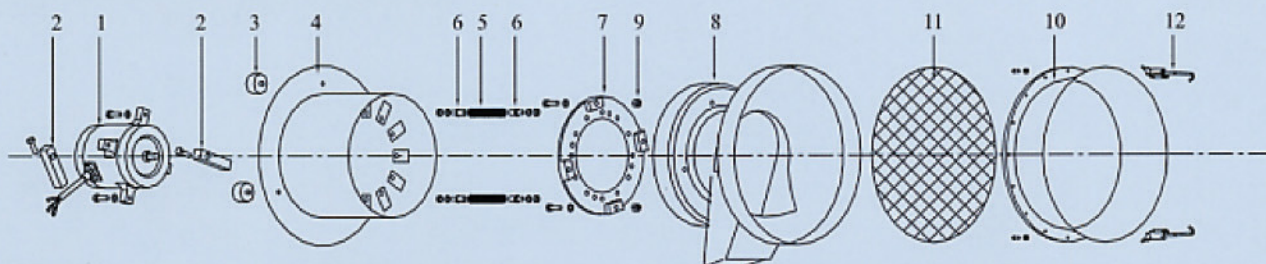

項次 Item	品名規格 Part name and specification	數量 Number	備注 Note	項次 Item	品名規格 Part name and specification	數量 Number	備注 Note
1	電機 Machine	1		7	機座 Machine base	1	SS41
2	震動塊 Vibrator plate	2	SS41	8	出料斗 Output Funnel	1	SUS304
3	底座 Base plate	1	SS41	9	組合式蓋形螺母 Compound capped bolt and nut	4	SUS304
4	避震膠墊 Plastic anti-vibration arm	3	NR	10	篩盆 Screen Pan	1	SUS304
5	壓縮彈簧 Compressed spring	12	琴鋼 Piano wire	11	篩網 Screen	1	SUS304
6	壓縮彈簧固定座 Compressed spring holder base	24	POM	12	拉鉤 Pull Port	3	SUS304

四、注意事項 Please note the following:

- ※ 檢查您所訂購的形式和規格是否相符，所配電源與銘牌標識是否一致（電壓誤差±10%）；
- ※ 檢查緊固部份有否鬆動？電源開關（不可用閘刀開關）及接地線安裝是否保證接觸良好？嚴禁電機缺相運轉；
- ※ 電機引出線在底座內側必須餘留60mm的伸縮量、保證機器震動時引線不被拉斷；
- ※ 本機應放置在與四周最小保持500mm距離的地方，且機臺安裝平穩、可靠；
- ※ 本產品出廠時已設定上、下平衡塊順時針呈45°夾角（固定上部，旋轉下部平衡塊至45°），若使用效果不佳，可參考工作原理自行調節，調整後鎖緊平衡塊緊固螺絲；
- ※ 不使用时要切斷電源、清洗時嚴禁用水衝洗電機、以防漏電；
- ※ 要保持篩網清潔、可根據過濾物質不同、采用相應清洗劑、同時篩面嚴禁用尖硬物體碰撞；
- ※ 本產品正常使用條件下保固期為一年，在保固期內，使用中若發生異常，請立即停機檢查并及時與本公司聯系，切勿自行拆卸。

- * Please check the models and specifications in your order to ensure that they are appropriate to your needs and that the power source is proper (±10% of the power indicated on manufacturer's tag on the machine base).
- * Check all connections and fittings to ensure that they are snug. Ensure the power switch is appropriate (do not use a knife switch) and that it is securely connected.
- * Lines leading into the machine should have at least 60mm of flexibility to ensure that they will not break or become uncoupled due to vibration of the machine.
- * Leave at least 500mm of space on all sides of the machine when installing.
- * This machine left the factory in fully set-up condition, with the upper and lower parallel ramps set at 45°. If the machine does not operate smoothly at this setting you can consider making appropriate adjustments using the set screws at the back of the machine.
- * Disconnect the power source when the machine is not in use for a long period of time. Do not spray the machine with a hose to clean it to avoid electrical shock.
- * Keep the screens clean at all times. Various cleaning agents may be used depending on the type of material being sifted. Do not use a sharp object to scrape any part of the machine.
- * This machine is guaranteed for one year under normal operating conditions. Should any unusual noise occur during this one-year warranty, stop the machine and contact us immediately. Do not attempt to make repairs or replacements yourself.