

INSTRUCTION FOR USE

CONTRO 45 INSECT LIGHT TRAP

CONTRO 30 INSECT LIGHT TRAP



Smarter Choice for Pest Free Environment

For more information please visit

WWW.PESTLINE.COM.MY

FB: www.facebook.com/pestline.com.my/

CONTRO 45 & CONTRO 30 INSECT LIGHT TRAP

Set-up and Operation

PRECAUTIONS

- **MUST ONLY BE USED IN AREAS WHICH ARE FREE OF DUST AND ANY POSSIBLE EXPLOSIVE VAPOR/GASES MIXTURE.**
- **DESIGNED FOR INDOOR USE ONLY AND IS NOT SUITABLE FOR USE IN BARNES, STABLES AND SIMILAR LOCATIONS.**
- **POSITIONING THE UV LIGHT AT MINIMUM 15 FEET'S AWAY FROM PROLONGED EXPOSURE HUMAN. THE UV LAMP GENERATES ULTRAVIOLET IN THE UV-A REGION AT 370NM WAVELENGTH, WHICH CAN BE HARMFUL TO HUMAN, AVOID PROLONGED EXPOSURE AT CLOSE PROXIMITY.**
- **ENSURE THE UNIT IS PROPERLY EARTHED, ENSURE PROPER ELECTRICAL WORK DURING THE INSTALLATION.**

Guarantee

Your CONTRO 45 & CONTRO 30 is guaranteed for three years, excluding tubes. If a fault occurs within twelve months the manufacturer will replace your unit. This guarantee only applies if genuine spare parts are used. Tubes are not guaranteed.

Choosing Correct Insect Light Trap

- CONTRO 45 for coverage 150m² for flying insect control (house fly, *Musca domestica*)
- CONTRO 30 for coverage 80m² for flying insect control (house fly, *Musca domestica*)

Positioning

- **DO NOT** install the device direct above food preparation areas.
- Keep the device **1.5 meters** away from food preparation, packaging, tableware.
- The height of Insect Light Trap should ideally be fixed at least six (6) feet above ground, maximum is nine (9) feet.
- Preferably in the darkest place within the area to be protected, away from windows and skylights, thus avoiding any competition with natural daylight or sunlight.
- In large open areas where two or more units are required, positioning needs careful consideration to ensure maximum protection. Each unit within a certain area should be centrally positioned.
- Remember that light travels in straight lines so any barriers, suspended canopies or any other large objects may block the UV, makes it necessary to install a greater number of units in order to achieve optimum effectiveness. As a general rule, the UV (ultraviolet) light from the unit should be visible from every part of the room.

Power Requirements

- Designed to operate 24 hours from the following power supply: 220 - 240V, 50 - 60Hz
- Ensure that your unit is compatible with the electricity supply on your premises.
- Make sure the unit is connected to an earthed electrical supply via a socket outlet of compatible rating.

Installation Requirements

Small / Midsize Hammer drill machine, extension cable for electrical supply, tools for electrical work, three Core flexible wire, PVC wire casing, wire organizer & etc...

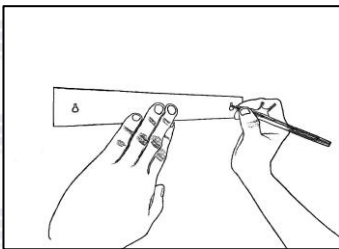

- 1)
Marking drill points

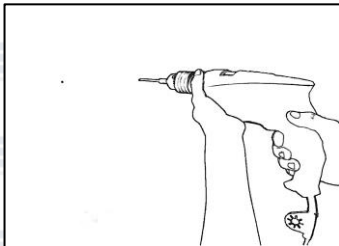

- 2)
Drill the pilot holes
straight into the wall

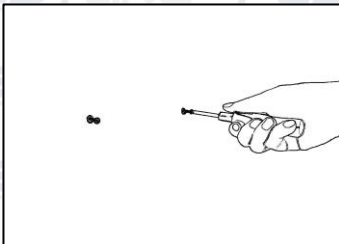

- 3)
Insert the plugs into the
pilot holes and twist in
the screws

- 4) Fix the CONTRO 45 / 30 by insert
keyhole mounting in the screw

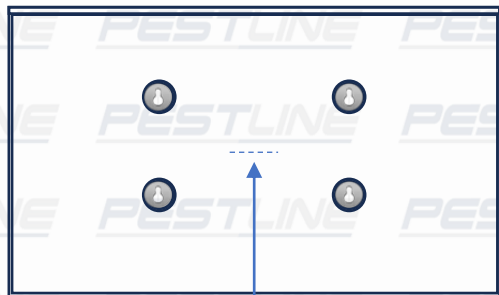

fixed at least six (6)
feet above ground,
maximum is nine (9)
feet.

Ground

Servicing Your Flying Insect Control Unit

- Before any form of servicing, ensure that the unit is disconnected from the main power supply.
- To maintain the unit's efficiency, replace the high-powered UV Tubes every 12 months, making sure the replacement tubes are of the correct type - obtainable from your supplier.
- Cleaning - cleaning should be done at regular intervals, depending upon the environment in which the unit operates, normally its monthly basic
 1. First (after disconnecting from main power supply) open the stainless-steel front cover, use built in hinges to hold the cover in open position
 2. Second remove the bottom tray and then remove the old sticky glue pad by pulling it downward.
(The position of the glue board must be kept in a tray/U shape to prevent flying insect falling outside from the glue board.)
- **PUT THE STICKY PAD DIRECTLY INTO A PLASTIC BAG IMMEDIATELY, AVOID THE UN-HYGIENE FLYING INSECT DEAD BODY EXPOSES.**
- Clean the unit with a hygiene wet wipes/damp cloth, replace a new sticky pad, place the cover back to the position.
- The exterior of the unit should be cleaned with a hygiene wet wipe paper/damp cloth, removing the normal dirt and grease found in most operating conditions. All metal used in the construction is either stainless steel or powder coated steel and should therefore remain in good condition for many years, if not subjected to extreme conditions.

1. First (after disconnecting from main power supply) open the stainless-steel front cover



2. Use built in hinges to hold the cover in open position
3. Second remove the bottom tray and then remove the old sticky glue pad by pulling it downward.
(The position of the glue board must be kept in a tray/U shape to prevent flying insect falling outside from the glue board.)

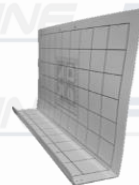

Tube Replacement

- Check the UV output by using a UV meter, change the bulb if the output could not meet the requirement.
- Before replacing the tubes, always ensure that the unit is disconnected from the main power supply. The power supply is isolated by a safety switch.
- Turn rotates the bulb movement on 90 degrees in either direction until two clicks are heard
- Withdraw by sliding them out from the lamp holder and **PUT IT DIRECTLY INTO A PLASTIC BAG, AVOID THE UN-HYGIENE FLYING INSECT DEAD BODY EXPOSES.**
- Reverse the process to fit the new tube.

Return to CONTROL Series Insect Light Trap article.

Disclaimer Electronic

Technical Specification		CONTRO 45	CONTRO 30
Electrical	:	Input Voltage 220 - 240V	
Height x Width x Depth	:	500 mm x 295 mm x 75 mm	
Weight	:	5.4 Kgs	4.5 Kgs
Replacement Glue Boards	:	Fly Sticky Pad Pro-Guard / Fly Sticky Pad Type 2	
Control Gear	:	Magnetic Ballast 15W x 3 units	Magnetic Ballast 30 W x 1 unit
UV Bulb	:	Insect BL TL-D 15W (T8) x 3 units	Insect BL TL-D 15W (T8) x 2 units
UV Bulb for Food Facilities		Shatter-proof Insect BL TL-D 15W (T8) x 3 units	Shatter-proof Insect BL TL-D 15W (T8) x 2 units
Efficacy Coverage Area	:	150 m2	100 M2
Flexible Cable	:	Three Core Flexible Wire 40/0076	
PVC Insulated Wire	:	Size 1/029 100% pure copper	
Starter	:	S 10 x 3 units	S 2 x 2 units
Plug Top	:	250 v 10amp	

The electrical system is similar as our commercial lighting fixtures. We only use high quality component to ensure performance, durability and reliability.

Warranty: Three 3 years (UV bulb excluded)

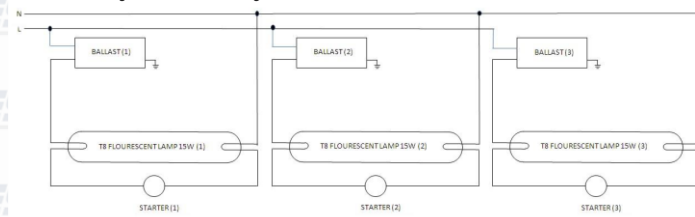

CONTRO 45

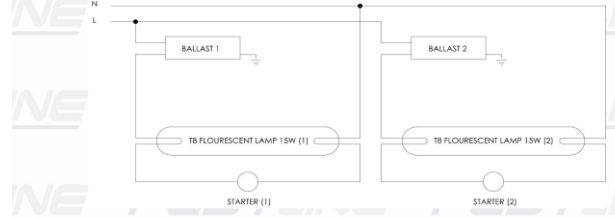

CONTRO 30

Pestline CONTRO 45 Insect Light Trap

NOTES

Our Location

Factory, Head Office

No: 6 & 8, Jalan Ekoperniagaan 1/16, Taman Ekoperniagaan,
81100 Johor Bahru, Johor Malaysia

SELANGOR BRANCH (Central Regional)

10, Jalan TPK 1/3, Taman Perindustrian Kinrara,
47100 Puchong, Selangor, Malaysia

Contact us at:

PESTLINE MANUFACTURING SDN BHD

PESTLINE SDN BHD

Office Hours : 8.30 am - 5.30 pm (Monday to Friday)

Tel : +607 562 5151 (OFFICE)

Fax : +607 562 6119

Email : inquiry@pestline.com.my

Website : www.pestline.com.my

100% Made in MALAYSIA

Since Years 2011