

# DN 35 KVA FOOT PEDAL SPOT WELDER



<b>Quick Specs</b>	<b>Typical Usage :-</b>	<b>Processes : Spot Welding</b>
	<ul style="list-style-type: none"> <li>*Steel</li> <li>*Stainless Steel</li> <li>*Zinc</li> <li>* For Medium Industrial</li> </ul>	<b>Specification :-</b> Rated Input Voltage : 415 V Frequency : 50-60 Hz Rated Duty Cycle : 20% Welding Current : 19000A Rated Input Capacity : 35 KVA
		Max.Electrode Force : 400KG Electrode Stroke : 0-60MM Qt.Of Cooling Water : 5 L/Min Weight (Approximate) : 140KG Dimension: 810x400x1147 MM (LxWxH)

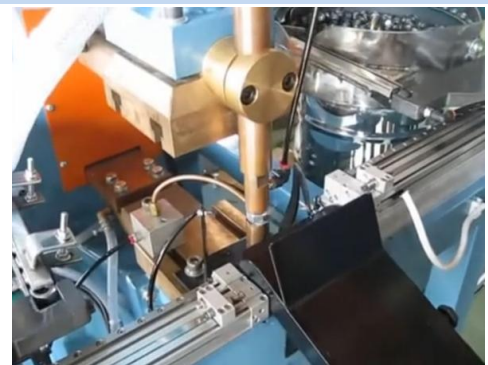
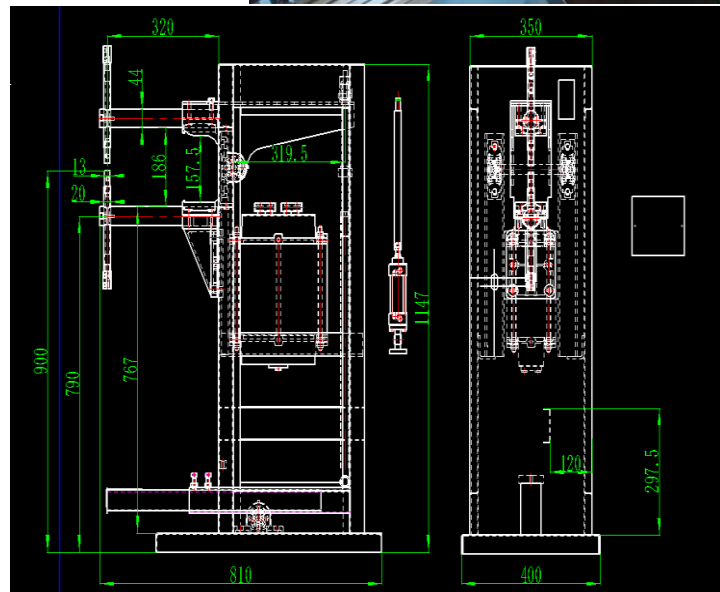

Diagram:



**Advantage :**

- \*Good working performance through thyristor controlled circuit eliminating contractors.
- \*Power saving though usage of high quality conductive material and superior secondary circuit, and efficient after cooling circuit.
- \* Lower exhaust noise through unique construction.
- \* Safe usage through high insulation techniques.

\* Long serviceable life (1 year warranty)

Manufactured by :

**WELDING INDUSTRIES (M) SDN BHD**

Sole Distributor:

**LONGLIFE WELD SDN BHD**



**TOTAL WELDING SOLUTIONS**