

MJ | STEEL DOOR



About Us



Our company is one of the pioneer companies established in year 2004 which specialized in manufacturing, assembling and steel fabrication works.

Our Factory & Facilities Overview

We have our very own manufacturing arm located at the Kulim Industrial Estate in Kedah, featuring a total factory area of 240,000 square feet — with 120,000 square feet dedicated solely to sheet metal production facilities.

Over the years, with our dedicated workforce and strong presence in the industry, we have successfully catered to the diverse needs of our customers. Our steel door products are among the highest quality available in Malaysia, offered at affordable and competitive prices.

In 2009, we received ISO 9001 certification from LRQA, as well as a Product Certification License from SIRIM in recognition of our product standards. In 2016, we were also awarded BOMBA certification for our fire-rated doors.



Production Floor

Our production floor is equipped with advanced machinery and streamlined processes, ensuring consistent quality, efficiency, and precision in every steel door.

MJ Facilities/Machines

Laser

- Amada FO-3015NT
- LFK FLC3000-3015FS
- LFK FLC6000-4015F

Bending

- LVD CPB100/30
- Durma HAP 40200
- Durma HAP 30160
- AMADA RGM2-804
- LFK NBP110-40-LT15i-5C-AP

Hot Press Machine

- Tiege MH-3848x120 T-A
- Harsle HS-100T

Powder Coating Line

- EISENMANN, Germany

Spray Wet Painting Line

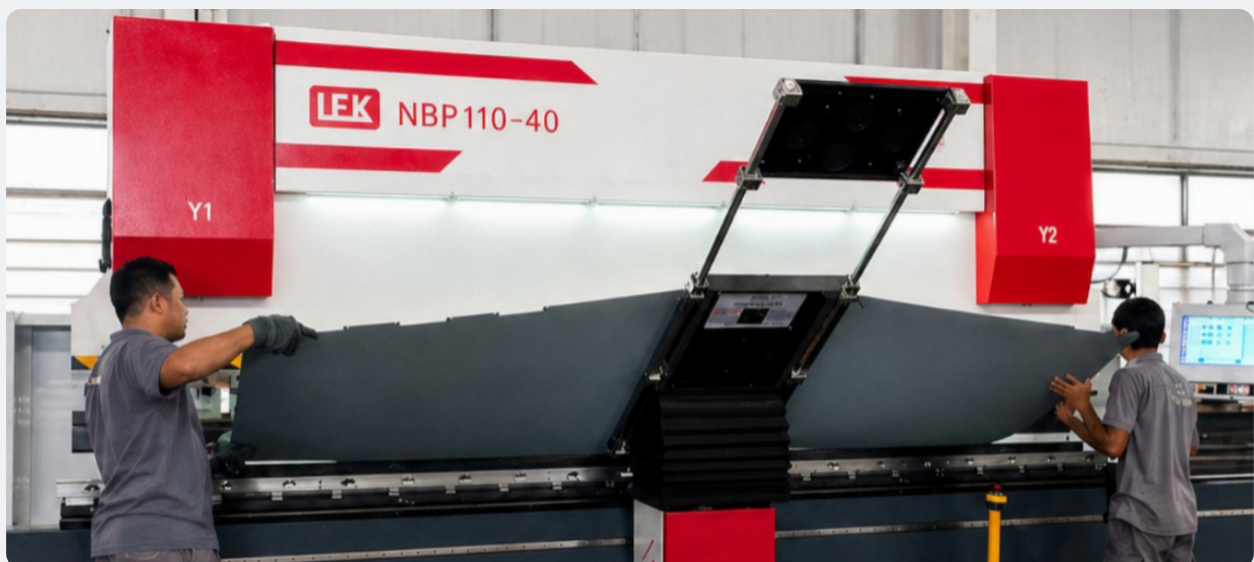
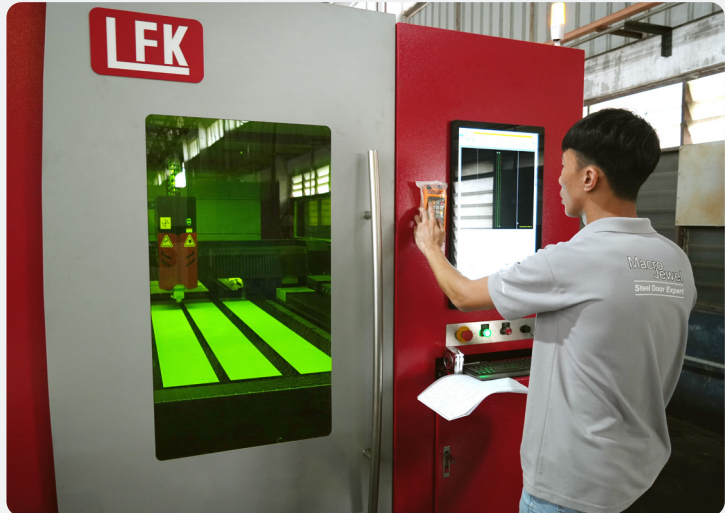

Actual Product Showcase



**2-hours Fire-rated Steel Door
c/w Vision Panel (Single Leaf)**



**2-hours Fire-rated Steel Door
c/w Vision Panel (Double Leaf)**



2-hours Fire-rated Steel Door (Single Leaf)



2-hours Fire-rated Steel Door (Double Leaf)



**Non Fire-rated Steel Door
c/w Vision Panel (Single Leaf)**



**Non Fire-rated Steel Door
c/w Vision Panel (Double Leaf)**

Actual Product Showcase



Non Fire-rated Steel Door (Single Leaf)



Non Fire-rated Steel Door (Double Leaf)



Swing Steel Door (Unequal Double Leaf)



Swing Steel Door (Louvers)



Swing Steel Door (Security Mesh)



Swing Stainless Steel Door

Actual Product Showcase



Wood Laminated Swing Steel Door



Laminated Swing Steel Door



Powder Coated Swing Steel Door



Powder Coated Swing Steel Door



Sliding Steel Door (Single Leaf)



Sliding Steel Door (Double Leaf)

Actual Product Showcase



Folding Steel Door
(4 Leaf - Fully Open Configuration)



Folding Steel Door
(4 Leaf - Fully Close Configuration)



Folding Steel Door
(8 Leaf - Fully Open Configuration)



Folding Steel Door
(8 Leaf - Fully Close Configuration)



Industrial Gate



Industrial Gate

Fire Rated Steel Door

Engineered to comply with Malaysian fire safety standards and relevant regulatory requirements, our fire-rated steel door delivers reliable fire protection, structural integrity, and long-term durability. The system incorporates robust steel construction, precision-engineered components, and certified hardware to ensure consistent performance in critical applications.



Features

- Fire-rated door leaf with tested core construction
- High-strength butt hinges for fire-rated performance
- Anti-panic mortise lock with deadbolt for emergency egress
- Self-closing mechanism compatibility
- Intumescent seal to prevent smoke and heat penetration
- Approx. weight: 35 kg/m²
- Available in single or double leaf configuration
- Custom sizes available

SPECIFICATION

Fire Rating:	Up to 2 hours (120 Minutes)
Test Standard:	MS 1073: Parts 3:1996(Amd 1:2003)
Frame:	Electro-galvanized steel 1.5mm thickness
Panel Core:	Insulation material with steel framing
Panel Thickness:	52mm (with capping)
Face Sheet:	Electro-galvanized steel 0.8mm thickness
Hinges:	SUS 304 KABA / DORMAKABA
Mortise Lockset/ Lever Handle/ Cylinder and Door Closer:	KABA / DORMAKABA
Door Selector:	MJ
Auto Flush Bolt:	MJ
Finishing:	Nippon PCB primer T.S. grey.
Vision Panel (Optional) :	Clear fire rated glass, available in sizes: - 150mm (W) × 300mm (H), 100mm (W) × 600mm (H)

FRAME PROFILE

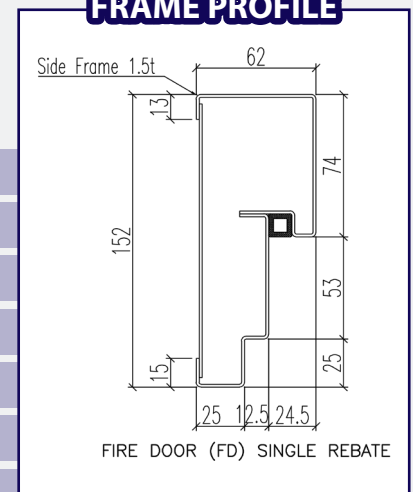

Non Fire Rated Door

SWING STEEL DOOR

Designed for general applications, our non-fire rated steel door combines durability, functionality, and cost efficiency. Featuring a reinforced steel structure with a lightweight core, the system ensures reliable performance and smooth operation, making it suitable for a wide range of commercial and industrial environments.



Features

- Durable electro-galvanized steel construction
- Reinforced internal structure for added strength
- Lightweight panel with honeycomb or polystyrene core
- Smooth and stable door operation
- Durable flag hinges allowing easy door removal and servicing
- Approx. weight: 25 kg/m²
- Available in single or double leaf configuration
- Custom sizes and design options available

SPECIFICATION

Frame:	Electro-galvanized steel 1.5mm thickness
Panel Core:	Honeycomb paper / Polystyrene
Panel Thickness:	42mm (with capping)
Face Sheet:	Electro-galvanized steel 0.8mm thickness
Hinges:	MJ Brand
Mortise Lockset/ Lever Handle/ Cylinder and Door Closer:	HOSO brand
Finishing:	Nippon PCB primer T.S. grey.
Louvers:	Custom sizes available
Vision Panel (Optional) :	Custom sizes available

FRAME PROFILE

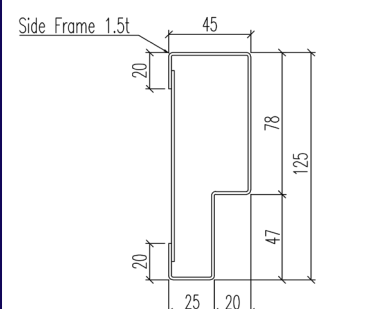

STEEL DOOR (SD) SINGLE REBATE

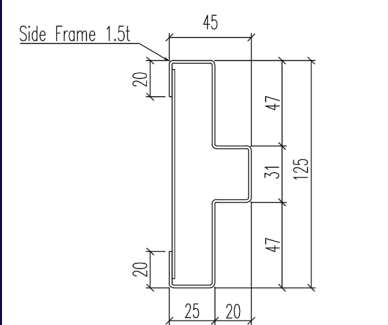

STEEL DOOR (SD) DOUBLE REBATE

Non Fire Rated Door

SLIDING STEEL DOOR

The door operates on a top-mounted sliding track, delivering smooth and controlled horizontal movement. Upon closing, the panel aligns securely within the frame. Engineered for durability and space efficiency, the system features a heavy-duty sliding mechanism and bottom guide to ensure stable, reliable performance.



Features

- Smooth and effortless sliding operation
- Anti-jump / anti-derailment track system
- Space-saving design (no swing clearance required)
- Quiet track and roller system
- Heavy-duty sliding mechanism for durability
- Bottom guide for stable movement
- Robust steel construction for long-lasting performance
- Custom sizes and configurations available

SPECIFICATION

Type of Slide:	Single leaf / Double leaf
Frame:	Electro-galvanized steel 1.5mm thickness and above
Panel Core:	Honeycomb Paper / Polystyrene
Panel Thickness:	42mm and above (with capping)
Face Sheet:	Electro-galvanized steel 0.8mm thickness and above
Finishing:	Nippon PCB Primer T.S. Grey
Vision Panel (Optional) :	Custom sizes available

Non Fire Rated Door

FOLDING STEEL DOOR (4-8 LEAF)

Our folding steel door system is designed to maximize clear opening while minimizing space usage. The multi-leaf panels fold neatly to the side, providing flexible access for wide openings. Engineered for durability and smooth operation, the system incorporates a robust track, high-quality rollers, and reinforced steel construction, making it suitable for industrial and commercial applications.



Features

- Multi-leaf folding system for wide opening access
- Space-saving design with minimal side clearance required
- Smooth operation with high-quality rollers and track system
- Heavy-duty hanger and bracket system for durability
- Reinforced steel panels for structural strength
- Stable and reliable folding mechanism
- Suitable for large openings in industrial and commercial applications
- Custom sizes and configurations available

SPECIFICATION

Door leaf:	4 to 8 leaf panels
Frame:	Electro-galvanized steel 1.5mm thickness and above
Panel Core:	Honeycomb Paper / Polystyrene
Panel Thickness:	42mm and above (with capping)
Face Sheet:	Electro-galvanized steel 0.8mm thickness and above
Finishing:	Nippon PCB Primer T.S. Grey
Vision Panel (Optional) :	Custom sizes available

Our Certification



Construction Industry
Development Board (CIDB)
Grade G7



LRQA Certified
ISO 9001:2015



SIRIM Malaysia
**Steel Fire
Resistant Doorset**



BOMBA Malaysia
**2 Hours Steel Fire
Resistant**

CIDB MALAYSIA

PERAKUAN PENDAFTARAN

Adalah dengan ini diperakui bahawa kontraktor yang dinyatakan di bawah ini telah bertafar dengan Lembaga mengikut Bahagian VI Akta Lembaga Pembangunan Industri Pemukiman Malaysia 1994. Pendaftaran ini adalah terhad kepada syarikat-syarikat yang telah ditetapkan bersama perakuan ini.

No. Pendaftaran : 0120210009-WP080053
 Nama Kontraktor : MACRO JEWEL SDN BHD
 Alamat Bertafar : 19-3 JALAN TASK SELATAN 3 BANDAR TASK SELATAN 57000 KUALA LUMPUR WILAYAH PERSEKUTUAN KUALA LUMPUR

Darjah : KUALA LUMPUR
 Tarikh Mula Bertafar : 11/08/2021

SEKED	KATEGORI	PENYUKHUBUSAN
G7	B	B94
G7	CE	CE21
G7	ME	M15

Tarikh Mula Berkuatkuasa : 10/02/2025
 Tarikh Habis Tempoh Perakuan : 15/12/2026
STATUS: AKTIF

Ketua Eksekutif
 Lembaga Pembangunan Industri Pemukiman Malaysia
 Tarikh: 19/02/2025

SIRIM QAS INTERNATIONAL

No Lesen : PC002449
 Licence No :

LESEN PENSIJILAN BARANGAN
Product Certification Licence

SIRIM QAS International Sdn. Bhd. dengan ini menganugerahkan kepada SIRIM QAS International Sdn. Bhd. hereby grants to

MACRO JEWEL SDN BHD
 LOT 57 B
 KULIM INDUSTRIAL ESTATE
 09000 KULIM
 KEDAH, MALAYSIA

Lesen untuk menggunakan Tanda Pensijilan di atas barangan di bawah ini
STEEL FIRE RESISTANT DOORSET (DOUBLE LEAF)
 Please refer to detail in the SCHEDULE

sebagai mematuhi keperluan as complying with:
MS 1073 : PART 3 : 1996 (AMD.1 : 2003)

Tarikh Mula Pensijilan : 05 August 2016
 Tarikh Dikeluarkan : 30 July 2025

Tu. Md. Adha bin Katri @ Rahmat
 Ketua Pegawai Eksekutif
 SIRIM QAS International Sdn. Bhd.

SIRIM QAS INTERNATIONAL

No Lesen : PC002128
 Licence No :

LESEN PENSIJILAN BARANGAN
Product Certification Licence

SIRIM QAS International Sdn. Bhd. dengan ini menganugerahkan kepada SIRIM QAS International Sdn. Bhd. hereby grants to

MACRO JEWEL SDN BHD
 LOT 57 B
 KULIM INDUSTRIAL ESTATE
 09000 KULIM
 KEDAH, MALAYSIA

Lesen untuk menggunakan Tanda Pensijilan di atas barangan di bawah ini
STEEL FIRE RESISTANT DOORSET (SINGLE LEAF)
 Please refer to detail in the SCHEDULE

sebagai mematuhi keperluan as complying with:
MS 1073 : PART 3 : 1996 (AMD.1 : 2003)

Tarikh Mula Pensijilan : 22 January 2016
 Tarikh Dikeluarkan : 25 November 2025

Tu. Md. Adha bin Katri @ Rahmat
 Ketua Pegawai Eksekutif
 SIRIM QAS International Sdn. Bhd.

No Perakuan : JBP/MP/RNP-700-712/3-513 (19)
 (SEKELAH ADA)

Jabatan Bomba dan Penyelamat Malaysia
SIJIL PEPASANGAN KESELAMATAN KEBAKARAN

Pintu Api / Fire Door
 MS 1073: Part 3 Method for Determination of the Fire Resistance (Type of Doorsets)

Dengan ini diperakui
MACRO JEWEL SDN BHD (M)

Bertoperasi di
LOT 57B, JALAN PERUSAHAAN, KULIM INDUSTRIAL ESTATE, 09000 KULIM, KEDAH

TELAH BERDAFTAR
 TEMPOH SAH PERAKUAN : 29/12/2025 HINGGA 28/12/2027

T.T
 Ketua Pengarah
 Jabatan Bomba dan Penyelamat Malaysia

**Peringatan:
 Sila patuhi sepenuhnya syarat-syarat dan had kegunaan seperti dalam Lampiran A1
 (Sijil ini adalah cetakan berkomputer dan tidak memerlukan tandatangan)

No. Fail: JBP/MP/RNP-700-712/3-559 (18)
 (PEMBAHARUAN: KELAPAN)

SIJIL PEPASANGAN KESELAMATAN KEBAKARAN
 APPROVAL CERTIFICATE

Jabatan Bomba dan Penyelamat Malaysia
 Fire and Rescue Department of Malaysia
 hereby certify

PINTU API / FIRE DOOR
 (MODEL: FD-ZE-VP)

Berdasarkan Piawalan
 Complying with
MS 1073: PART 3: 1996 (AMD.1: 2003)

Syarikat Berdaftar
 Registered company
MACRO JEWEL SDN BHD (64582-W)
 Wisma MS, No. 15, Jalan 2/16D
 Kuchai Entrepreneurs' Park
 Jalan Kuchai Lama
 58200 Kuala Lumpur
 Wilayah Persekutuan Kuala Lumpur

Tempoh sah perakuan: 05/08/2024 hingga 05/08/2026

(KAMARUZAMAN MALIK ABDULLAH)
 Pengarah
 Bahagian Perancangan dan Penyelidikan
 b.p. Ketua Pengarah
 Jabatan Bomba dan Penyelamat Malaysia
 Tarikh: 05/08/2024

** Peringatan:
 Sila patuhi sepenuhnya syarat-syarat dan had kegunaan seperti dalam Lampiran A1

Project References

Over the years, we have had the privilege of delivering reliable solutions to a wide range of clients across various industries. Below is a selection of our completed projects, showcasing our commitment to quality, safety, and customer satisfaction.

Data Centre



PDG JH1 Data Center Phase 1
KIDEX, Johor



IPDC Data Center
Johor



PDG JH1 Data Center Phase 4
KIDEX, Johor



NEXTDC KL1
Petaling Jaya

Semiconductor / Electronics Manufacturing



Vitrox
Bayan Lepas



Micron Memory
Batu Kawan



Sandisk Storage
Batu Kawan



Infineon
Melaka



FORESIGHT Asia Pacific
Bayan Lepas



AT&S Malaysia Construction Project Phase 1
Kulim



Showa Denko
Kulim



OSRAM
Kulim



Infineon
Kulim

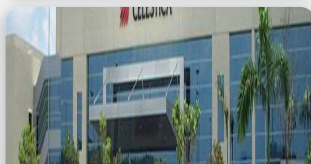

Celestica
Kulim



Watlow
Kulim



SRM
Penang



Linktel Technology
Batu Kawan



Benchmark
Batu Kawan



Jabil
Batu Kawan

Project References

General / Precision / Automotive / Industrial Manufacturing



Vinda Malaysia
Shah Alam



CPI Penang
Bayan Lepas



Atom Corporation
Selangor



IOI Acidchem
Perai



HICOM Teck See
Tanjung Malim



Ferrotec
Kulim



Elektrisola
Janda Baik



ITW Meritex
Simpang Ampat



PONS B Proton
Tanjung Malim, Perak



Santomas
Kulim



Veenco Switchgear
Perai

Warehousing, Logistics & Assembly



Plexus Riverside Warehouse
Bayan Lepas



Equalbase Valdor 2
Simpang Ampat



Mforce Bike
Batu Kawan



Equalbase Valdor 1
Simpang Ampat

Retail / Commercial Developments



Lotus'S
Kuantan



Lotus'S
Sungai Jati

Utilities & Substations



Sustio TNB Substation
Batu Kawan



Sustio
Batu Kawan



Elite Material TNB Substation
Penang



PDG TNB Substation
Kidex, Johor

Food & Beverage Manufacturing



KellyFresh
Simpang Ampat

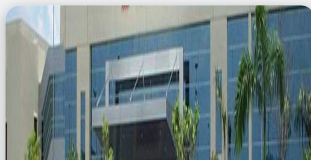

Ajinomoto
Negeri Sembilan



Kerry Emulgro
Shah Alam

Medical & Healthcare Facilities



Molnlycke Healthcare
Kulim Hi-Tech Park, Kedah



Island Hospital
Penang

High-rise Residential / Apartments



Vesta Residence
Setiawangsa



Asia Green
Penang

Mixed-use / Commercial Complexes



The Light City
Georgetown, Penang



Lot 57B, Jalan Perusahaan, Kulim Industrial Estate, 09000 Kulim, Kedah, Malaysia
Tel: +604 - 410 9120 Email: info@macrojewel.com.my
www.macrojewel.com.my

KL Sales Office:
Menara Poh & Poh, Level 3, 2A, Jalan 13/6A, 46200 Petaling Jaya, Malaysia
Tel: +603 - 7457 2688 Email: info@macrojewel.com.my

