



# PRODUCT Catalog

Explore our comprehensive range of high-quality bolts, nuts, and fasteners available in stainless steel, alloy, carbon steel, brass, nylon and more. Built for strength, durability and precision across all industries.



Whatsapp Us



Email Us



011-1111 9223



wecare.universalboltsandnuts@gmail.com



No. 63-2, Jalan Bestari 6B,  
Commercial City, Bandar Bestari,  
42000 Klang, Selangor.

# PRODUCTS

1



Hexagon Bolt

2



Flange Bolt with Serr

3



U Bolt

4



Square U Bolt

5



Chemical Bolt

6



Eye Bolt

7



Carriage Bolt (Square Neck)

8



Hexagon Lag Bolt/Coach Bolt

9



Weld Bolt

10



CD Stud

11



T Head Bolt

12



L Bolt

13



J Bolt

14



Coupling Bolt

15



Standoff Bolt

16



Clinching Stud

17



Turn Buckle

18



Shackle

19



B7 Stud Bolts

20



L7 Stud Bolts

# PRODUCTS

21



Two End Thread Stud Bolts

22



L-Bolts

23



J-Bolt

24



Square J-Bolt

25



Hexagon Flange Bolt

26



Swing Bolt

27



Stud Bolt

28



Wing Bolt

29



Cup Square Bolt

30



Plow Bolt

31



Elevator Bolt

32



Square Bolt

33



Hook Bolt

34



Special Eye Bolt

35



V-Bolt

36



Allen Bolt

37



Cup Square Bolt

38



Socket HD Set Screw

39



Socket HD Countersunk Screw

40



Socket HD Button Screw

# PRODUCTS

40



Socket HD  
Shoulder Screw

41



Socket Low HD  
Cap Screw

42



Socket Lock Screw/  
BSP, NPT Plus

43



Ball Plunger Screw  
(Socket/Slotted HD)

44



Spring Plunger Screw  
(Socket/Slotted HD)

45



Button Torx with  
Pin Screw

46



Thumb Screw Knob

47



Pan HD  
Machine Screw

48



Counter Sunk HD  
Machine Screw

49



Truss HD  
Machine Screw

50



Bingding HD  
Machine Screw

51



Cheese HD  
Machine Screw

52



Pan HD Self  
Tapping Screw

53



Countersunk Self  
Tapping Screw

54



Pan HD Self  
Drilling Screw

55



Countersunk Self  
Drilling Screw

56



Hexagon HD Self  
Drilling Screw  
(HW/HO)

57



Wafer HD Self  
Drilling Screw

58



Hexagon HD Self  
Drilling Screw Type 17

59



Wing Screw

# PRODUCTS

61



Adjustable  
Screw Lag

62



Mirror Screw  
With Cover

63



JCBC / JCBB

64



Drywall Screw

65



Chipboard Screw

66



Taprite Machine  
Screw

67



Hand Knob  
(Hexagon Type)

68



Cheese HD  
Machine Screw

69



Screw Bit

70



Allen Key

71



T Type Allen Key

72



Stud Rod

73



Two End Thread Rod

74



Insert Gun (Manual)  
M3-M8

75



Thread Locker  
(Lockite)

76



Chemical Statheros  
EAC80

77

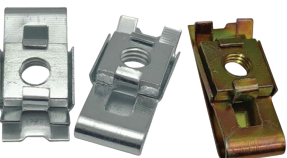

Lift & Elevator  
Sliding Canopy Nut

78



U-Plated  
Speed Nut

79

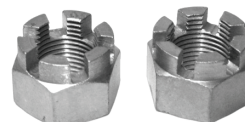

Castle Nut

80



Kep Nut



# PRODUCTS

81



Hexagon Nut

82



Nylon Lock Nut

83



Cap Nut

84



Wing Nut

85



Long Nut

86



Eye Nut

87



Cage Nut

88



Flange Nut

89



Spring Nut

90



Square Nut

91



Blind Nut / Insert Nut

92



Castle Nut

93



Tee Nut

94



JCN Nut

95



U Nut / Self Locking Nut

96



D Nut

97



Clinching Nut

98



Hand Tap

99



Machine Tap

100



Tap Handle

# PRODUCTS

101



Flat Washer

102



Spring Washer

103



Taper Washer

104



Contact Washer

105



Wave Washer

106



Inter Lock Washer

107



External Lock Washer

108



Bonder Washer

109



Overlap Lock Washer

110



Cup Washer

111



Disc Spring Washer

112



Square Washer

113



Dowel Pin

114



Pull Out Dowel Pin

115



Taper Pin

116



Self Lock Pin / Spring Pin

117



Snap Pin

118



Cotter Pin

119



Recoil Insert

120



Recoil Individual Kit Set

# PRODUCTS

121



Circle Clip  
(Type A/B)

122



E Clip

123



U Plate Clip

124



Push On Clip

125



Wire Rope Clip

126



Papaya Clip

127



Dome HD  
Blind Rivet

128



CSK HD Blind Rivet

129



Solid Rivet

130



Hammer Drive Rivet

131



Sleeve Anchor/  
PJ Anchor

132



Wedge Anchor

133



Drop In Anchor

134



High Anchor

135



Nylon Speed  
Plug Anchor

136



Toggle Nylon  
Anchor

137



Hammer Drive  
Anchor

138



PVC Wall Plug

139



Steel Ball

140



Round Die

# PRODUCTS

141



G-Clip

142



Channel Clip

143



Trunking Bracket

144



Type D Bracket

145



CLEVIS Bracket

146

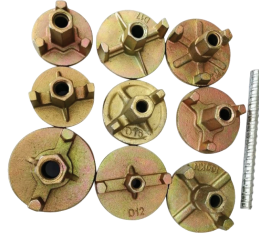

Tie Rod with Wing Nut

147



Nylon Rubber End Cap

148



Aluminium Trifold Rivet

149



Scaffolding Clamp

150



Screw Thread Water Stop Tie Rod

151



Wedge Bolt with Round Head Pin

152



Nylon C-Channel End Cap

153



Tiger Beam Clamp

154



Galvanized Steel Wire Rope

155



Steel Bend



# THREAD SIZE COMPARISON

Metric Pitch (MM)				Imperial Thread Per Inch					
Dia.	Coarse	Fine	Extra Fine	Dia.	Commonly Thread		UNF	UN8	BSF
					UNC	BSW			
M1	0.25			#4	40		48		
M1.2	0.25			#5	40	40	44		
M1.4	0.3			#6	32		40		
M1.6	0.35			#8	32		36		
M2	0.4			#10	24	24	32		32
M2.5	0.45			#12	24		28		
M3	0.5	0.35		1/4	20	20	28		26
M3.5	0.6			5/16	18	18	24		22
M4	0.7	0.5		3/8	16	16	24		20
M5	0.8	0.5		7/16	14	14	20		18
M6	1.0	0.75		1/2	13	12	20		16
M7	1.0	0.75		9/16	12	12	18		16
M8	1.25	1.0		5/8	11	11	18		14
M10	1.5	1.25	1.0	3/4	10	10	16		12
M12	1.75	1.5	1.25	7/8	9	9	14		11
M14	2.0	1.5	1.0	1"	8	8	12	8	10
M16	2.0	1.5	1.0	1.1/8	7	7	12	8	9
M18	2.5	2.0	1.5	1.1/4	7	7	12	8	9
M20	2.5	2.0	1.5	1.3/8	6	6	12	8	8
M22	2.5	2.0	1.5	1.1/2	6	6	12	8	8
M24	3.0	2.0	1.5	1.5/8	5	5		8	8
M27	3.0	2.0	1.5	1.3/4	5	5		8	7
M30	3.5	3.0	2.0	1.7/8				8	
M33	3.5	3.0	2.0	2"	4.5	4.5		8	7
M36	4.0	3.0		2.1/4	4.5	4		8	6
M39	4.0	3.0		2.1/2	4	4		8	6
M42	4.5	3.0		2.3/4	4	3.5		8	6
M45	4.5	3.0		3"	4	3.5		8	5
M48	5.0	3.0		3.1/4	4	3.25		8	5
M52	5.0	3.0		3.1/2	4	3.25		8	4.5
M56	5.5	4.0		3.3/4	4	3		8	4.5
M60	5.5	4.0		4"	4	3		8	4.5
M64	6.0	4.0							



# MECHANICAL PROPERTIES

## U-BOLTS FOR STEEL PIPING

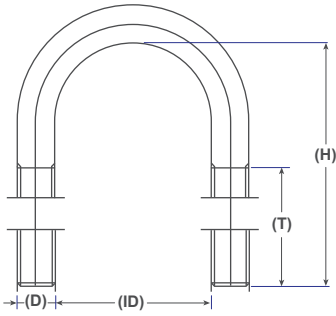

- 1 The following dimensions are recommended for standard steel piping fitting, custom made to special dimensions also available.
- 2 Grade of material use can be any of the following:
  - Low Carbon Steel, Alloy Steel, Stainless Steel
- 3 The product shall be bore finished, special coating is available i.e., Zinc Plating, Hot Dipped Galvanize Plated.

Nominal Pipe Size		Pipe Outside Diameter	Thread Size (D)		Inner Dimension (ID)	Height (H)	Thread Length (T)
mm	inch	mm	mm	inch	mm	mm	mm
15	1/2	21.7	6	1/4	24	42	22
20	3/4	27.2	6	1/4	30	47	22
25	1"	34.0	6	1/4	36	53	25
32	1-1/4	42.7	6	1/4	46	64	28
40	1-1/2	48.6	10	3/8	52	73	30
50	2"	60.5	10	3/8	64	85	32
65	2-1/2	76.3	10	3/8	80	105	35
80	3"	89.1	10	3/8	92	118	35
90	3-1/2	101.6	12	1/2	104	131	40
100	4"	114.3	12	1/2	118	150	55
125	5"	139.8	12	1/2	144	176	55
150	6"	165.2	16	5/8	170	210	65
200	8"	216.3	16	5/8	222	262	65
250	10"	267.4	20	3/4	274	320	75
300	12"	318.5	22	7/8	326	380	90
350	14"	355.6	22	7/8	362	420	90
400	16"	406.4	22	7/8	414	470	90
450	18"	457.2	24	1"	466	530	110
500	20"	508.0	24	1"	518	585	110
550	22"	558.8	24	1"	568	640	120
600	24"	609.6	24	1"	620	690	120



# MECHANICAL PROPERTIES

## HEXAGON BOLT

HEXAGON BOLT (FULL THREAD)

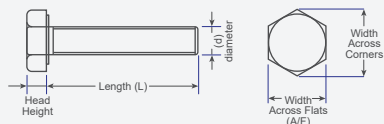

DIN 933  
DIN 961  
(FINE PITCH)

HEXAGON BOLT (HALF THREAD)

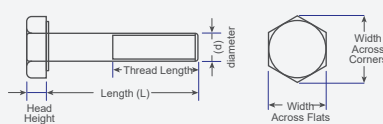

DIN 931  
DIN 960  
(FINE PITCH)

Size	M4	M5	M6	M7	M8	M10	M12	M14	M16	M18	M20
Pitch	0.7	0.8	1.0	1.0	1.25	1.5	1.75	2.0	2.0	2.5	2.5
Width Across Flat	7MM	8MM	10MM	11MM	13MM	17MM	19MM	22MM	24MM	27MM	30MM
Width Across Corners	7.66MM	8.79MM	11.05MM	12.12MM	14.38MM	17.77MM	20.03MM	24.49MM	26.75MM	30.14MM	33.53MM
Head Height	2.8MM	3.5MM	4MM	4.8MM	5.3MM	6.4MM	7.5MM	8.8MM	10MM	11.5MM	12.5MM

Size	M22	M24	M27	M30	M33	M36	M39	M42	M45	M48
Pitch	2.5	3.0	3.0	3.5	3.5	4.0	4.0	4.5	4.5	5.0
Width Across Flat	32MM	36MM	41MM	46MM	50MM	55MM	60MM	65MM	70MM	75MM
Width Across Corners	37.72MM	39.98MM	45.2MM	50.85MM	55.37MM	60.79MM	66.44MM	71.3MM	76.95MM	82.6MM
Head Height	14MM	15MM	17MM	18.7MM	21MM	22.5MM	25MM	26MM	28MM	30MM

## HEXAGON NUT

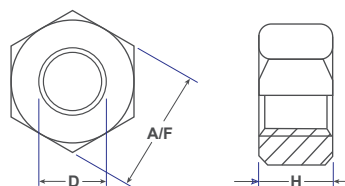

Size	M2	M2.5	M3	M3.5	M4	M5	M6	M7	M8	M10	M12	M14	M16	M18	M20
Pitch	0.4	0.45	0.5	0.6	0.7	0.8	1.0	1.0	1.25	1.5	1.75	2.0	2.0	2.5	2.5
A/F	4MM	5MM	5.5MM	6MM	7MM	8MM	10MM	11MM	13MM	17MM	19MM	22MM	24MM	27MM	30MM
Height	1.6MM	2MM	2.4MM	2.8MM	3.2MM	4MM	5MM	5.8MM	6.5MM	8MM	10MM	11MM	13MM	15MM	16MM

Size	M22	M24	M27	M30	M33	M36	M39	M42	M45	M48	M52	M56	M60	M64
Pitch	2.5	3.0	3.0	3.5	3.5	4.0	4.0	4.5	4.5	5.0	5.0	5.5	5.5	6.0
A/F	32MM	36MM	41MM	46MM	50MM	55MM	60MM	65MM	70MM	75MM	80MM	85MM	90MM	95MM
Height	18MM	19MM	22MM	24MM	26MM	29MM	31MM	34MM	36MM	38MM	42MM	45MM	48MM	51MM



# UNIVERSAL BOLT & NUT

## UNIVERSAL BOLTS & NUTS SDN BHD

202401034216 (1580064-D)

## KNOW OUR COMPANY

Established with a strong commitment to quality and reliability, our company specializes in supplying a wide range of industrial fasteners including bolts, nuts, washers, and custom components. With years of experience serving various sectors such as construction, automotive, and machinery, we aim to provide high-performance products that meet international standards. Customer satisfaction, prompt delivery, and product excellence remain at the core of our business.

### SPECIALIST IN:

Bolts, Nuts, Washers & Other Types of Fastener

### AVAILABLE IN:

Stainless Steel, Alloy Steel, Carbon Steel, Mild Steel Brass, Nylon and etc

### FINISHING:

Black Oxide (B/O), Zinc Plated (ZP), Rainbow Plated (RP), Nickel Plated (NK)  
Self Colour (SC / Plain), Hot Dipped Galvanized / HDG Galvanized, Black Zinc  
FLUOROCARBON, Mechanical Galvanized (M/G)

## Contact Us



011-1111 9223



wecare.universalboltsandnuts@gmail.com



No. 63-2, Jalan Bestari 6B,  
Commercial City, Bandar Bestari,  
42000 Klang, Selangor.