

ide[®]

www.ide.my

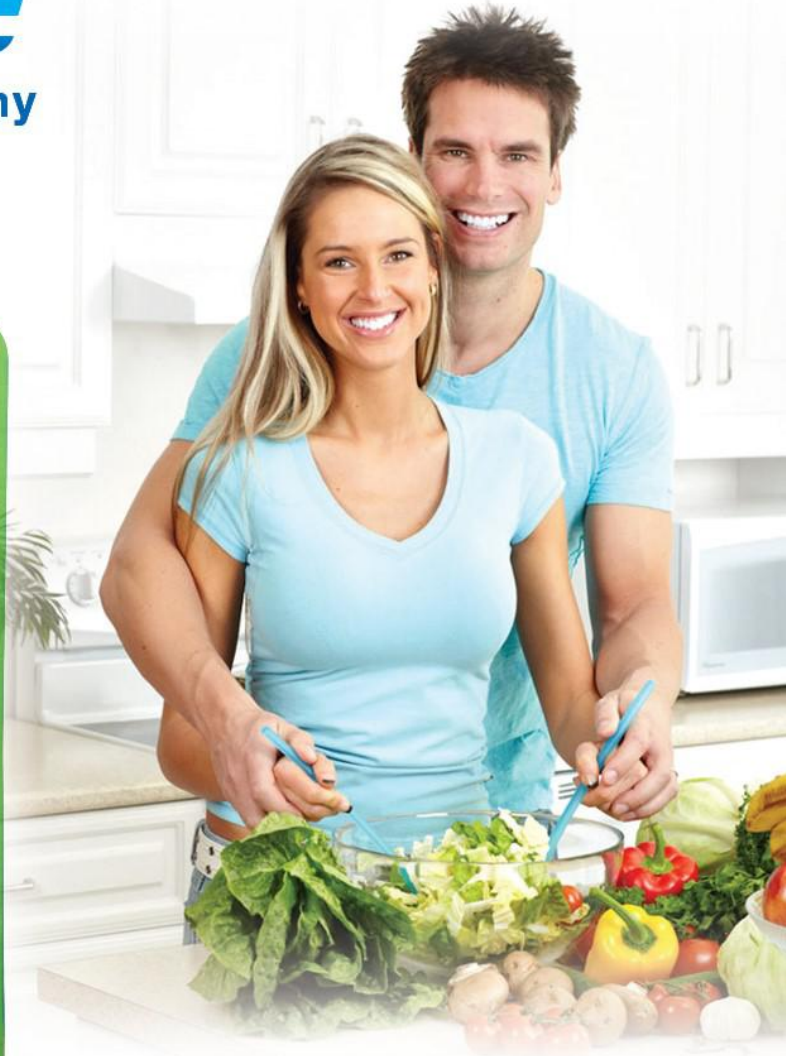

Enjoy purified water for
healthier life....



南洋商报—
金鹰奖之新秀奖

GOLDEN EAGLE AWARD
EMERGING EAGLES
AWARD 2015



星洲日报—
企业楷模奖

PRODUCT AND SERVICE
QUALITY EXCELLENCE
AWARD 2014



中小型企业—
卓越成就奖

SME RECOGNITION
AWARD 2014



马来西亚南马区企业—
最具影响力服务奖

MALAYSIA SOUTHERN
REGION MOST IMPACTFUL
SERVICE AWARD



MULTI MEDIA FILTER

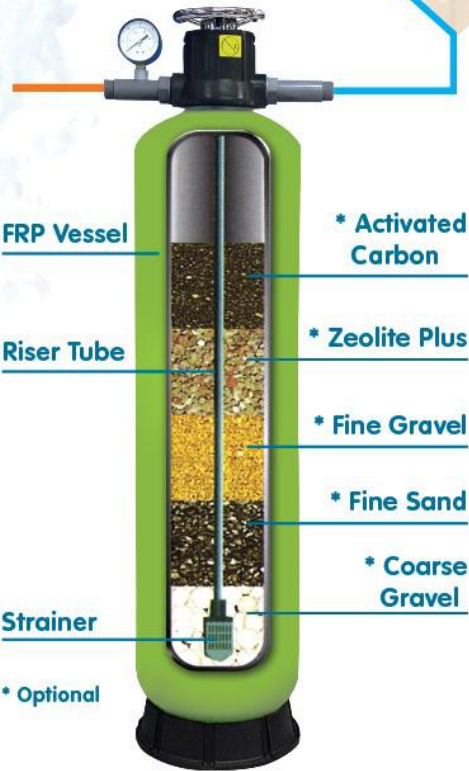

OUR PROMISED



抵抗紫外线, 防腐蚀。
不透明缸体, 可防止青苔或藻类在桶内滋生。
Ultra Violet light and corrosion resistant, for outdoor use



桶内层材料为符合食品规格的聚丙烯
Polypropylene Inner Tank
Virgin food grade material (FDA compliant)



拥有双层厚度

IDE WATER FILTRATION SYSTEM

IDE Water Filtration System Creating A Healthy Lifestyle

IDE 户外滤水系统带给您更健康美好的生活

- > **Natural Filter Media**
全天然滤水材料
- > **Cleaner, Brighter Laundry**
使衣物更清洁·亮丽
- > **Refreshing Baths and Showers**
浴室与沐浴用水也更清澈
- > **High Dirt Retention and High Effective Filtration System**
绝佳的除污功能及滤水功能
- > **Long Lasting & Warranty on FRP Vessel**
经久耐用与玻璃钢溶器品质保用
- > **Economics, Easy Operation and Handling**
经济实惠及方便操作使用
- > **Extending Life Span of Drinking Water Purifiers**
延长室内饮用滤水器的滤芯寿命
- > **Reduces Water Tank Maintenance and Cut Plumbing Costs**
减少储水槽的保养次数与维修费用



IDE 0935

IDE 0942

IDE 1044



IDE WATER BACKWASH INSTRUCTIONS
IDE户外滤水系统器反冲洗指南

5 Layer Filtration System

Multiport Valve [MPV]

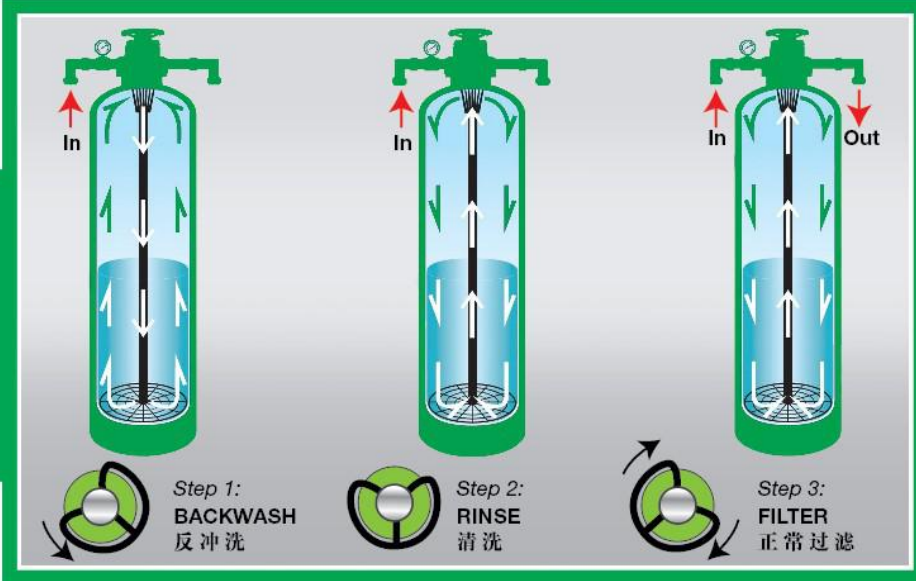

Turn the MPV handle from "Filter" mode to "Backwash" mode and then let the sediment flow out until appears clean. Backwash the water flow out for 2 minutes to 5 minutes.

将手柄阀门MPV从“正常过滤”阀门转移到“反冲洗”阀门至到过滤器内的污物被冲出至清洁为止。清洗大约2分钟—5分钟。

Turn the MPV handle from "Backwash" mode to "Rinse" mode to ensure the filtration water is clean. Rinse the water flow out for 30 seconds to 3 minutes.

将手柄阀门MPV从“反冲洗”阀门转移到“清洗”阀门。清洗大约30秒—3分钟。

Turn the MPV handle to "Filter" mode for normal filtration.

将手柄阀门MPV推向“正常过滤”阀门后，系统将正常操作，将过于正常水源。

SPECIFICATION

MODEL	IDE 0935	IDE 0942	IDE 1044
Diameter	9"	9"	10"
Height	35"	40"	44"
Valve Size	3/4"	3/4"	3/4"
Media Capacity	35KG	45KG	55KG
Min. Working Pressure	25psi	25psi	25psi
Max. Working Pressure	120psi	120psi	120psi
Flow Rate	28LPM	35LPM	42LPM



IDEALLEX SDN. BHD. (Co. No. 649290-U) (GST No. 000450691072)
67, 69, Jalan Bentara 20, Taman Ungku Tun Aminah,
81300 Skudai, Johor Bahru, Malaysia.
Tel : 07-556 8678/ 07-556 8679

Hotline 服务热线
1300 888 758
www.ide.my