

MANUAL

RG-AT30S

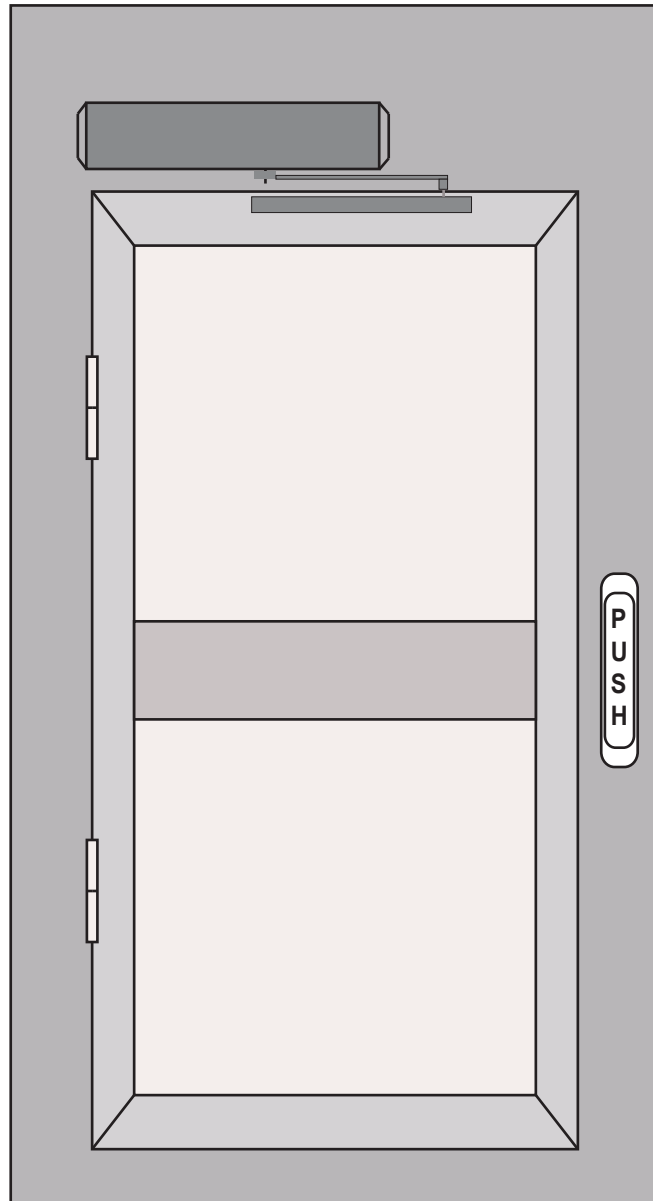

AUTOMATIC ENTRANCE SPECIALISTS

Content

1	Technical parameters	1
2	Components	2
3	Installation step	3-10
3.1	Installation demonstration	3
3.2	Installation of bottom plate	4-5
3.3	Installation of pull bar	6-7
3.4	Installation of push bar	8-9
3.5	Installation of mechanism	10
3.6	Installation of cover	10
4	Wire diagram	11-12
5	Data setting	13
6	Function of remote	14
7	LED instructions	15

1. Technical Parameters

Power: AC 200V-240V

Active open time: 3-7s/90°

Hold open time: 1-20s

Temperature: -20°C- +55°C

Protection class: IP12D

Product weight: Product weight 5.5kg

Pull bar 0.9kg

Psuh bar (optional) 0.9kg

Product size: 600*85*110mm

Max open angle: 110°

mm = Door width

kg = Door weight

 Suitable range

 Limited range

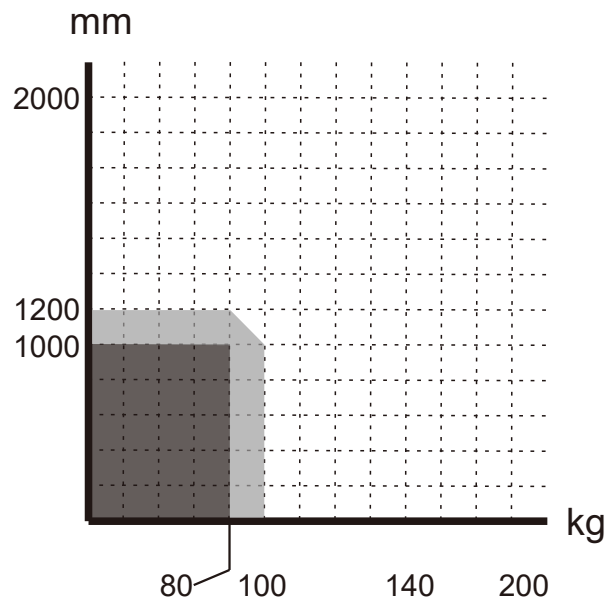

2.Components

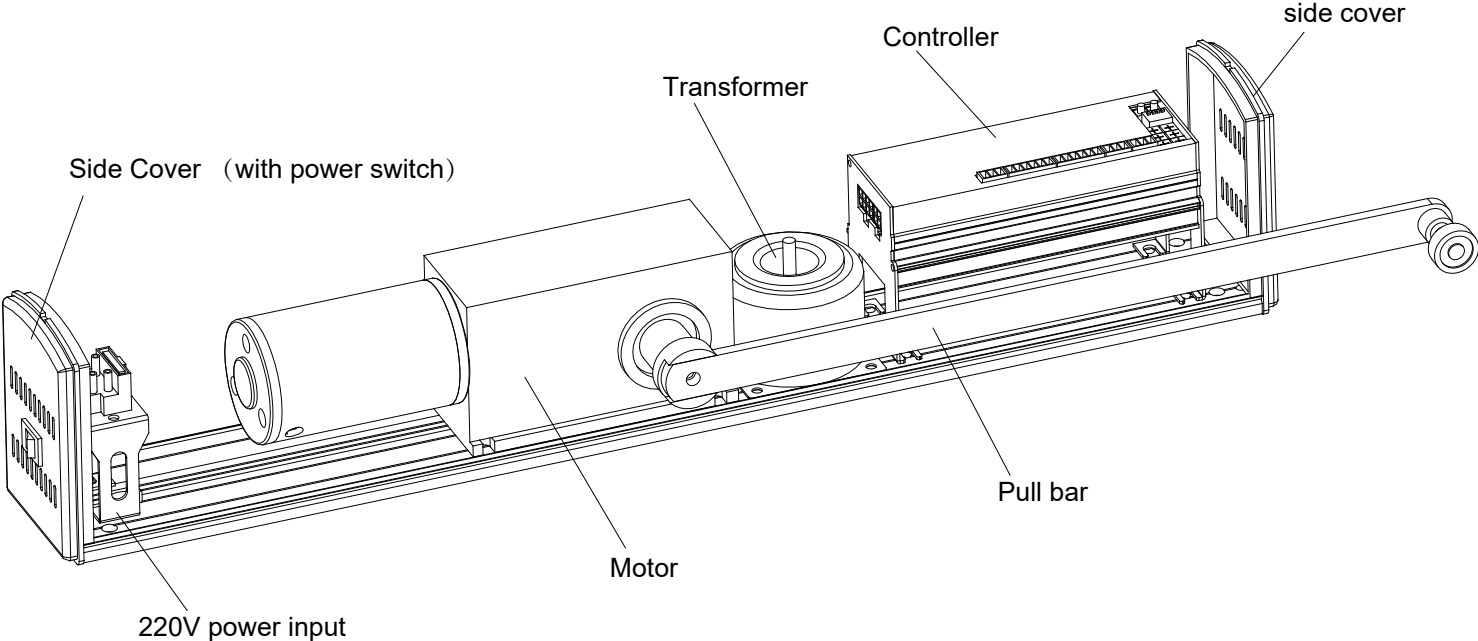

3.Installation step

3.1 Installation demonstration

Installation of Pull bar type, suit for door open to inside
(mechanism is inside)

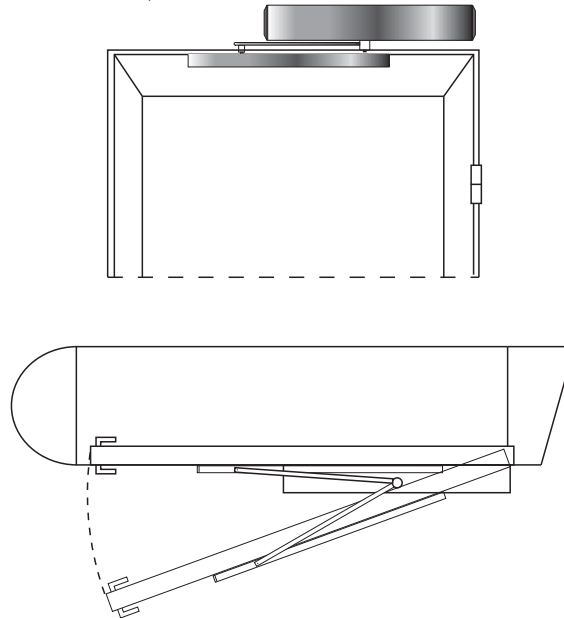

Installation of push bar type, suit for door open to outside
(mechanism is inside)

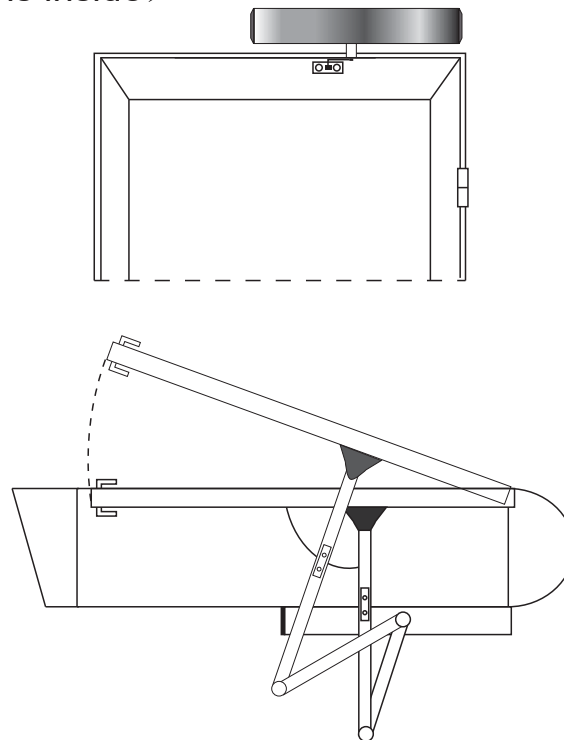

3. Installation step

3.2 Installation of bottom plate

Installation of pull bar type

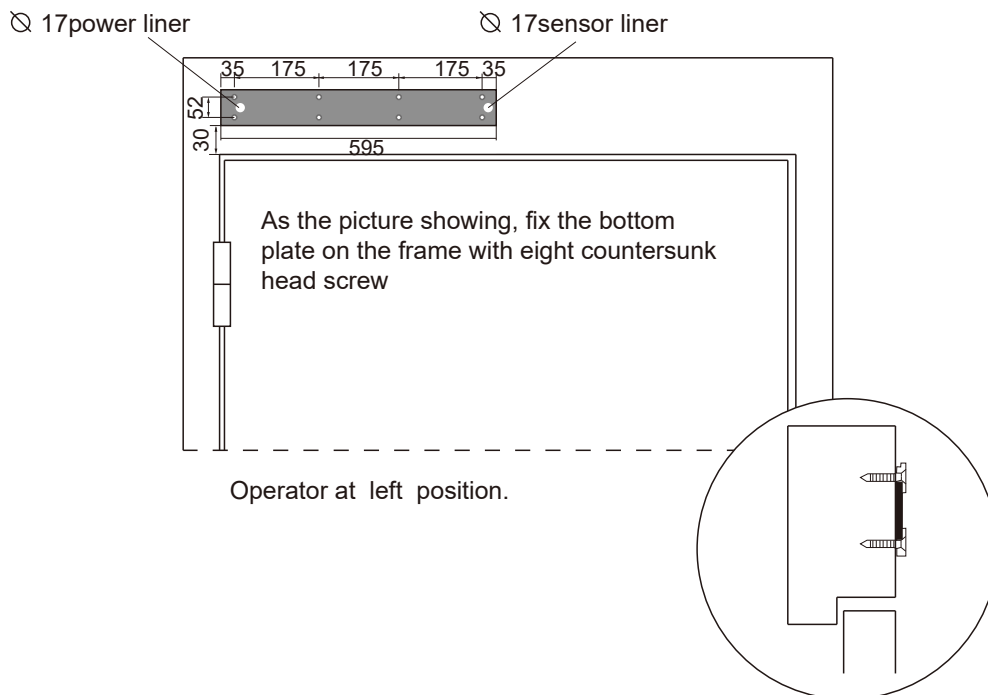
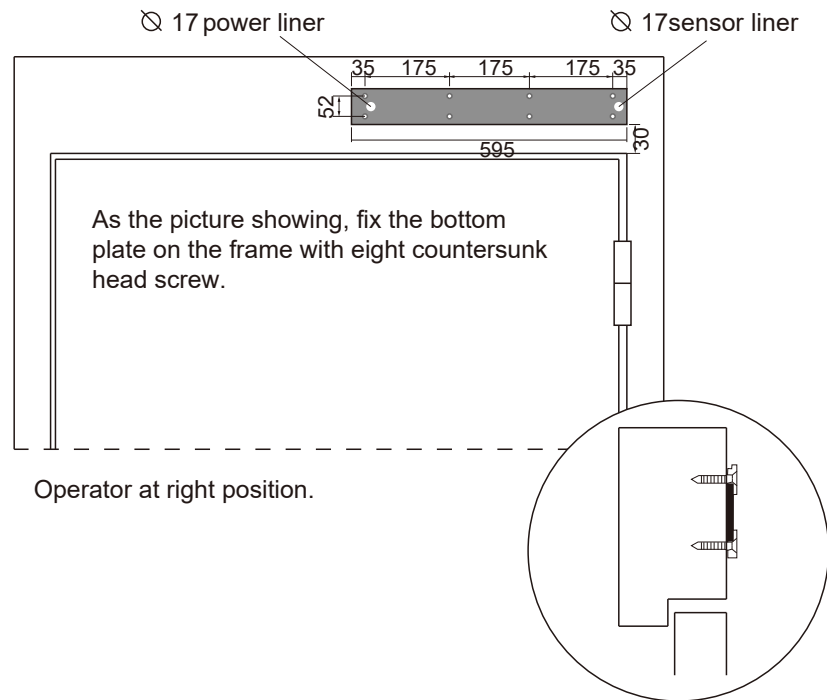

3. Installation step

3.2 Installation of bottom plate

Installation of push bar type

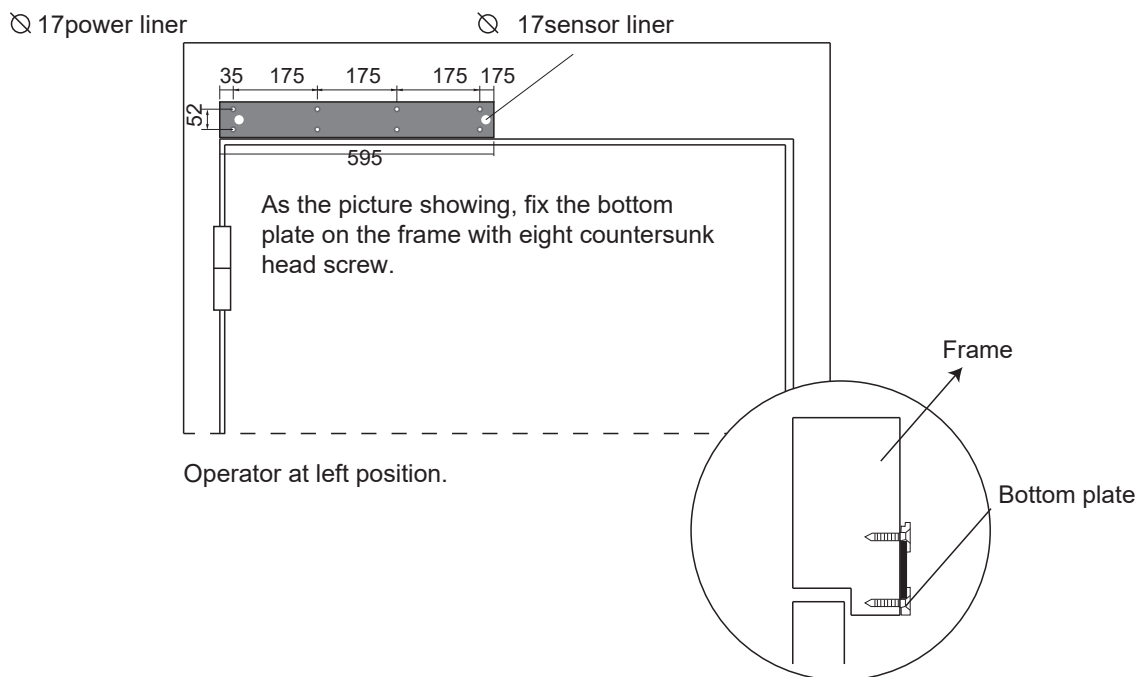
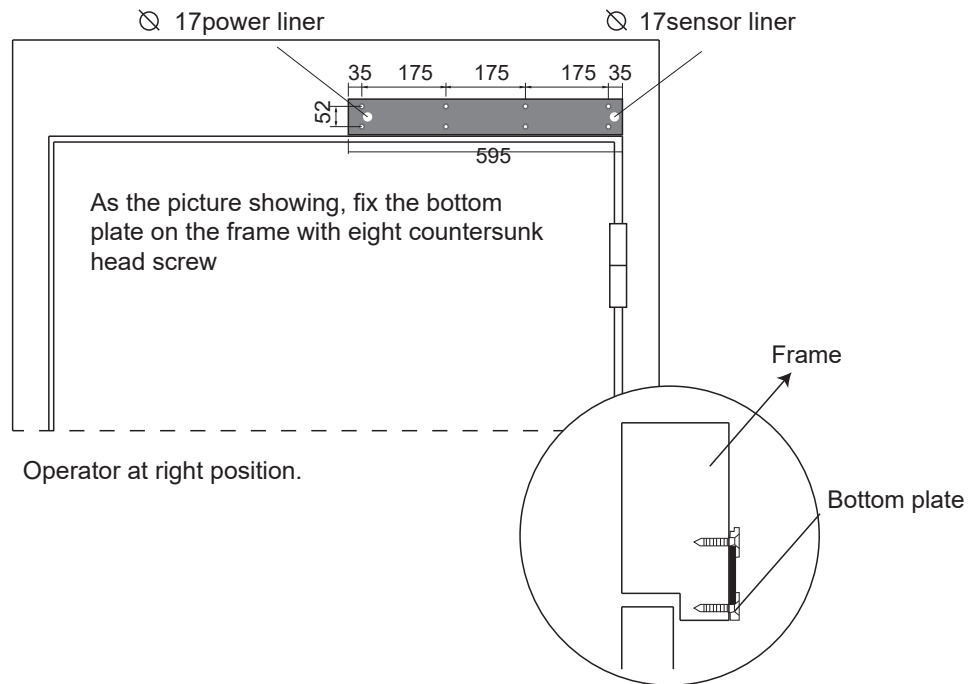

3. Installation step

3.3 Installation of pull bar guider(Right position)

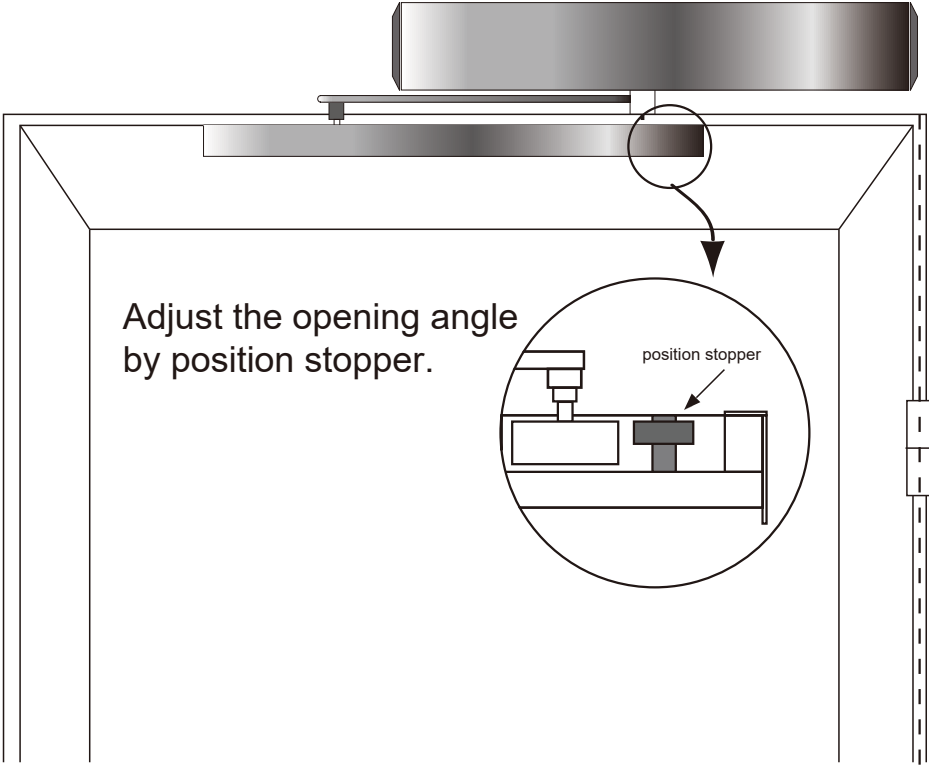
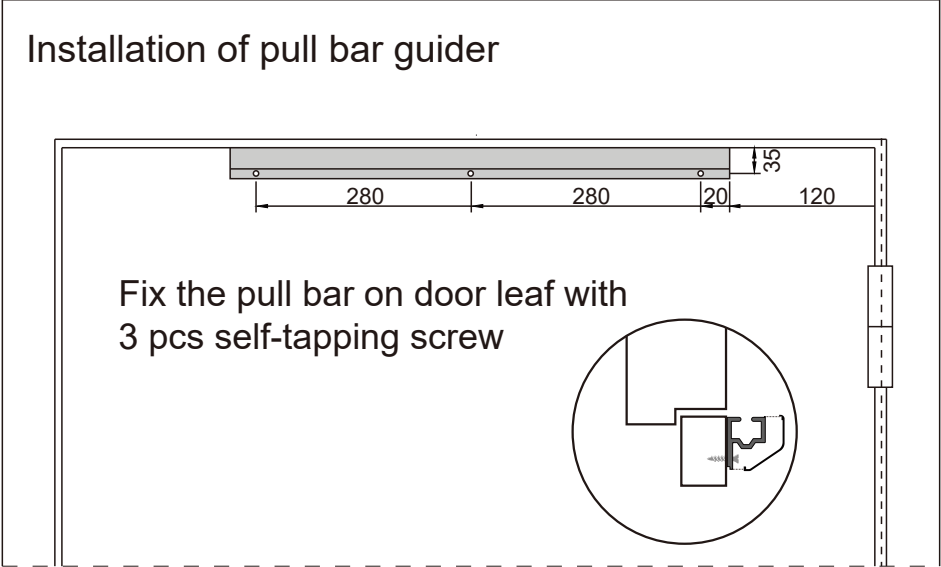

3.Installation step

3.3 Installation of pull bar guider(Left position)

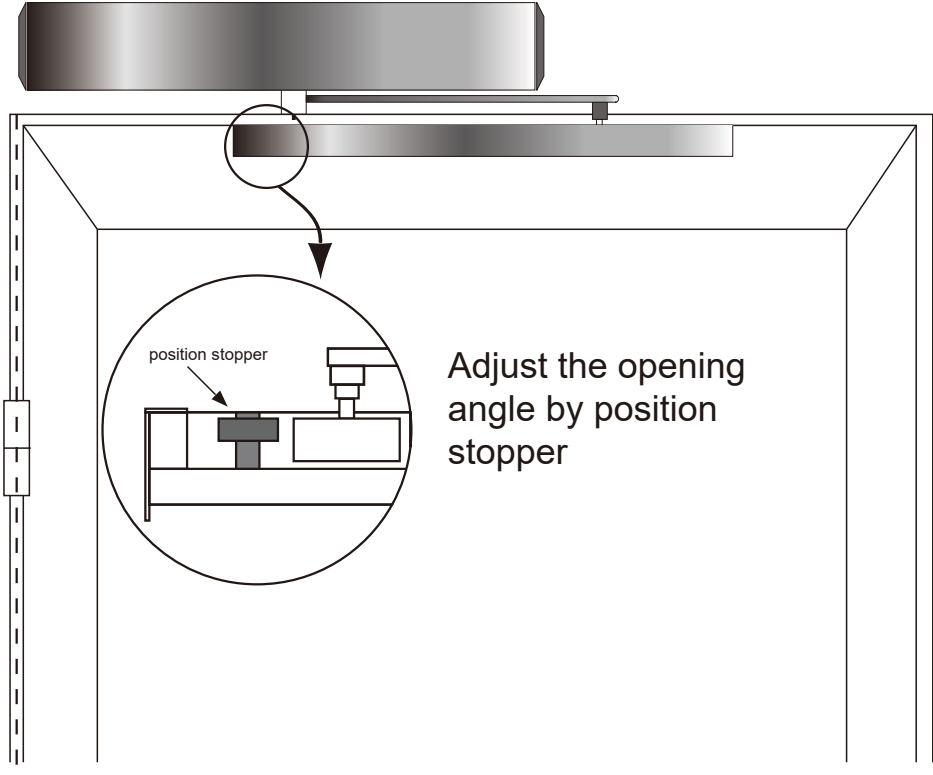
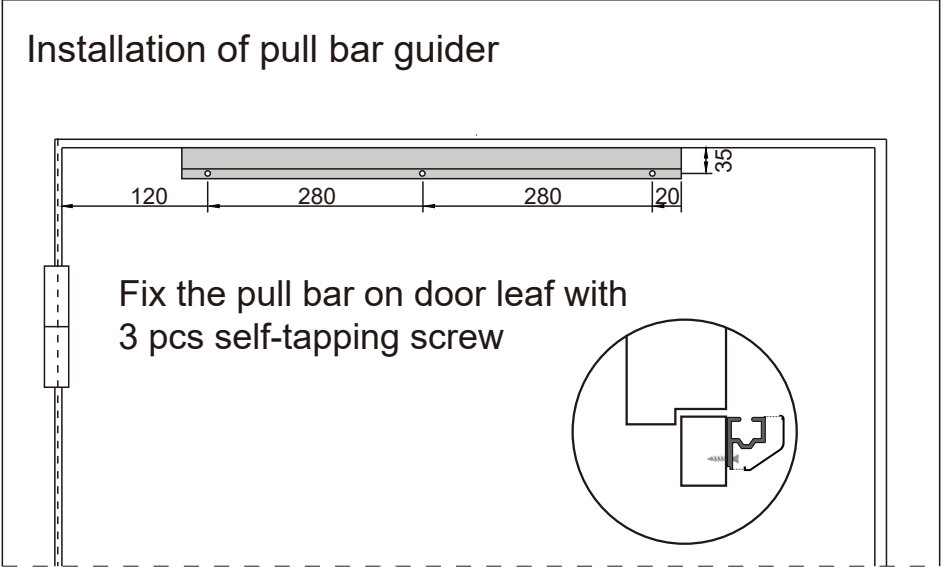

3. Installation step

3.4 Installation of push bar (Right position)

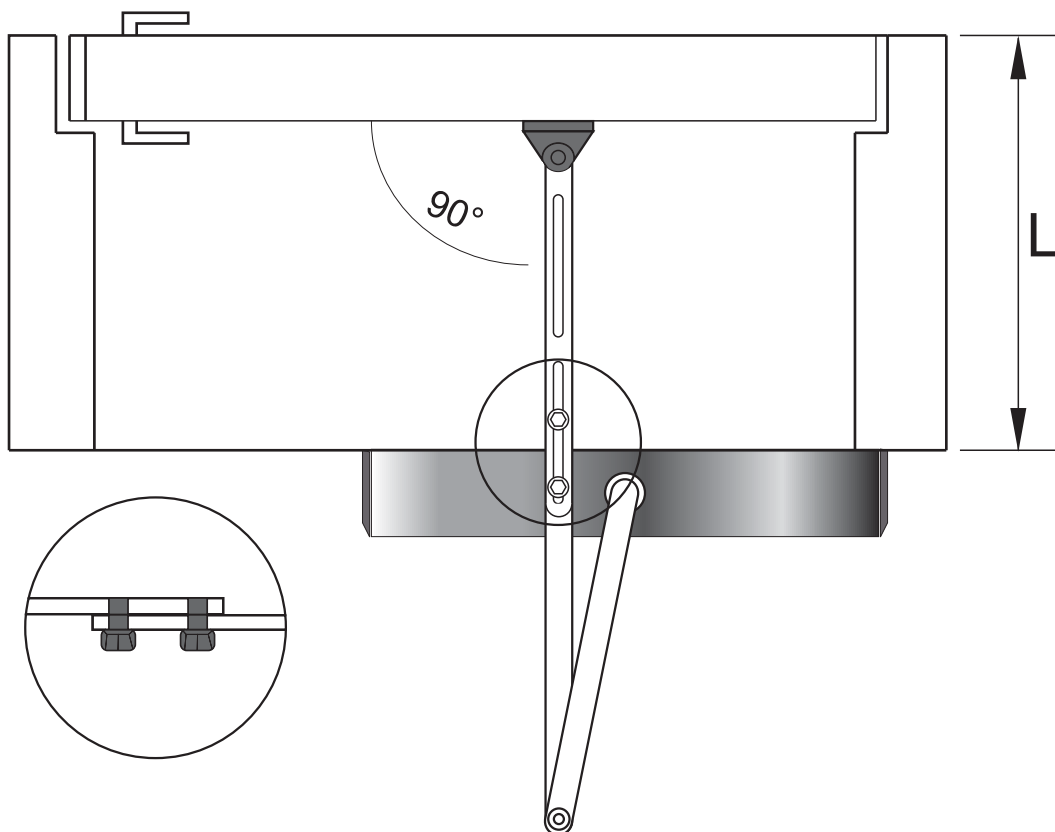
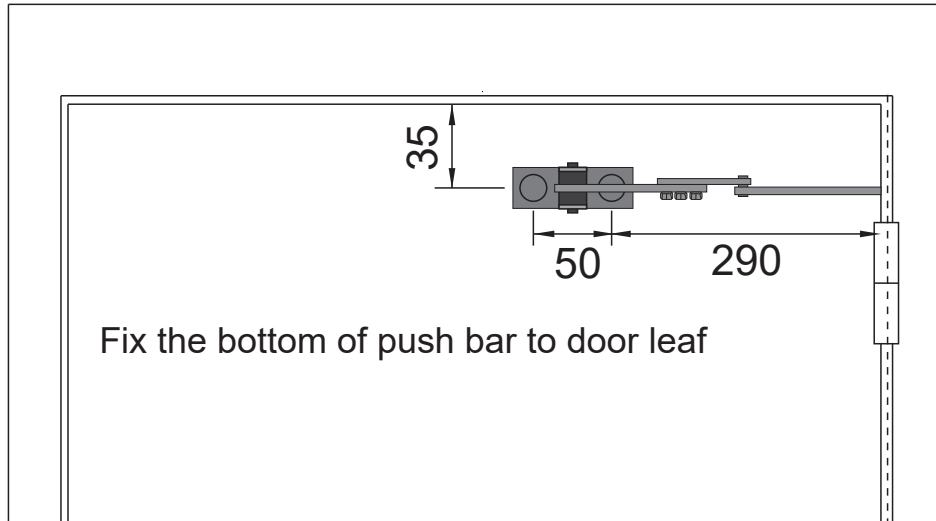

Adjust the push bar length by two screws according to the door frame's depth(L)

3. Installation step

3.4 Installation of push bar (Left position)

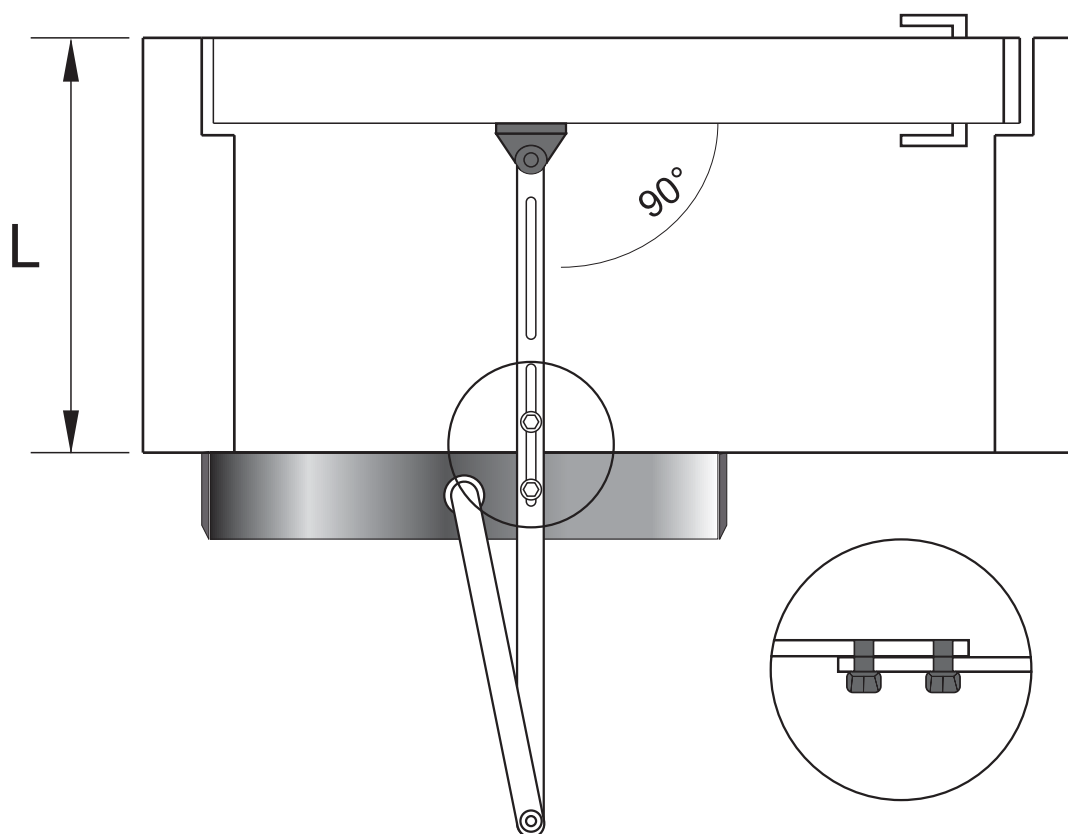
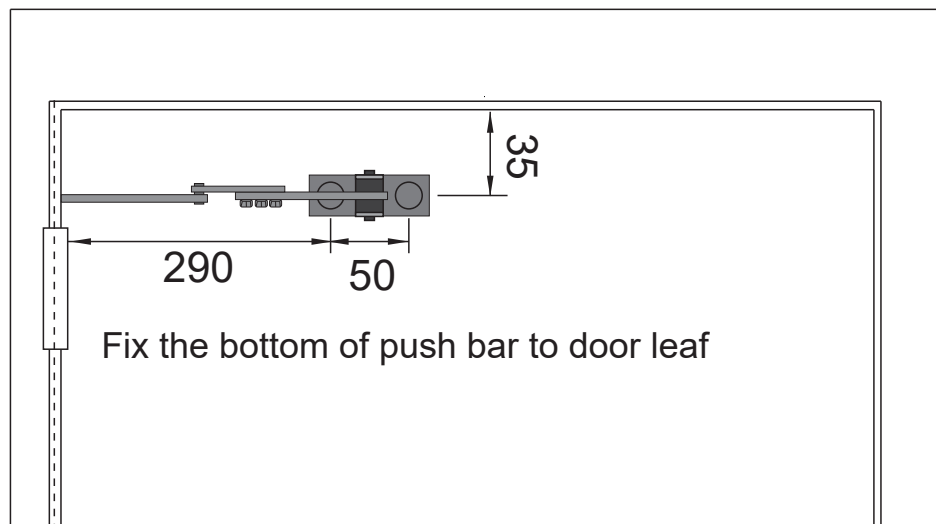

Adjust the push bar length by two screws according to the door frame's depth(L)

3.Installation step

3.5 Mechanism installation

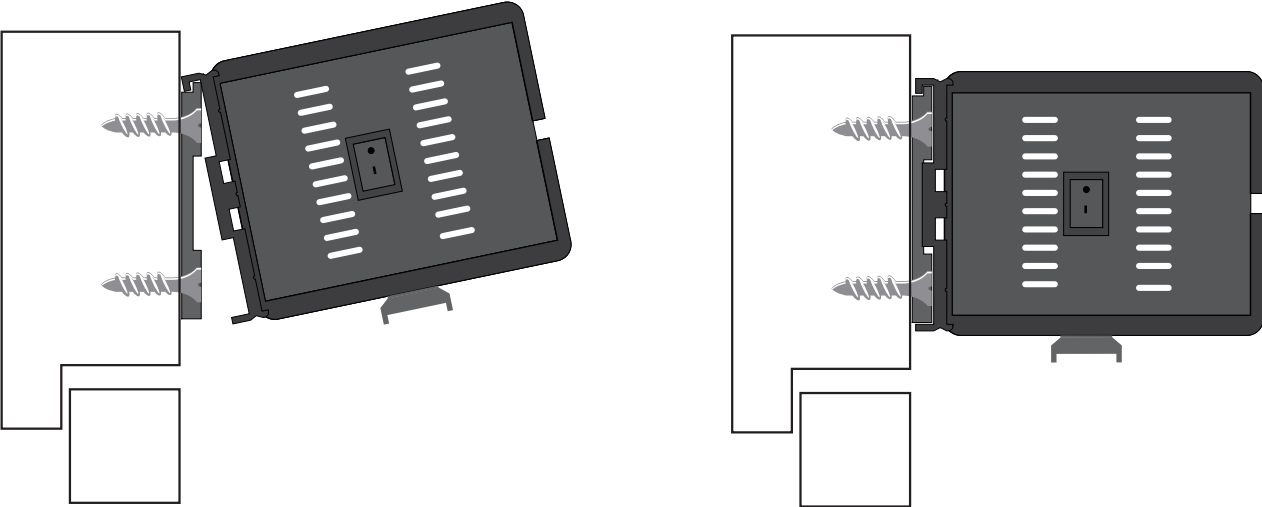

Hang the mechanism on the fixed base cover with screws.

3.6 Assemble and disassemble of the mechanism up cover

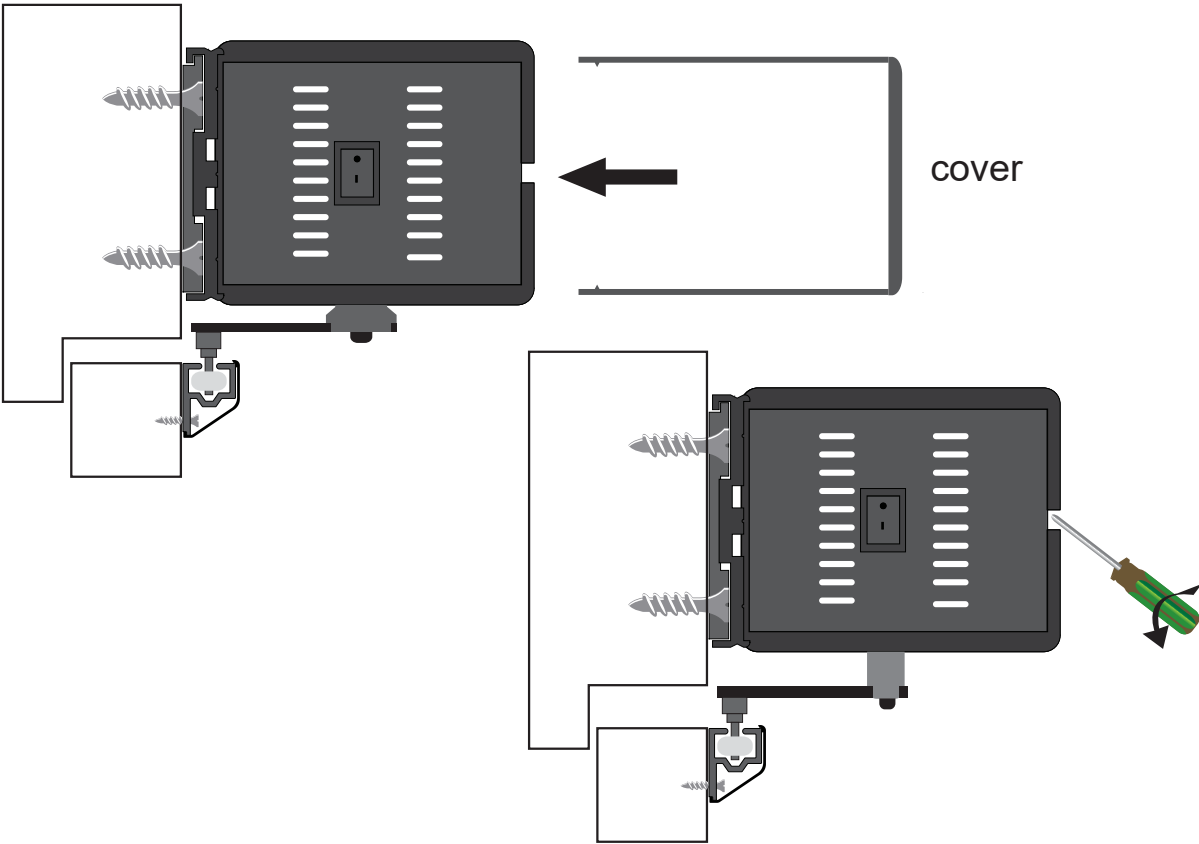

4.Wire diagram

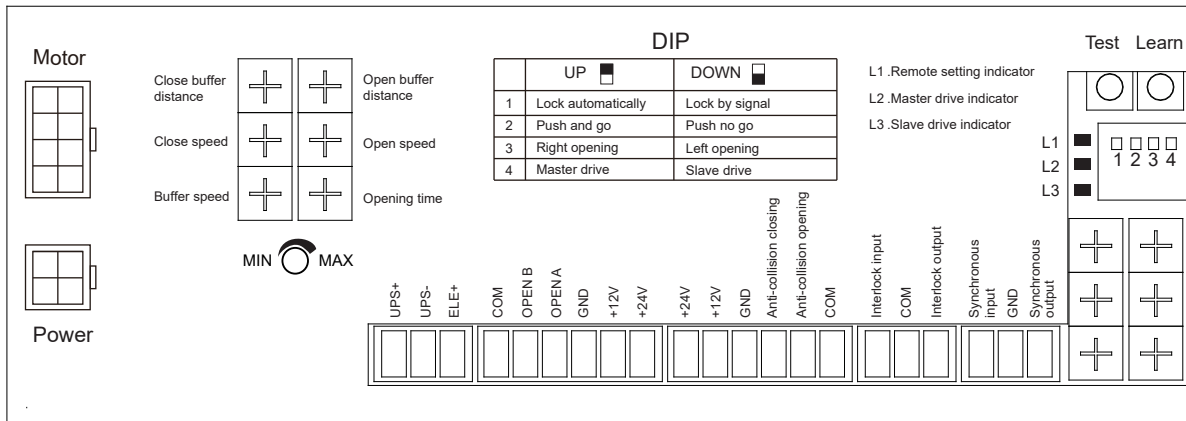

Inter lock



Synchronous



Attention: Controller will alarm while synchronous line not connect or wrong connect
buzzer will not bip, red and green led will flash 3 times within 4 second

In single mode: bridge connect terminal 19 and 21

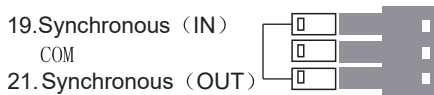

24G Microwave sensor

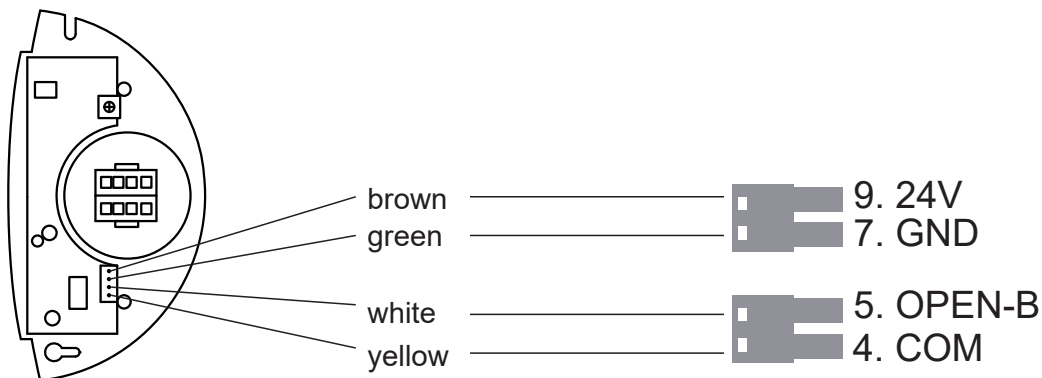

4.Wire diagram

UPS

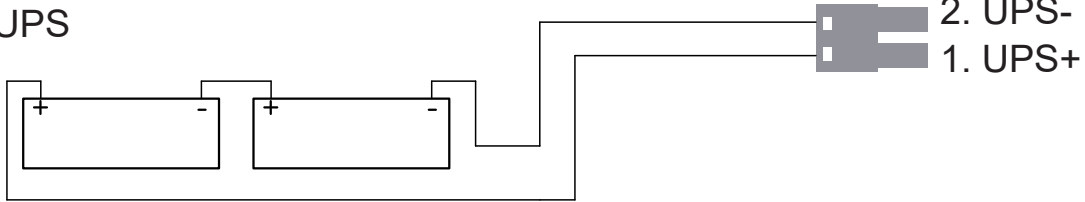

AK04

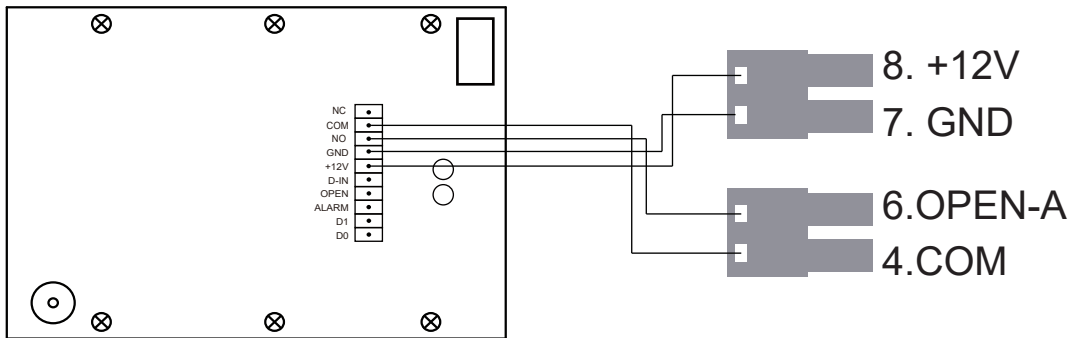

E-LOCK

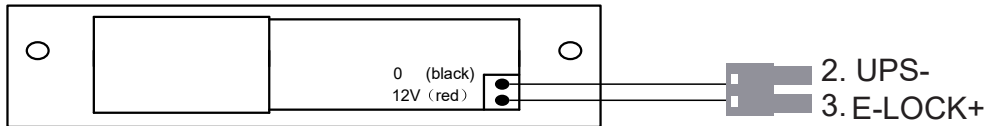

Anti-collision opening sensor

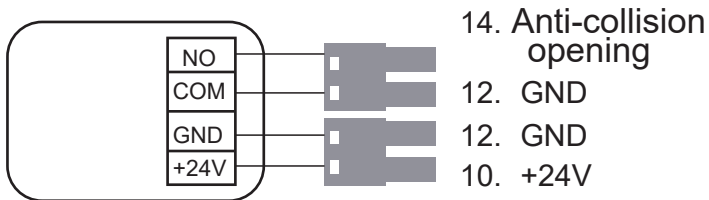

Anti-collision closing sensor

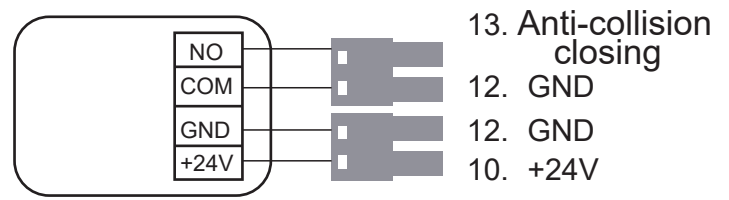

5. Data setting

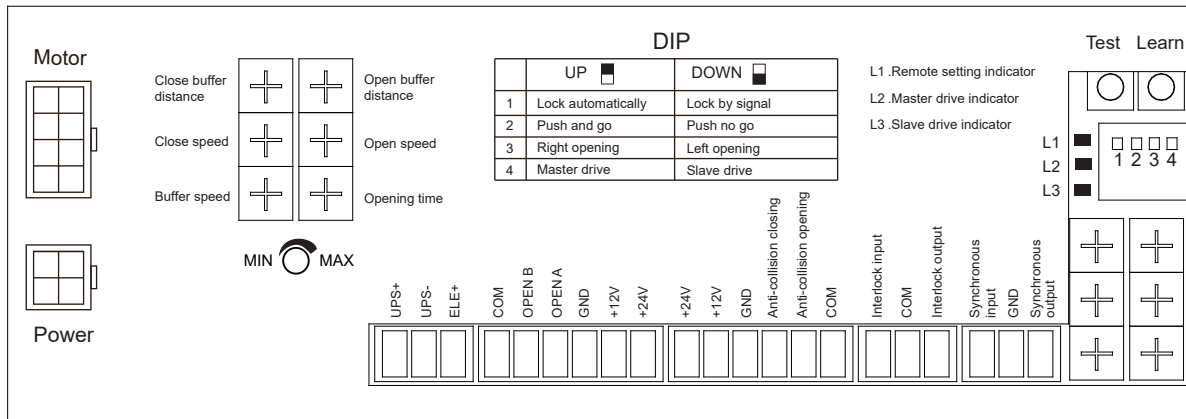

- Close buffer speed: Distance increase clockwise
- Open buffer speed: Distance increase clockwise
- Open speed: Open speed increase clockwise
- Close speed: Close speed increase clockwise
- Buffer speed : Buffer speed increase clockwise
- Open hold time: Hold time increase clockwise (0-20s adjustable)

DIP switch: The selection of dip only make sense after restart system

- 1.E-LOCK:UP-Lock automatically Down-Lock by signal
- 2.Push and go : UP: Active Down: Disable
- 3.L/R switch: UP-right open Down-left open (Power on, in the default mode door move to the close direction is correct, Please change the position of Dip switch if door in open direction)
- 4.Master and slave : UP-Master drive , Down-Slave drive

Button on the controller

- Test: Test button, Press to active one open-close round
- Learn : Remote setting button

LED Indicator

- L1: Indicator of remote setting (Blue)
- L2: Master drive indicator, Led flash 1 time in 4second (Red)
- L3: Slave drive indicator, Led flash 1time in 4 second (Green)

6.Function of remote

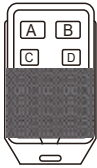

FC04: A Always open B Automatic C:Open one time D Full lock

Add the remote: Keep press the learning button on controller, L1 Blue Led is on , release learn button and press A on remote , Blue led flash 3 times , remote is added

Delet remote: Keep press the learning button 9 second , L1 turn from blue to flash , all the remote is delet (attention: while the process of delet, learning button should keep press)

Wireless push button : Added and deleted wireless push button is same as remote. Please check the DIP switch if it's same as the image shown (during setting process)



Notes

1. Receiver has been built-in only need remote to approve the always open , automatic, open one time , full lock function, and also fit with wireless push button PB04 to open the door , When controller is full lock , PB04 still can active the door
2. Exit only function:Connect outside sensor or button to terminal"Open-B", connect inside sensor or button to terminal "Open-A".Then press "full lock" button on remote
- 3.In double open mode: connect Synchronous line refer to the manual .power on ,make sure the setting is same If open and close speed is not same,please adjust open /close speed, open/close buffer speed,open hold time.
- 4.When double open, the transmitter should learn both operators together.
- 5.In double open mode, accessories should connect to both controller (parallel connection)

7.LED instructions

Double open		
	Master drive	Slave drive
Normal working	Red Led flash every 4seconds, Meanwhile Green led off	Green Led flash every 4seconds, Meanwhile Red led off
Learning mode	Red Led on 2seconds, Off 2seconds within 4 seconds, Meanwhile Green Led off	Green Led on 2seconds, Off 2 seconds within 4 seconds, Meanwhile Red led off
Set both operator as main drive or slave drive	Buzzer not bip , Red and green led flash 2times within 4seconds	
Not connect synchronous line or wrong connect	Buzzer not bip, Red and green led flash 3times within 4seconds	

Single open	
Normal working	Red and green LED alternately brighten,Red led light up while green off 1second, then Green led light up while red off 1seconds
Learning mode:	Red and green LED alternately brighten,Red led light up while green off 2second, then Green led light up while red off 2seconds

Overcurrent protection Buzzer bip each 1 second, Red led and green led flash 4 times together within 4seconds

Motor problem Buzzer bip each 2 seconds, Red led and green led flash 5 times together within 4seconds